

COUNTY CONSTRUCTION - Anticipated completion date
1 JULY 1968

NOTE
ALL ELEVATIONS ARE TO FINISH GRADE (A.C.)
SUBTRACT 0.12' FOR TOP OF CONCRETE.

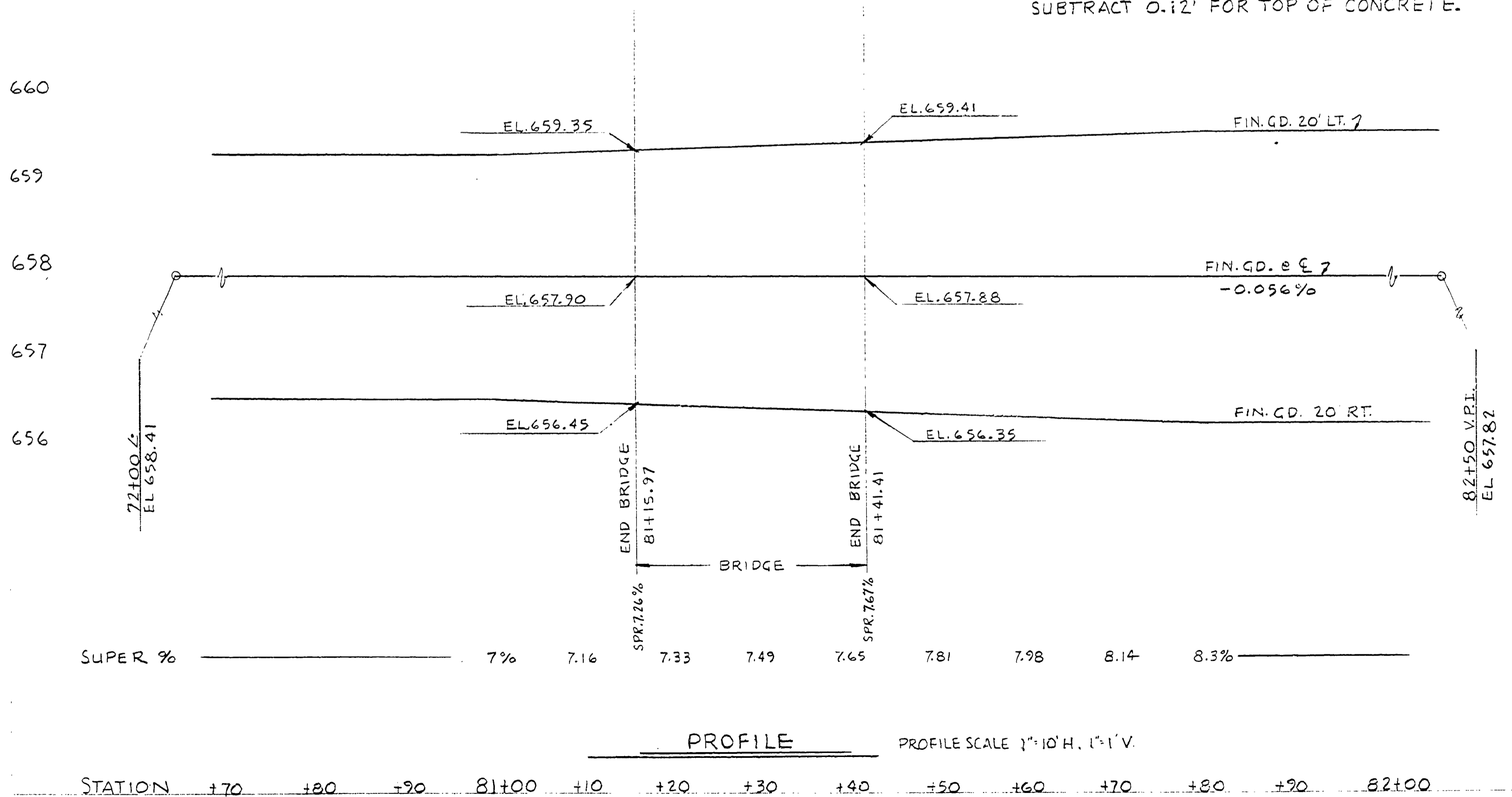

Revised 5-14-68 Bawne

DOUGLAS COUNTY ROAD DEPT.
BILGER CREEK BRIDGE

"URBAN" SECTION
NORTH MYRTLE ROAD #15
MAY 1968

BILGBRDG

Rd # 15 MAY 1968 (28)