

SEC. 22, 23, 27 & 28, T. 28 S., R. 4 W. N.M.

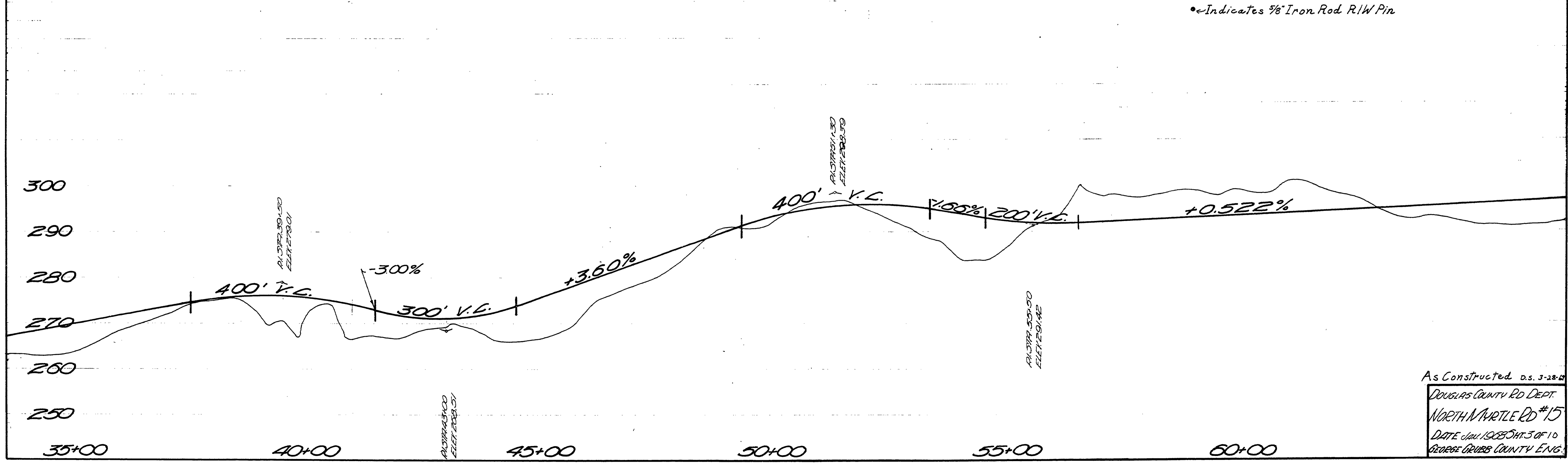
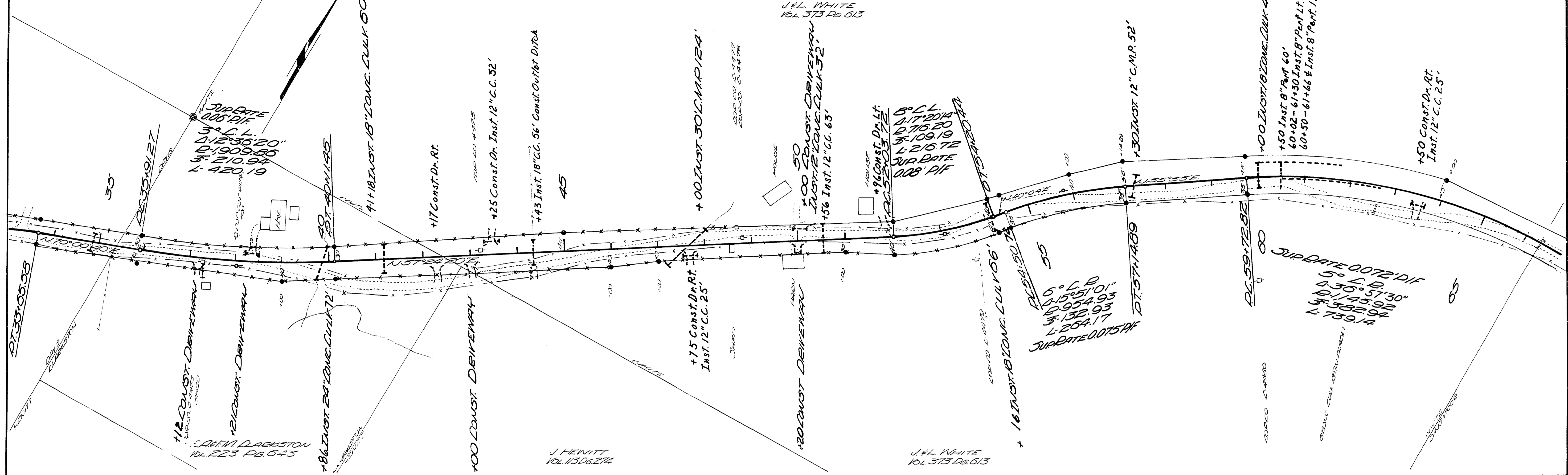

As Constructed, d.s. 3-28-68
 DOUGLAS COUNTY RD DEPT.
 NORTHVALE RD #15
 DATE JAN 1968 SH. 3 OF 10
 GEORGE CRIBBS COUNTY ENG.

M.P. 10.27-10.24

JAN 1, 1968
 Rd # 15

10271084

(47)