

NOTE BOOK ATTACHMENT CHECKED BY RT. BY WAY CHECKED NO.

NOTE BOOK CHECKED BY W.M. NOTED BY STRUCTURE NOTES CHFD. NO.

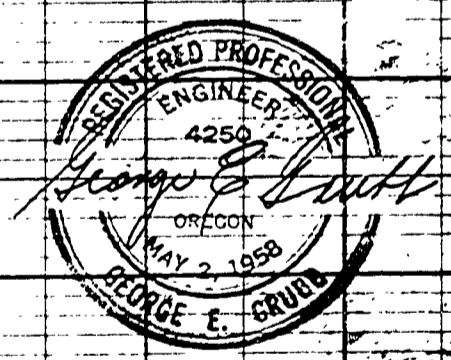
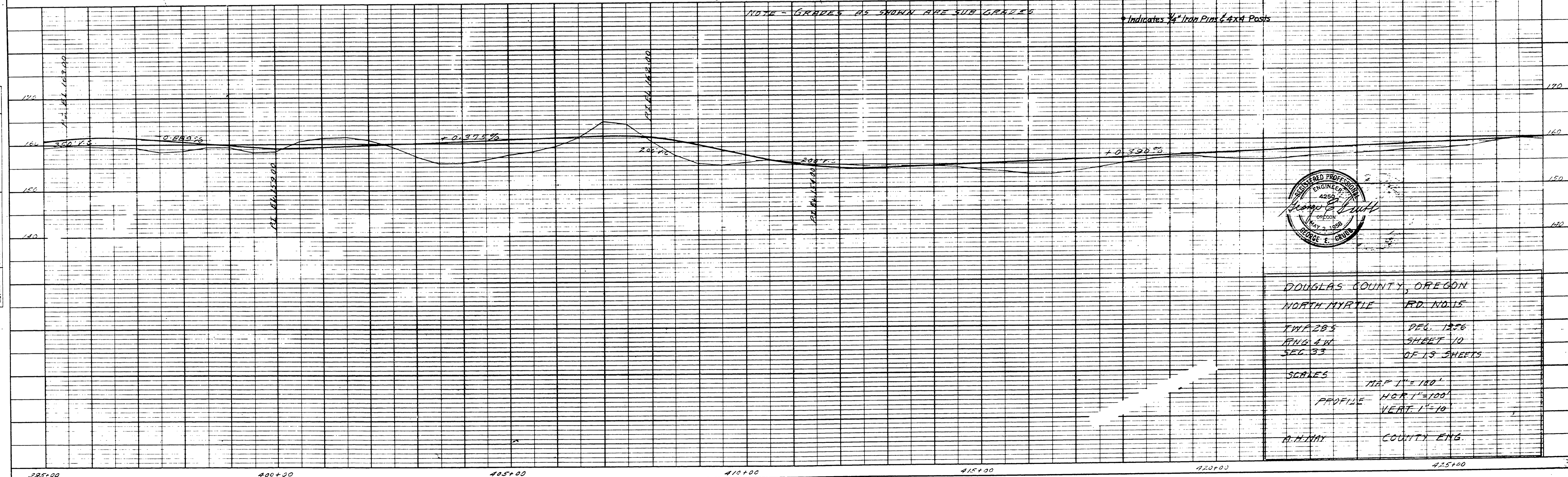

DOUGLAS COUNTY, OREGON
 NORTH MYRTLE RD. NO. 15
 TWP 28S
 RANG 4W
 SEC 33
 SCALES
 PROFILE
 H.M.HAY COUNTY ENG.

PEL. 1256
 SHEET 10
 OF 13 SHEETS
 MAP 1" = 100'
 HOR. 1" = 100'
 VERT. 1" = 10'

PLATE 1-PLAN-PROFILE D.P.S. & R.E. STANDARD 100% H&B PAPER-MADE AND PRINTED IN U.S.A. EUGENE DIETZGEN CO.

M.P. 7.73 - 8.29

REC 956 Rd #15 sheet 10 of 13 sheets

7750829

39