

ALIGNMENT, PROFILE and GRADE LINE OF WAGON ROAD CHANGE IN A. CALLAHAN'S DISTRICT

0100 from loc. sec. 9 and 16
T27S, R6W

Return 12 7/2 ft East of 1/2 cen
Alignment Note

Sta	Sec
0100 to 3750	N 5° 40' E
3750 - 7150	N 1° 30' E
7150 - 8150	N 3° 50' E
8150 - 10150	N 0° 40' E
10150 - 13100	N 15° 50' E
13100 - 16100	N 5° 15' E
16100 - 18100	N 12° 03' E
18100 - 23135	N 6° 00' W
23135 - 31135	N 22° 58' W
31135 - 37185	N 34° 02' W
37185 - 39150	N 45° 32' W
39150 - 41130	N 57° 05' W
41130 - 43130	N 20° 25' W

Addenda

Sta	18100	thru	to	Re	10 ft
-	18150	-	-	-	8
-	19100	-	-	-	4
-	20100	-	-	-	4
-	21150	-	-	-	4
-	23100	-	-	-	2
-	25135	-	-	-	5
-	30135	-	-	-	5
-	30185	-	-	-	6
-	34185	-	-	-	3
-	35135	-	-	-	6
-	35185	-	-	-	6
-	36135	-	-	-	4
-	36185	-	-	-	4
-	37135	-	-	-	4
-	38185	-	-	-	4
-	39150	-	-	-	5

Horizontal Scale of Alignment - 1" = 100 ft
Horizontal Scale of Profile - 50 ft = 1" inch
Vert. Scale of Profile - 1" = 10 ft
Cubic Yds in Cuts - 1.700
Slope of Banks - 1 to 1
Length of Change - 4330 ft

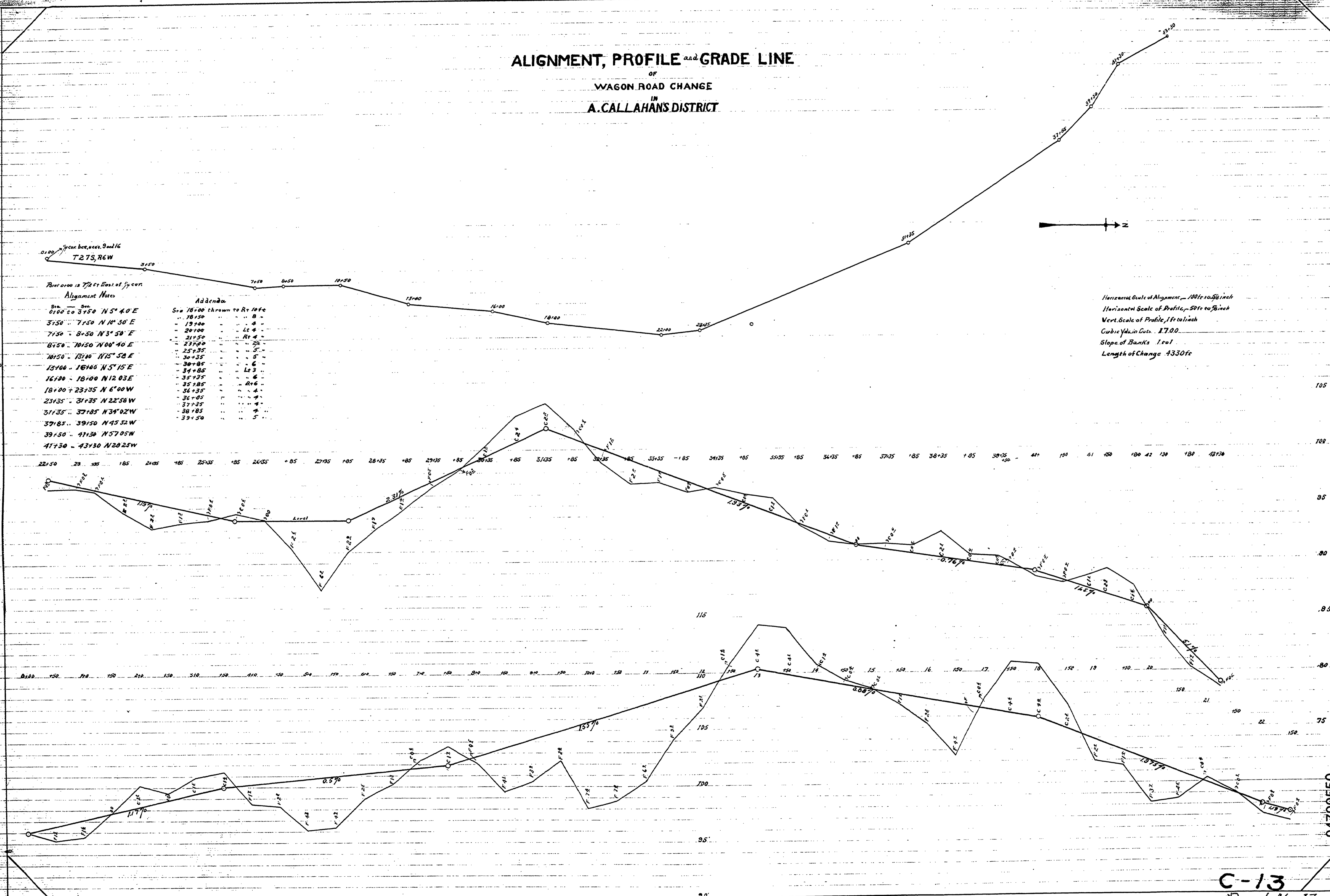

C-13
Road No 13

N.M.P. 27 - 5.5

T27-6 S. 4 NO DATE SHEET 109

Prepared PROFILE PAPER

Prepared PROFILE PAPER

04700550