

* NOTE:
STA. 175+00 to 191+00
SEE NOTE BELOW
FOR R/W

• INDICATES 3/8" I. ROD SET

-0.784%
* STA. 175+00 to 191+00 R/W
NO NEW R/W ACQUIRED IN 1971
OLD R/W IS 30' EACH SIDE OF OLD ROAD &
(Ct. JOURNAL VOL. 1 P. 42 & 43)
R/W FROM NEW &

R/W LT.	STA.	R/W RT.
30.00	175	30.00
28.07	174	31.93
27.80	177	32.20
28.70	178	31.30
30.00	179	30.00
31.00	180	29.00
31.90	181	28.10
32.28	182	27.72
32.76	183	27.24
32.68	184	27.32
31.68	185	28.32
30.58	186	29.42
28.54	187	31.46
27.86	188	32.14
27.61	189	32.39
27.87	190	32.13
27.82	191	32.18

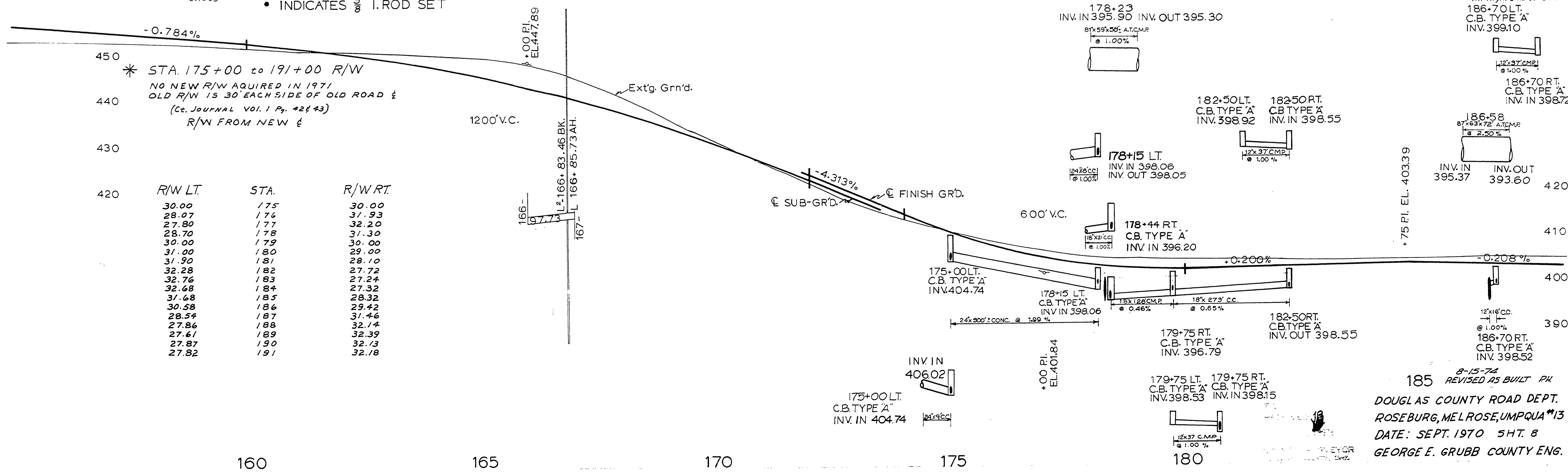

8-15-74
REVISED AS BUILT PH
DOUGLAS COUNTY ROAD DEPT.
ROSEBURG, MELROSE, UMPQUA #13
DATE: SEPT. 1970 5HT. 8
GEORGE E. GRUBB COUNTY ENG.

07030764