

# DOUGLAS COUNTY HIGHWAY SURVEY

PROFILE 3rd ALIGNMENT  
BECKLEY ROAD

PETITION OF MACK SMITH et al  
IN

SECTIONS 35-36-31-30-19-29 Twp 22 SR 87 W.W.M.  
STA 106+34.2 TO STA 202+31.2  
214+44.2

OFFICE OF  
**F. C. FREAR**  
COUNTY SURVEYOR & ROADMASTER  
JUNE 1921  
Sheet No. 2

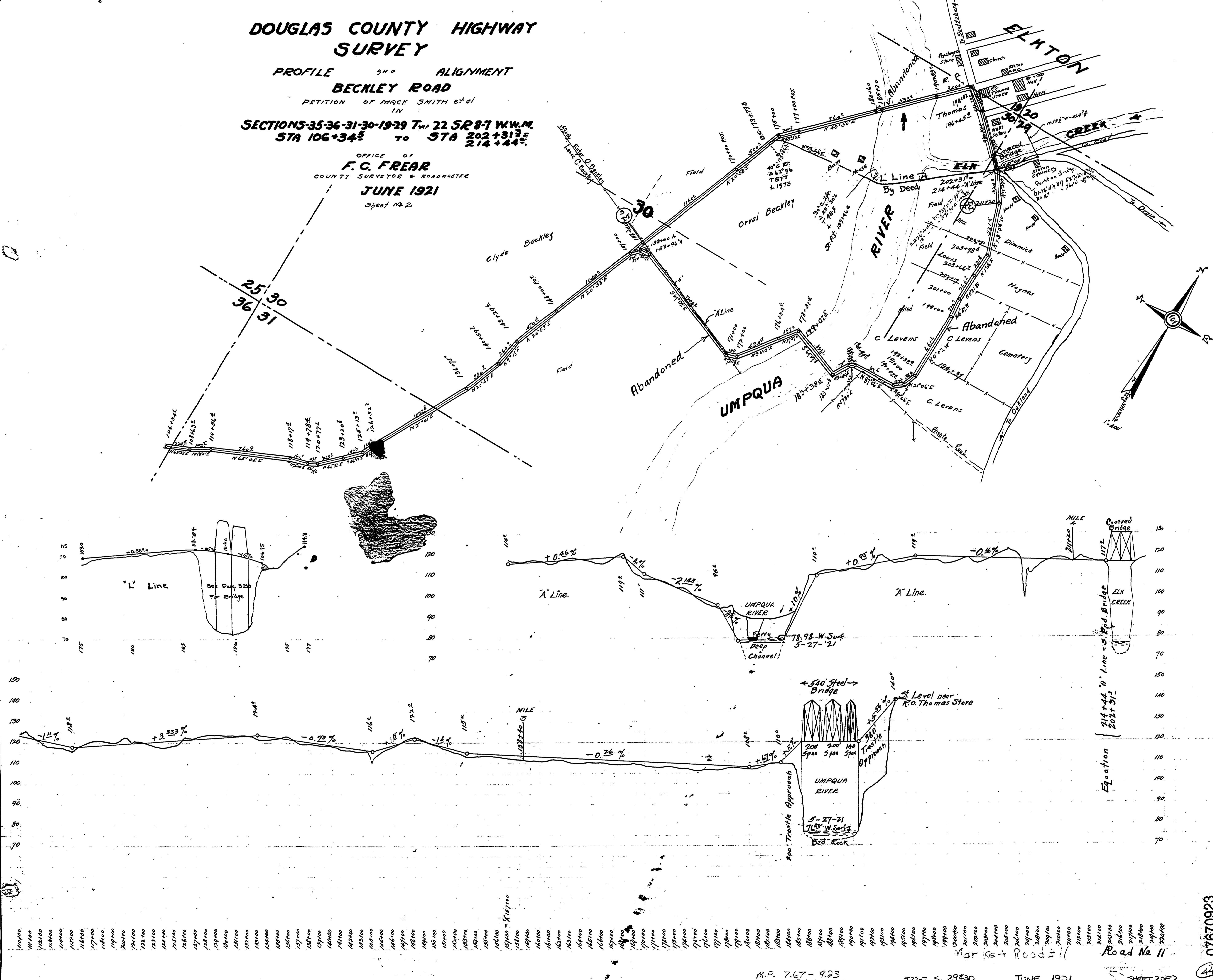

106+00 107+00 108+00 109+00 110+00 111+00 112+00 113+00 114+00 115+00 116+00 117+00 118+00 119+00 120+00 121+00 122+00 123+00 124+00 125+00 126+00 127+00 128+00 129+00 130+00 131+00 132+00 133+00 134+00 135+00 136+00 137+00 138+00 139+00 140+00 141+00 142+00 143+00 144+00 145+00 146+00 147+00 148+00 149+00 150+00 151+00 152+00 153+00 154+00 155+00 156+00 157+00 158+00 159+00 160+00 161+00 162+00 163+00 164+00 165+00 166+00 167+00 168+00 169+00 170+00 171+00 172+00 173+00 174+00 175+00 176+00 177+00 178+00 179+00 180+00 181+00 182+00 183+00 184+00 185+00 186+00 187+00 188+00 189+00 190+00 191+00 192+00 193+00 194+00 195+00 196+00 197+00 198+00 199+00 200+00 201+00 202+00 203+00 204+00 205+00 206+00 207+00 208+00 209+00 210+00 211+00 212+00 213+00 214+00 215+00 216+00 217+00 218+00 219+00 220+00 221+00 222+00 223+00 224+00 225+00 226+00 227+00 228+00 229+00 230+00 231+00 232+00 233+00 234+00 235+00 236+00 237+00 238+00 239+00 240+00 241+00 242+00 243+00 244+00 245+00 246+00 247+00 248+00 249+00 250+00 251+00 252+00 253+00 254+00 255+00 256+00 257+00 258+00 259+00 260+00 261+00 262+00 263+00 264+00 265+00 266+00 267+00 268+00 269+00 270+00 271+00 272+00 273+00 274+00 275+00 276+00 277+00 278+00 279+00 280+00 281+00 282+00 283+00 284+00 285+00 286+00 287+00 288+00 289+00 290+00 291+00 292+00 293+00 294+00 295+00 296+00 297+00 298+00 299+00 300+00

M.P. 7.67 - 9.23  
JUNE 1921  
SHEET 2 OF 2

07670923

44