

BRIDGE PROJECT

OREGON STATE HIGHWAY DEPARTMENT (7355) 1070 ELEVATION 113.5
 LOCATION: NORTHWEST COR. OF THE MARY BECKLEY STEEL BRIDGE, ABOUT 0.2 MILES
 SOUTHWEST OF ELKTON. BRASS CAP FOUND IN THE TOP OF THE NORTHWEST END OF THE
 NORTHWEST PIER.

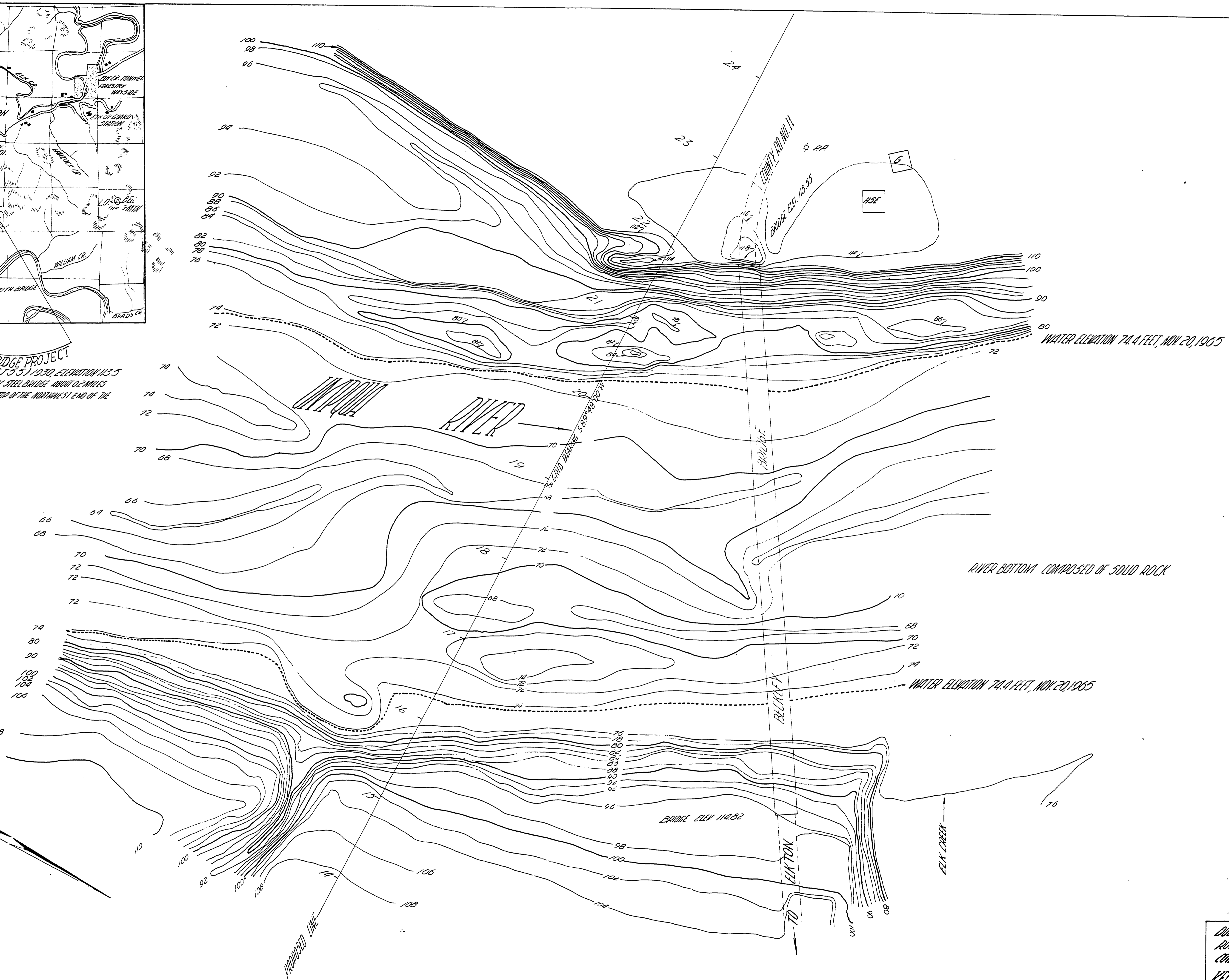

RIVER BOTTOM COMPOSED OF SOLID ROCK

DOUGLAS COUNTY ROAD DEPT.
 ROSEBURG, OREGON. SCALE 1" = 50'
 CONTOUR INTERVAL 2 FEET
 KELLOGG-ELKTON BRIDGE SITE
 ALLIANT COUNTY ENG.

BRIDGE 00

11 # 12

126

