

**DOUGLAS COUNTY HIGHWAY
IMPROVEMENT
PROFILE AND ALIGNMENT
ROCHESTER BRIDGE-ELKTON
HAINES SECTION
SHEET NO 1
SECTIONS 29 & 32, T22S, R. 7W, W.M.
STA. 0+00 TO STA. 30+10.4**

OFFICE OF
F. C. FREAR
COUNTY ROADMASTER
MAY 1923

SCALE: HOR. 1 in. = 100 ft. VER. 1 in. = 10 ft.

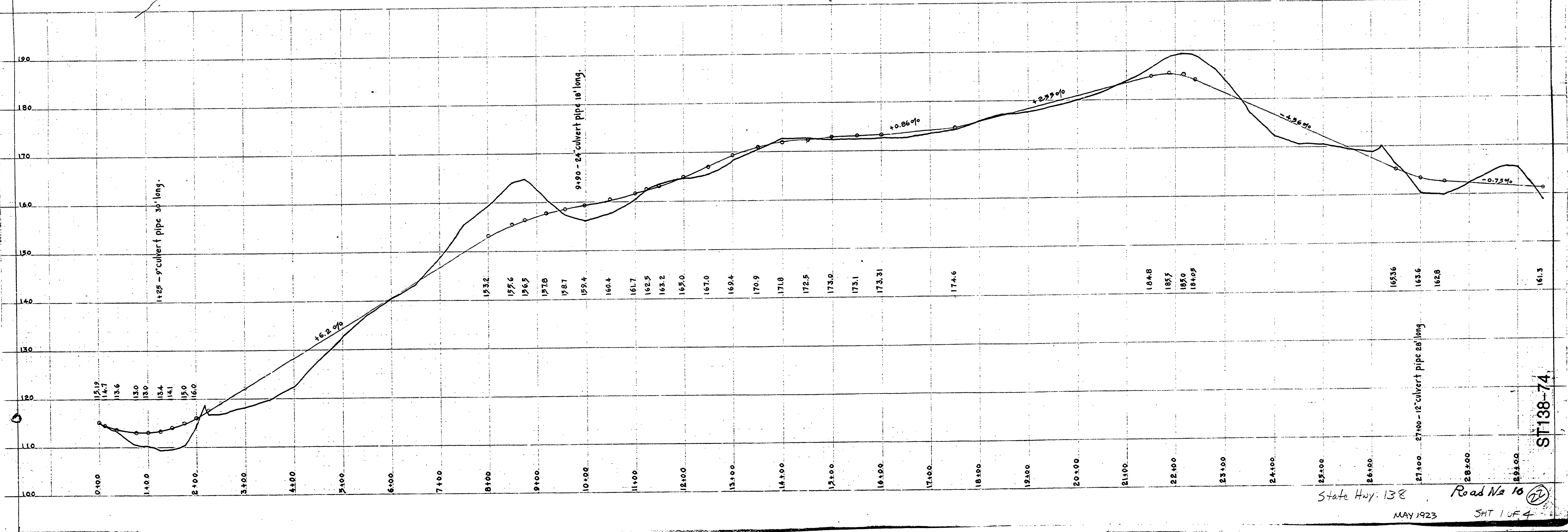

ST 138-74