

G.U. Helbig to Douglas County  
 Consideration \$100 & 2 lines fence  
 40' Right of way Sta. 34+38 to Sta. 72+85.1  
 Road Record 8 Page 399  
 July 28, 1922

W.C. & Lulu B. Thorp  
 W.E. DODGE

**DOUGLAS COUNTY HIGHWAY  
 IMPROVEMENT  
 PROFILE AND ALIGNMENT  
 YONCALLA - ELKHEAD ROAD  
 PARKS HILL SECTION  
 SHEET No 2  
 SECTIONS 33 & 34, TWP 22S., RANGE 4 W.W.M.  
 STA. 0+00 TO STA. 112+00  
 OFFICE OF  
 F.C. FREAR  
 COUNTY ROADMASTER  
 SEPTEMBER 1922  
 SCALE 1 inch = 100 feet  
 ROAD 8**

W.E. Dodge to Douglas County  
 Consideration \$150 & 40' Right of way  
 Sta. 34+38.2 to Sta. 0+00  
 Oct. 10, 1922  
 40 Road Record 8 Page 401

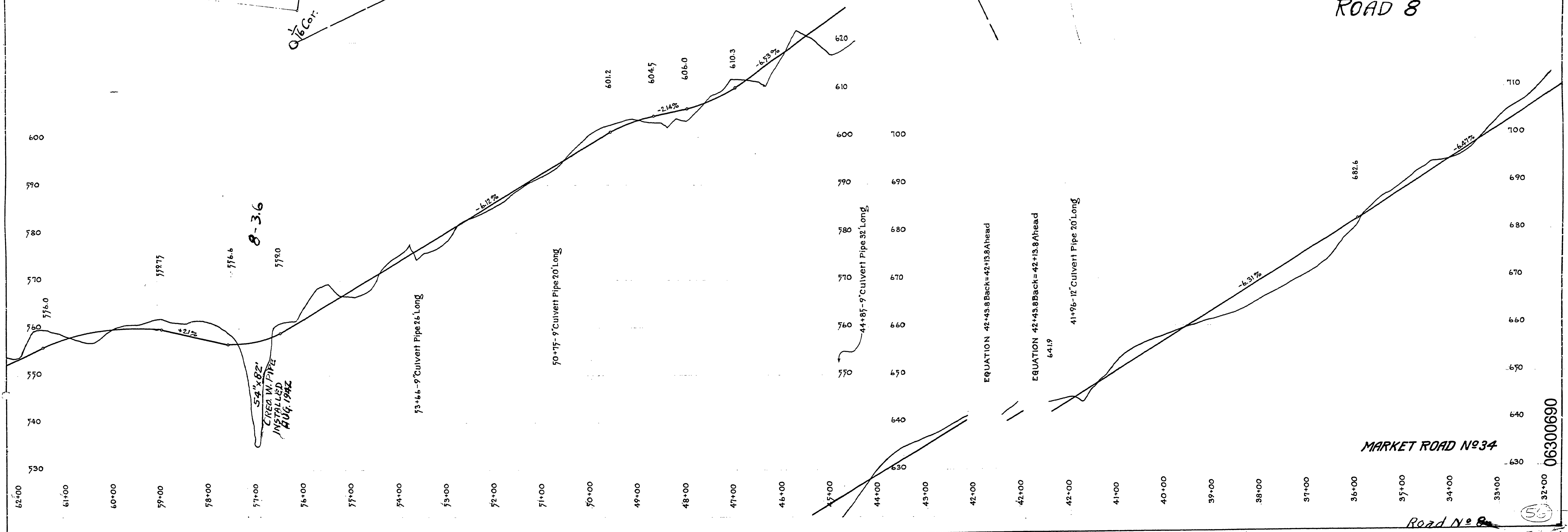

MARKET ROAD No 34  
 Road No 8  
 06300690