

**DOUGLAS COUNTY HIGHWAY
IMPROVEMENT
PROFILE AND ALIGNMENT
YONCALLA-ELKHEAD ROAD
PAYNE SECTION
SHEET NO 2**
SECTIONS 16 & 21, TWP. 23 S, RANGE 4 W.W.M.
STA. 95+03.0 TO STA. 188+36.5
OFFICE OF
F. C. FREAR
COUNTY ROADMASTER
OCTOBER 1922
SCALE 1 in = 100 Ft.

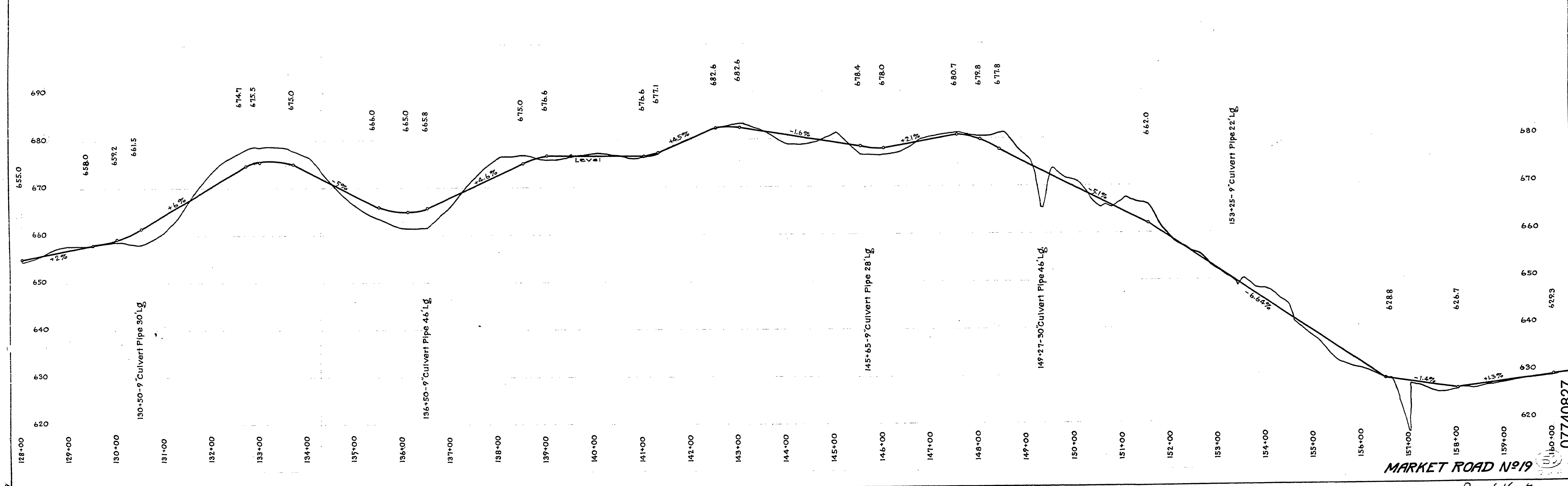

MARKET ROAD No 19

Road No 7

07749827

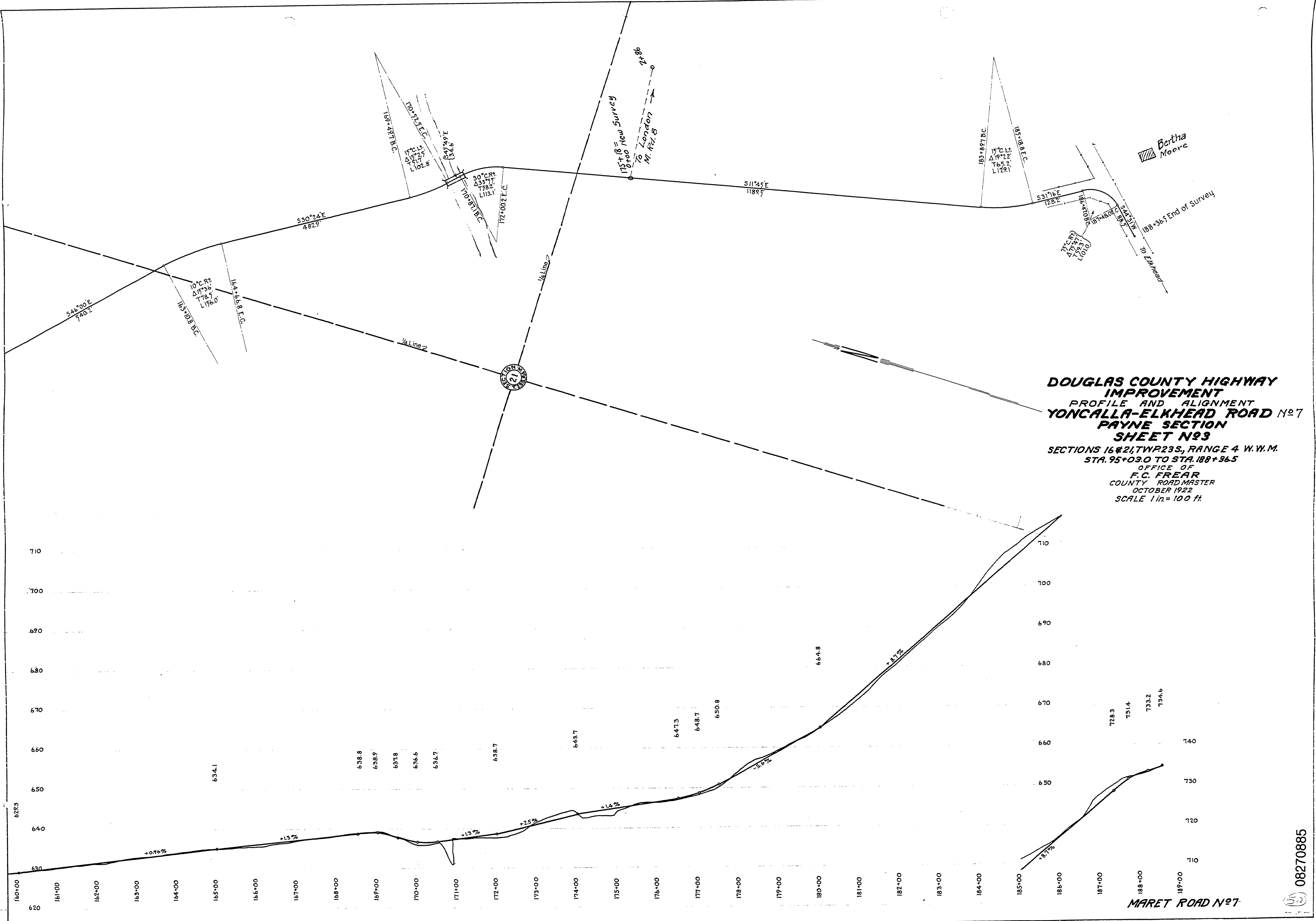

DOUGLAS COUNTY HIGHWAY IMPROVEMENT
PROFILE AND ALIGNMENT
YONCALLA-ELKHEAD ROAD No. 7
PAYNE SECTION
SHEET No. 3
 SECTIONS 16E21, TWP 23S, RANGE 4 W.W.M.
 STA. 95+03.0 TO STA. 188+36.5
 OFFICE OF
F.C. FREAR
 COUNTY ROAD MASTER
 OCTOBER 1922
 SCALE 1 in. = 100 ft.

MARET ROAD No. 7

08270885

W.P. 8-27-22

Road No. 7

