

● Indicates 3/4" Iron Pins & 4x4 Posts.

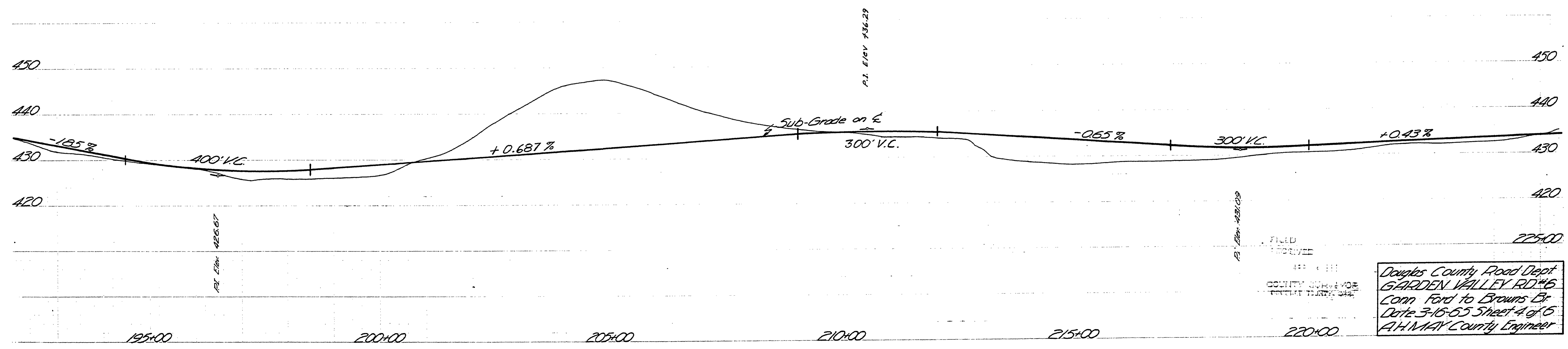

Douglas County Road Dept.
 GARDEN VALLEY RD. #16
 Conn Ford to Browns Br.
 Date 3-16-65 Sheet 4 of 6
 A.H. MAY County Engineer

03700427

M.P. 3.70 - 4.27

Rd # 6 3-16-65