

DOUGLAS COUNTY OREGON
AS CONSTRUCTED
GRADING & SURFACING
GARDEN VALLEY ROAD NO. 6
CONN FORD - BROWNS BRIDGE
F.A.S. 800

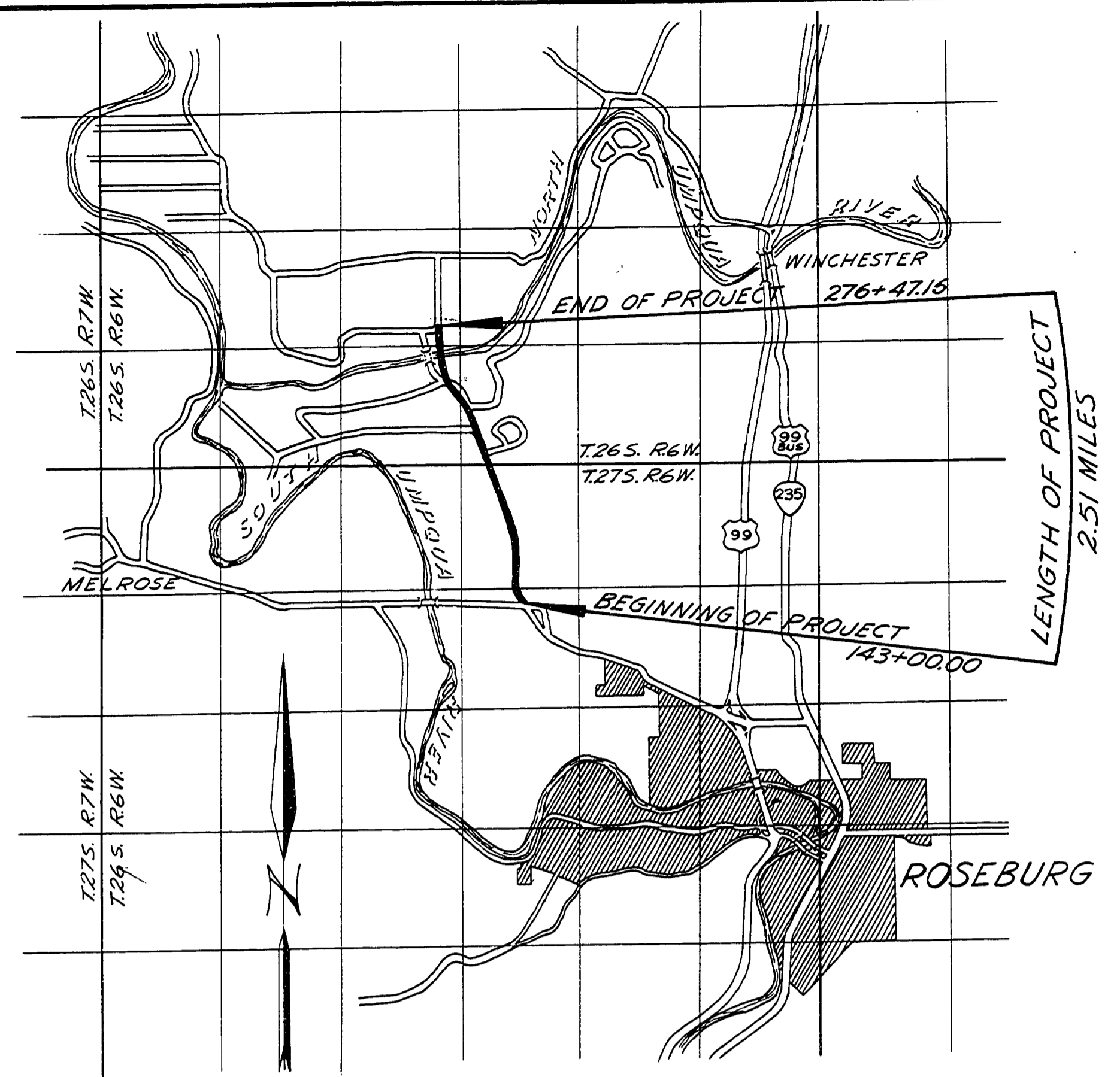

VICINITY MAP

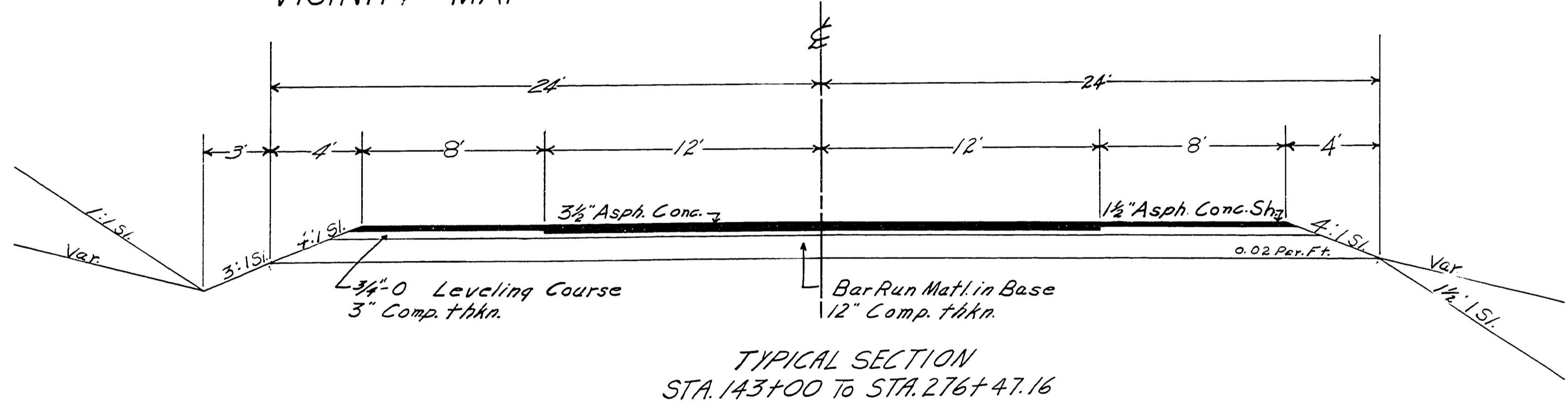

R. H. Key

3-16-65

Rd. # 6 3-16-65 5:10 G

0271052C

60