

T.27S.R.6 W.W.M. Sec 13

FILED RECEIVED DEC 22 1963 COUNTY SURVEYOR DOUGLAS COUNTY, ORE.

EAST UNIT GARDEN VALLEY ROAD SEC. GARDEN VALLEY RD. DOUGLAS CO				SHEET NO. 4
FED. ROAD Div. No. 8	STATE OREGON	PROJECT NUMBER DUS-402 (1)	FISCAL YEAR	TOTAL SHEETS

4-60 5370

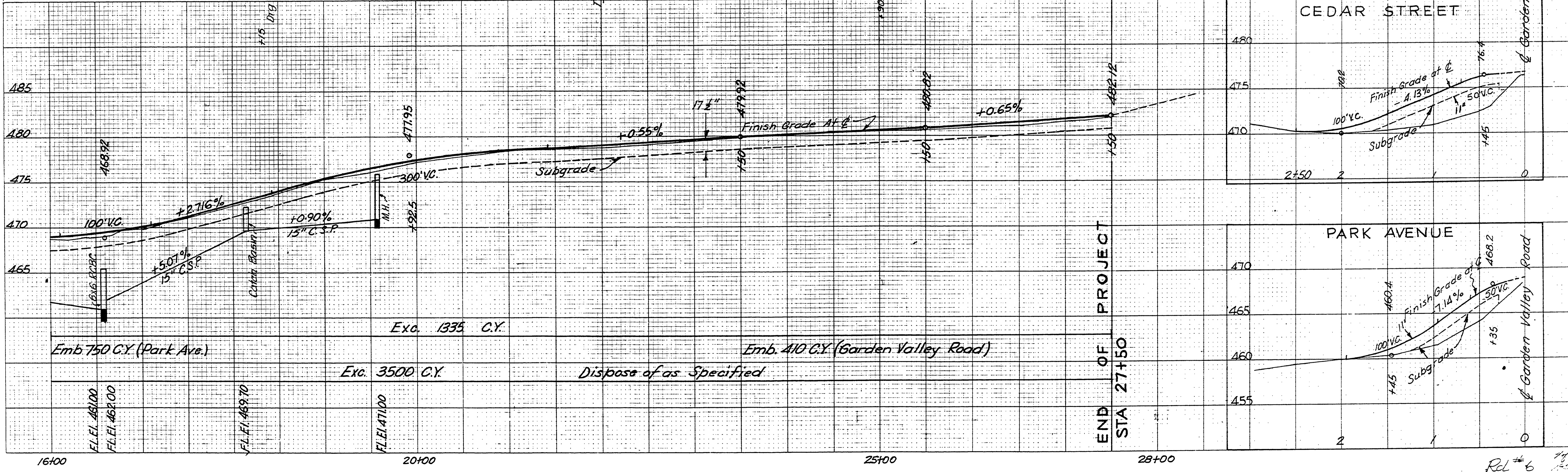
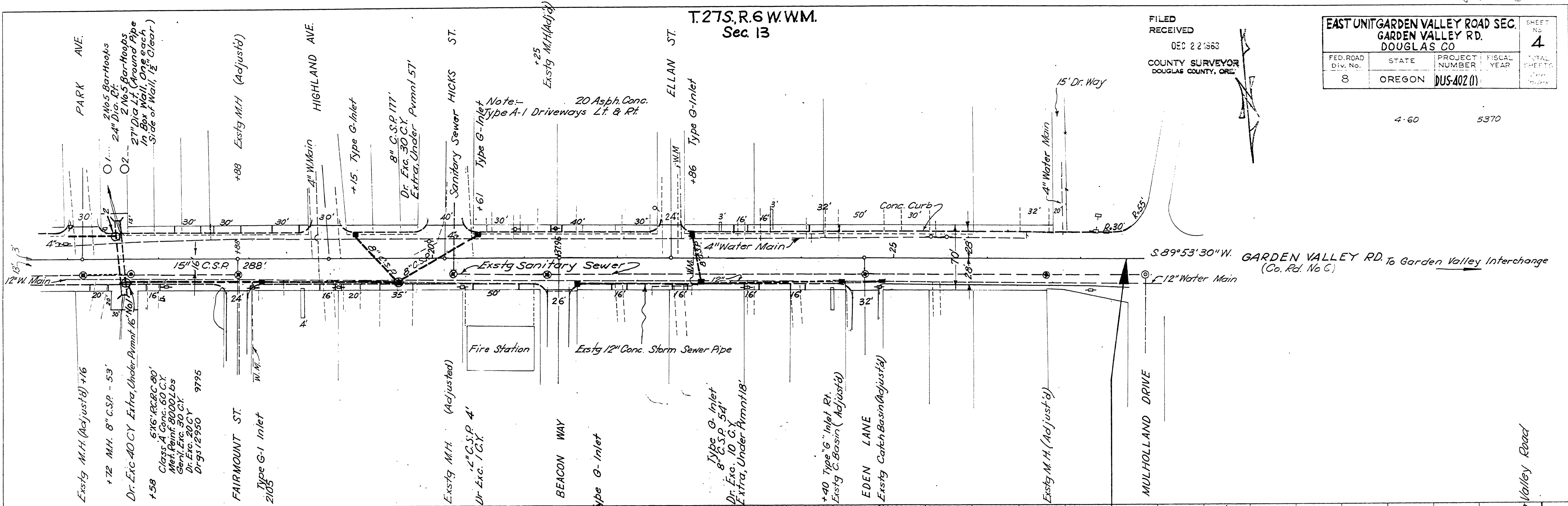

FINAL SURVEY NOTE BOOK NO.

ORIGINAL SURVEY NOTE BOOK NO.

00300052