

DOUGLAS COUNTY HIGHWAY IMPROVEMENT
 PROFILE AND ALIGNMENT
 TEN MILE - RESTON ROAD
 COATS SECTION
 SECTIONS 31 & 32, TWP. 28 S., RANGE 7 & 8 W.W.M.
 STA. 0+00 TO STA. 40+20.0
 OFFICE OF
 F. C. FREAR
 COUNTY SURVEYOR AND ROADMASTER
 NOVEMBER 1921
 SCALE: HORIZONTAL 1"=100' VERTICAL 1"=10'
ROSEBURG-RESTON M.R. No 5
COATS SECTION

W. H. Coates to Douglas County
 40' Right of way St. 0+00 to 34+17.6
 Consideration \$125
 Road Record 8 Page 396

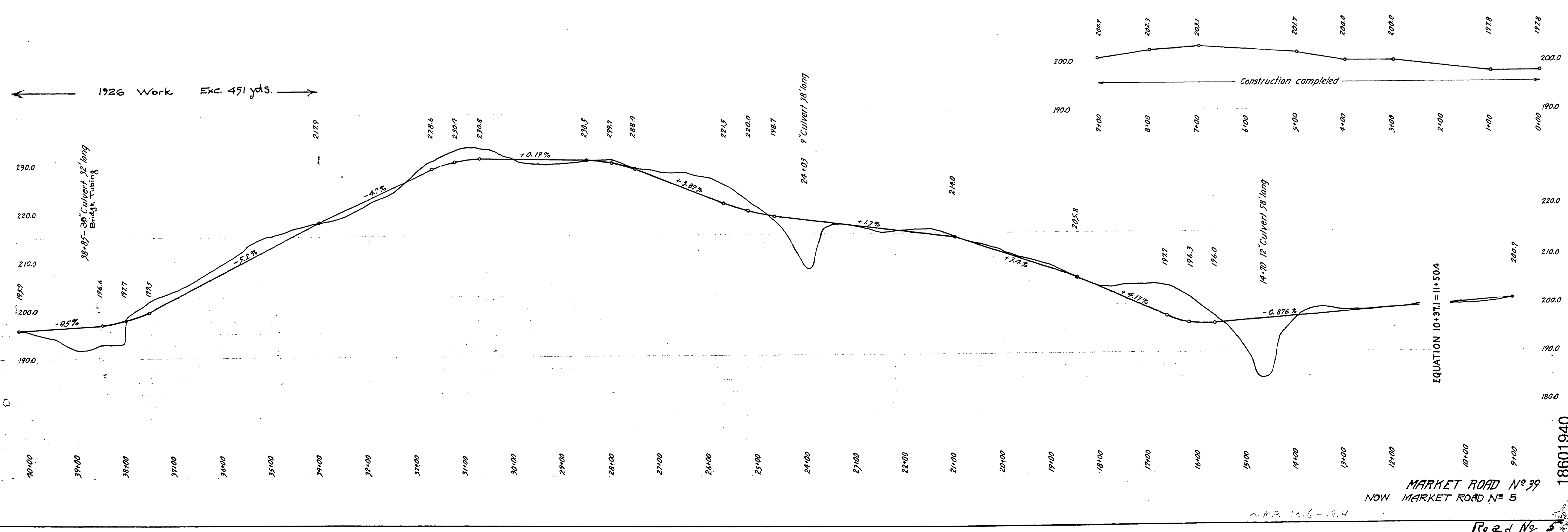

18601940

~ M.P. 12.6-13.4

Road No 5