

DOUGLAS COUNTY HIGHWAY IMPROVEMENT

PROFILE AND ALIGNMENT
 ROSEBURG-RESTON ROAD
 LOOKING GLASS HILL SECTION
 IN

SECTIONS 29-30 Twp. 27 SR 6 W.W.M.
 STA 9+50.2 TO STA 44+00.2

OFFICE OF
F. C. FREAR
 COUNTY SURVEYOR & ROADMASTER
 JUNE 1921

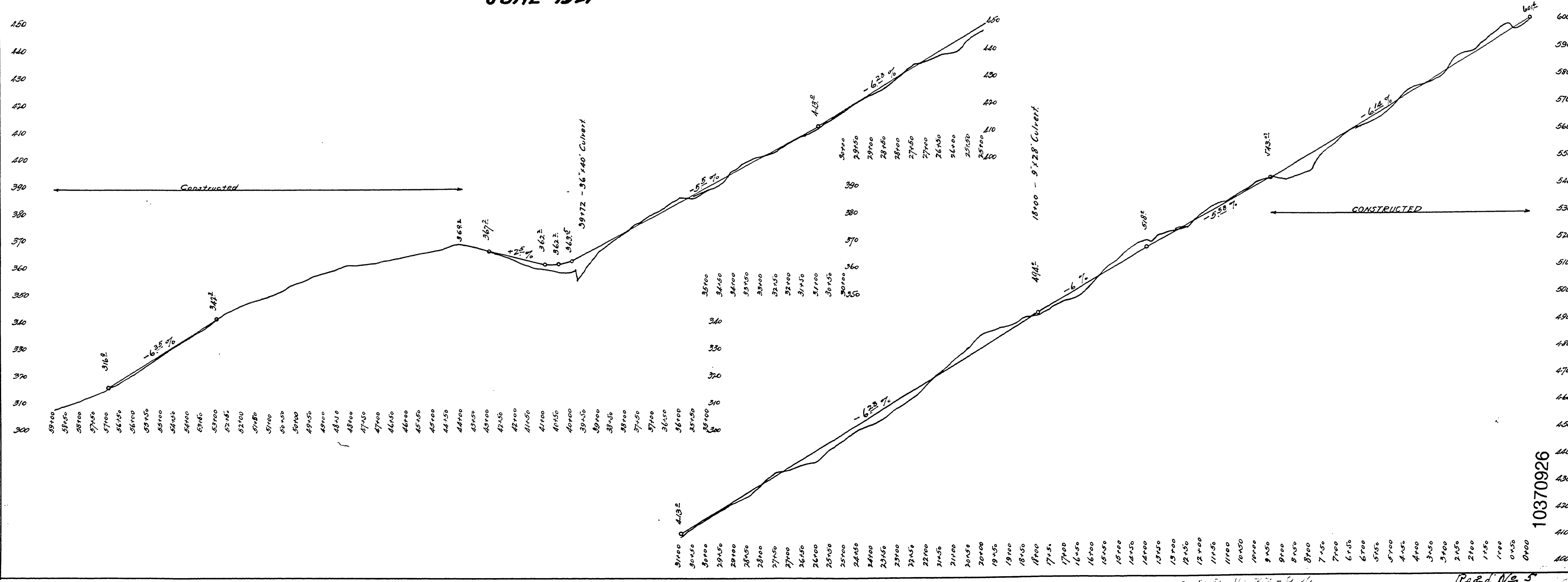

10370926