

ROSEBURG-DIXONVILLE SECTION				SHEET No.
NORTH UMPQUA ROAD				9
DOUGLAS COUNTY				
FED. ROAD Div. No.	STATE	PROJECT NUMBER	FISCAL YEAR	TOTAL SHEETS
8	OREGON	S-14(7)		See Index

T. 27 S. R. 5 W. W.M.

Sec. 16 Sec. 15

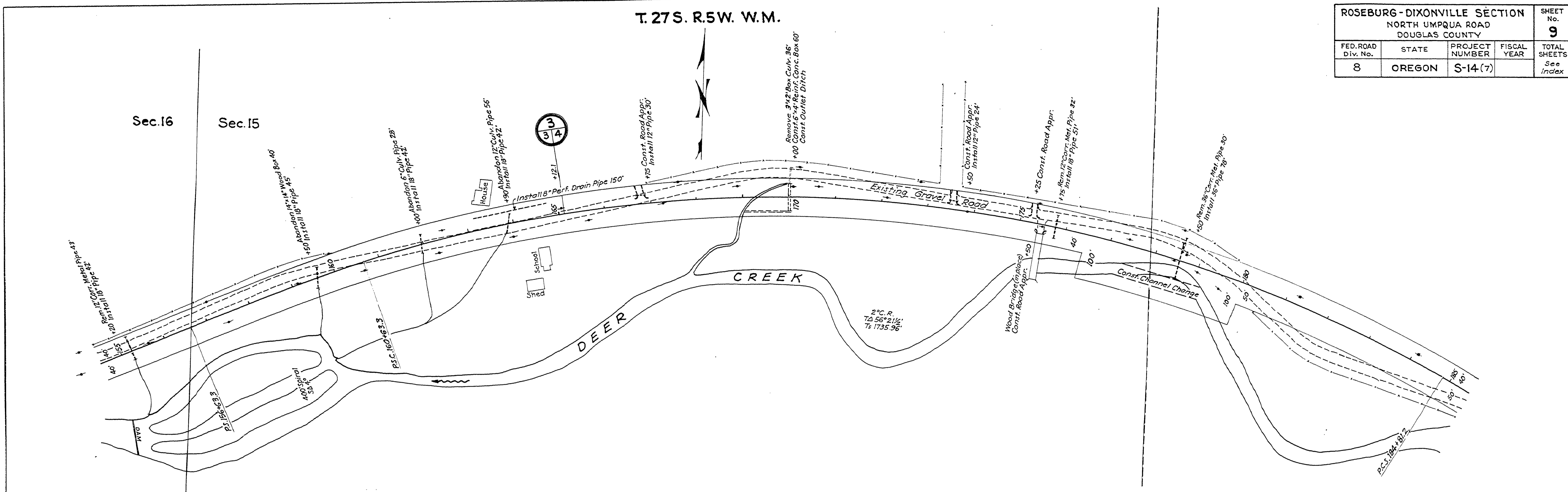

FINAL SURVEY	BY	DATE
SURVEYED		
PLOTTED		
AREA		
NO. AREAS CHECKED		

ORIGINAL SURVEY	BY	DATE
SURVEYED		
PLOTTED		
AREA		
NO. AREAS CHECKED		

