

**DOUGLAS COUNTY
HIGHWAY IMPROVEMENT**
PROFILE AND ALIGNMENT
ROSEBURG - DIXONVILLE ROAD
BROOKSIDE SECTION
MARKET ROAD NO. 4
SEC. 19-20 T21S R5W. W.M.

OFFICE OF
P.C. FREAR COUNTY ADMSTR
JUNE 20 1925

HOR SCALE 1" = 100'
VER SCALE 1" = 10'

SHEET NO. 2

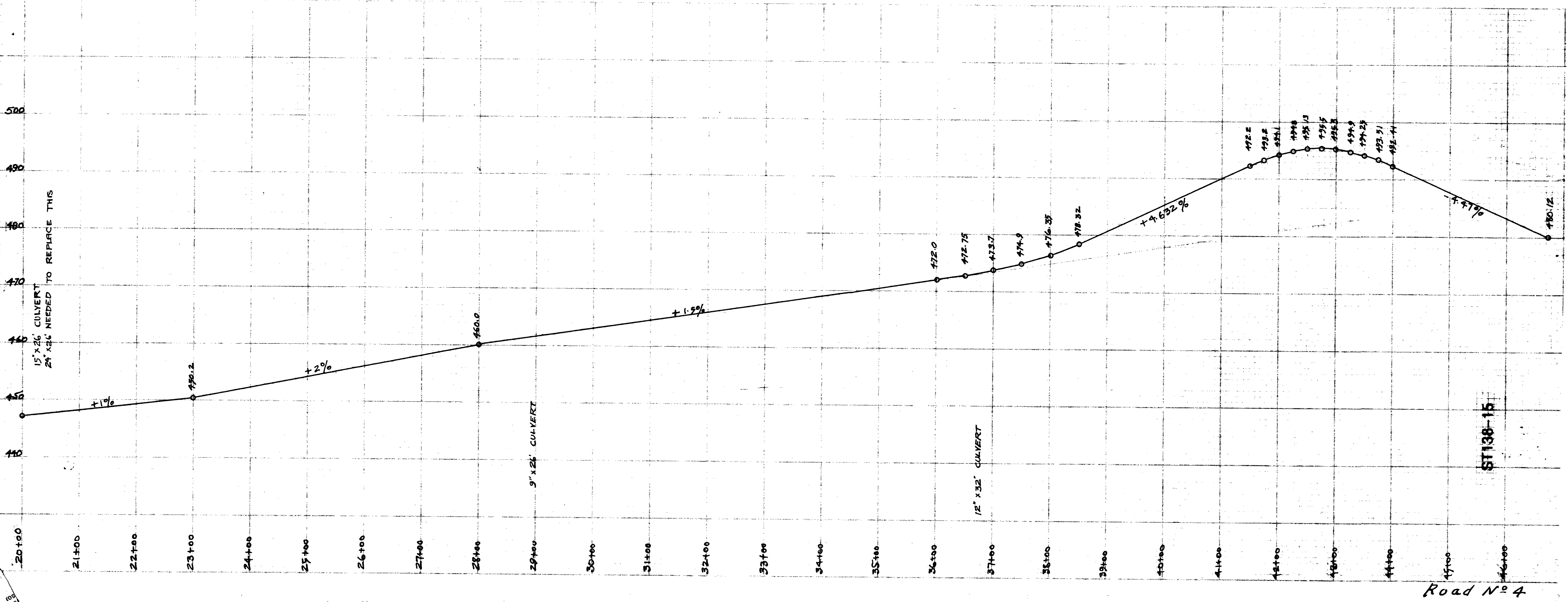

State Hwy. #138
JUNE 20, 1925

sh. 2 of 4