

PROFIT
DATE
BY

As Constructed 4-21-70 o.s.
DOUGLAS COUNTY RD. DPT.
DIAMOND LAKE BLVD.
STORM SEWER PLANS
 DATE- JUNE 1968 SHT. 2 OF 3
 George E. Grubb County Eng.

00710122

M.P. 0.71 - 1.32

Rd. # 1

JUNE 1968 SHT. 2 OF 3

25

SEC. 20 T275 R5W W.M.

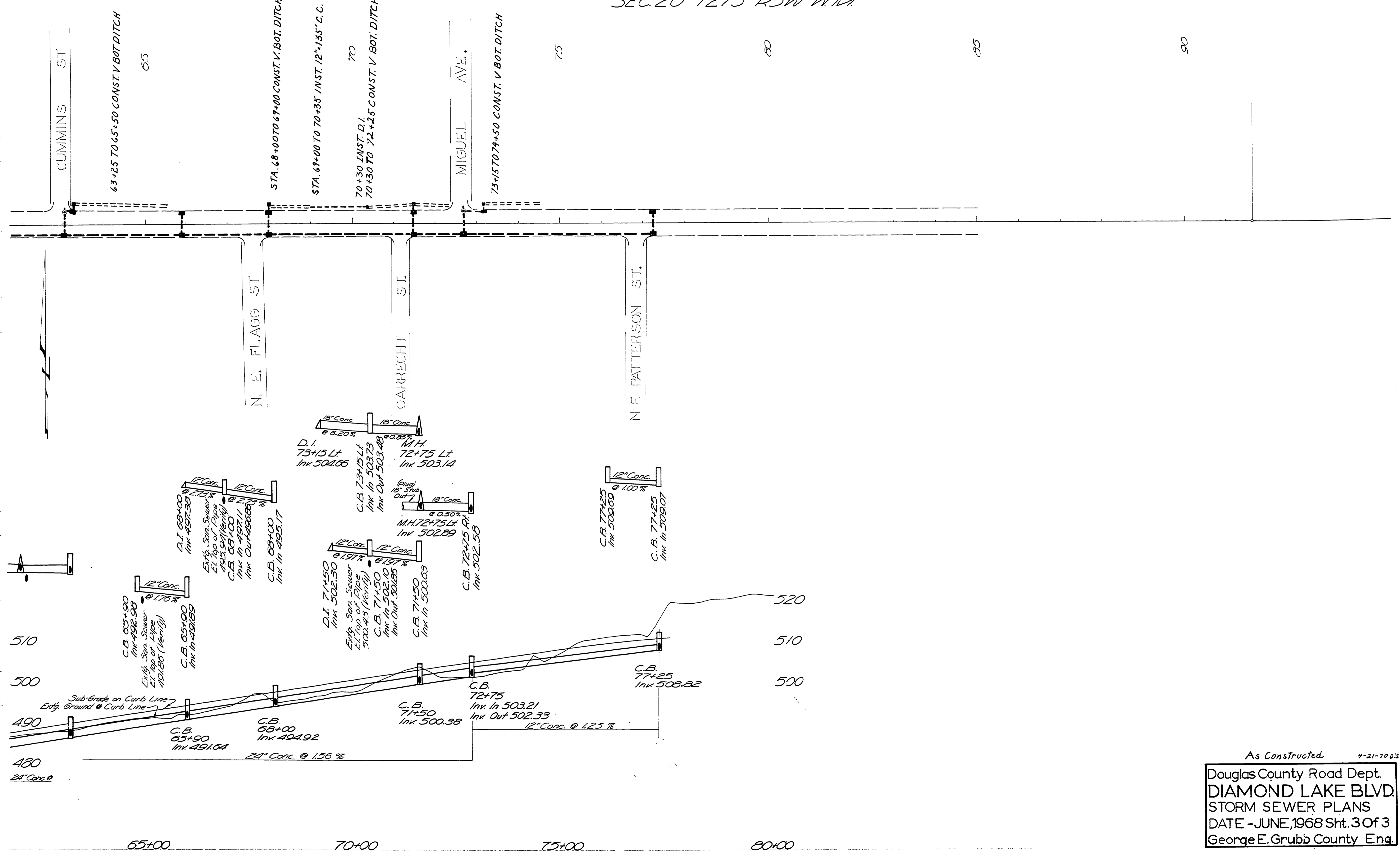

PLAN
PROFILE

As Constructed 4-21-700.S.
 Douglas County Road Dept.
DIAMOND LAKE BLVD.
 STORM SEWER PLANS
 DATE - JUNE, 1968 Sht. 3 of 3
 George E. Grubb County Eng.

01220147

M.P. 1.22 - 1.47

Rd # 4

JUNE 1968 Sht. 3 of 3

