

DOUGLAS COUNTY, OREGON
 PLANS FOR PROPOSED PROJECT
 GRADING & SURFACING
NORTH UMPQUA HIGHWAY
 COUNTY ROAD NO.4

APRIL 1970
 M.P. 5.60 to M.P. 10.67

INDEX OF DRAWINGS

SHEET #	1 - TITLE SHEET
	2 & 3 - QUAN. SUMMARIES & ROAD TYPICALS
	4 & 5 - TYPICAL SECTIONS
	6 & 7 - PIPE LIST
	8 - 17 - ROAD PLANS
STD. DWGS.	# 5, 9, 13 & 14
	TOTAL 21 SHEETS

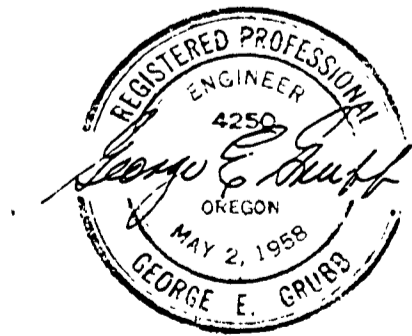
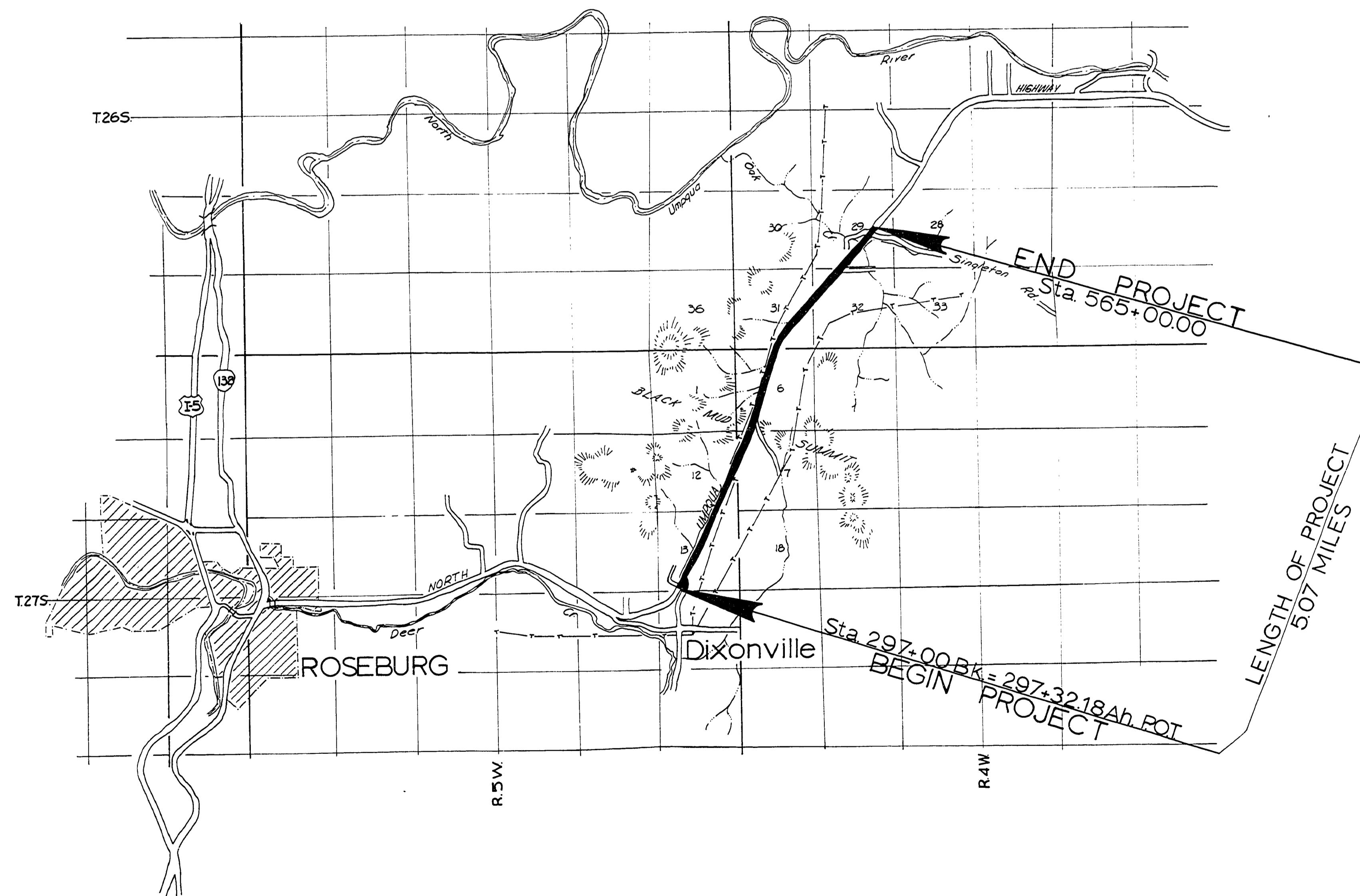

NOT REVISED
 AS CONSTRUCTED

Douglas County Road Dept.
 NORTH UMPQUA HWY. #4
 Date: April 1970 Sheet 1
 GEORGE E. GRUBB County Engineer

0563107C

Rd. # 4

52