

DOUGLAS COUNTY ORE PLANS FOR PROPOSED PROJ. GRADING & SURFACING DIAMOND LAKE BLVD. COUNTY RD. #4

JUNE 1968

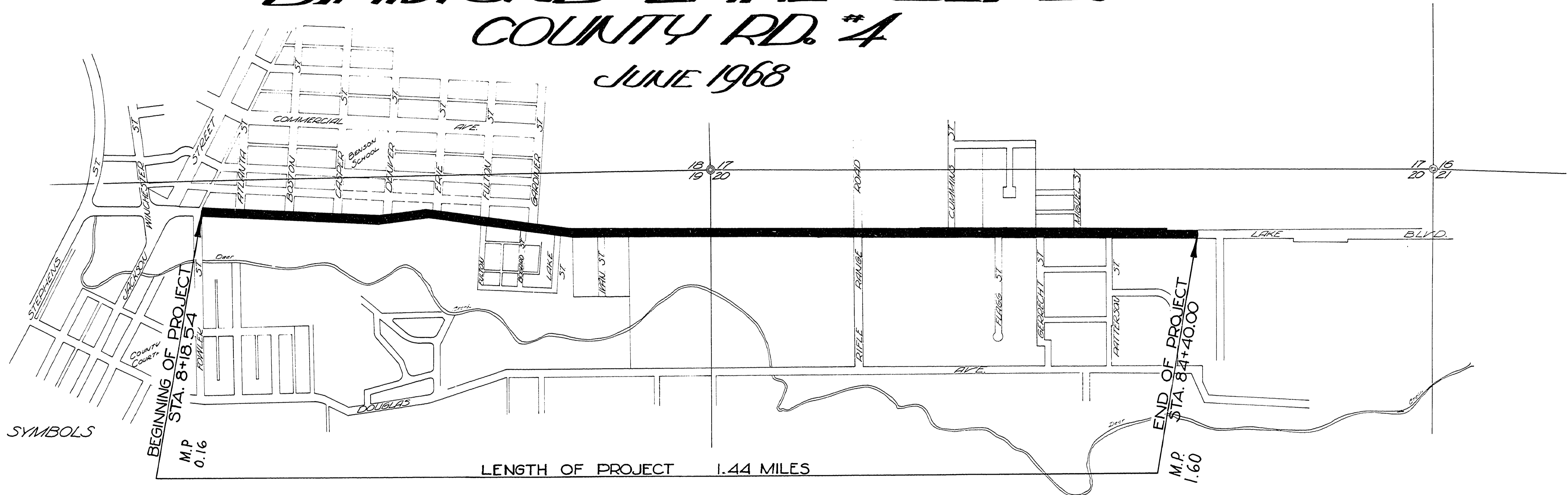

STANDARD SYMBOLS

- | | | | |
|-----|----------------------------|-----|---|
| ○ | Extg. Manhole | ⋯ | Extg. Rd. Shoulder or Driveway |
| ⊗ | Remove Extg. Manhole | ▬▬▬ | Const. Ditch |
| ⊙ | Adjust Manhole | ⌒ | Const. Curb Radius |
| ● | Const. Manhole | ⊙ | On profile signifies const. Driveway Curb Cut. "4+60" See sheet 2 |
| □ | Extg. Catch Basin | — | Extg. R/W, width in slant lettering (45°) |
| ⊗ | Remove Extg. Catch Basin | — | New R/W, width in vertical lettering (45°) |
| ■ | Const. Catch Basin | — | Slope Easement, width in vertical lettering with asterisk (*45) |
| ■ | Const. Ditch Interceptor | | |
| ⊕ | Fire Hydrant | | |
| ○ | Water Valve | | |
| ● | Gas Valve | | |
| ⊗ | Water Meter | | |
| ⊙ | Telephone Pole | | |
| ⊕ | Power Pole | | |
| ⋯ | Down Guy & Anchor Rod | | |
| ⊙ | Light Pole | | |
| ⊙ | Tree (Deciduous) | | |
| ⊙ | Tree (Evergreen) | | |
| — | Fence | | |
| — | Water Line, size indicated | | |
| ⋯ | Existing Culvert | | |
| ▬▬▬ | Install Culvert | | |
| — | Extg. Curb Line | | |
| — | Const. Curb | | |



Douglas County Road Dept.
DIAMOND LAKE BLVD. RD.
Date June, 1968 Sheet 1 of 8
George E. GRUBB County Engineer

00920179