

519 T275 R5N WM

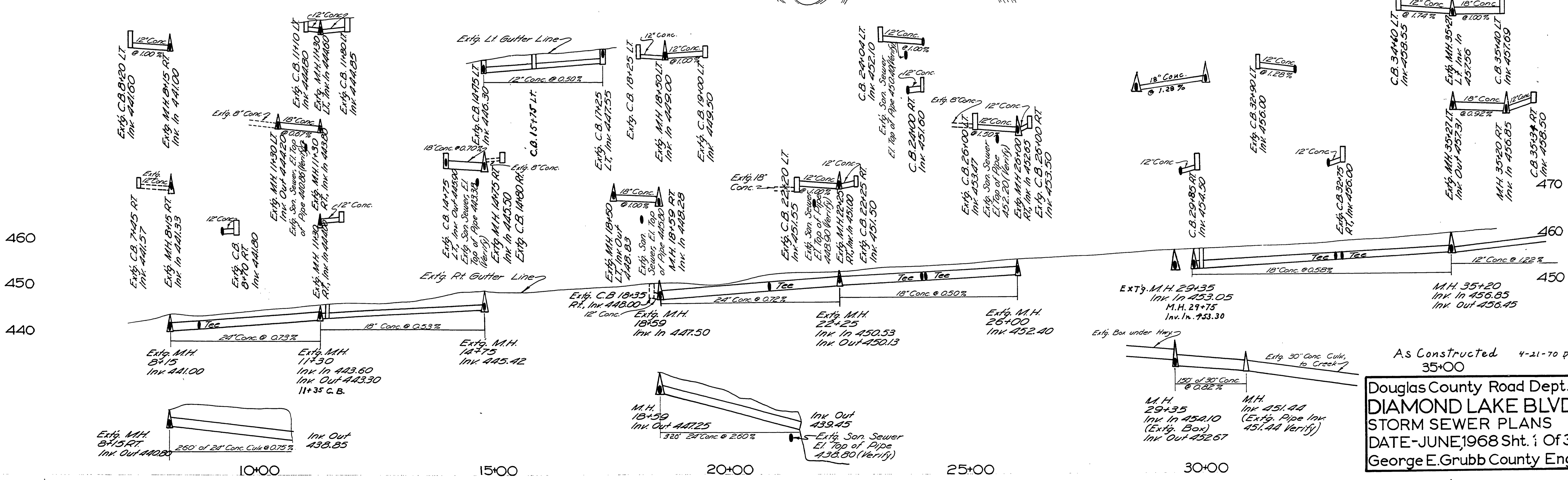
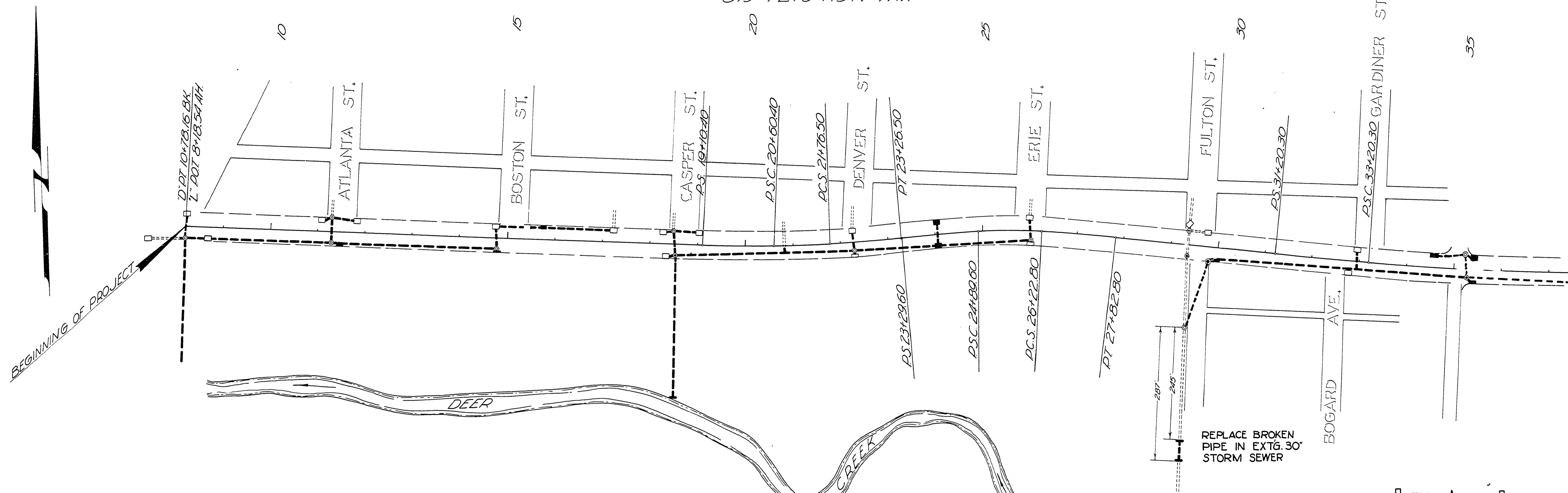

As Constructed 4-21-70 p.s.
35+00
Douglas County Road Dept.
DIAMOND LAKE BLVD.
STORM SEWER PLANS
DATE-JUNE, 1968 Sht. 1 Of 3
George E. Grubb County Eng.

00160071

M.P. 0.16 - 0.71

Rd. # A

JUNE, 1968 SAT 1 OF 3

23