

Deed Alice Baker to Douglas County
 60' Right of way St. 35+30 to St. 60+68
 Consideration \$160.00
 Road Record 8 Page 469
 Deed Record 93 Page 8

DOUGLAS COUNTY OREGON
 CRAIG SECTION
LOON LAKE ROAD M.R. N° 3
 SECTIONS 12-13, T. 23 S., R. 10 W.
 F.C. FREAR, Co. ROADMASTER.
 1930
 SHEET 2

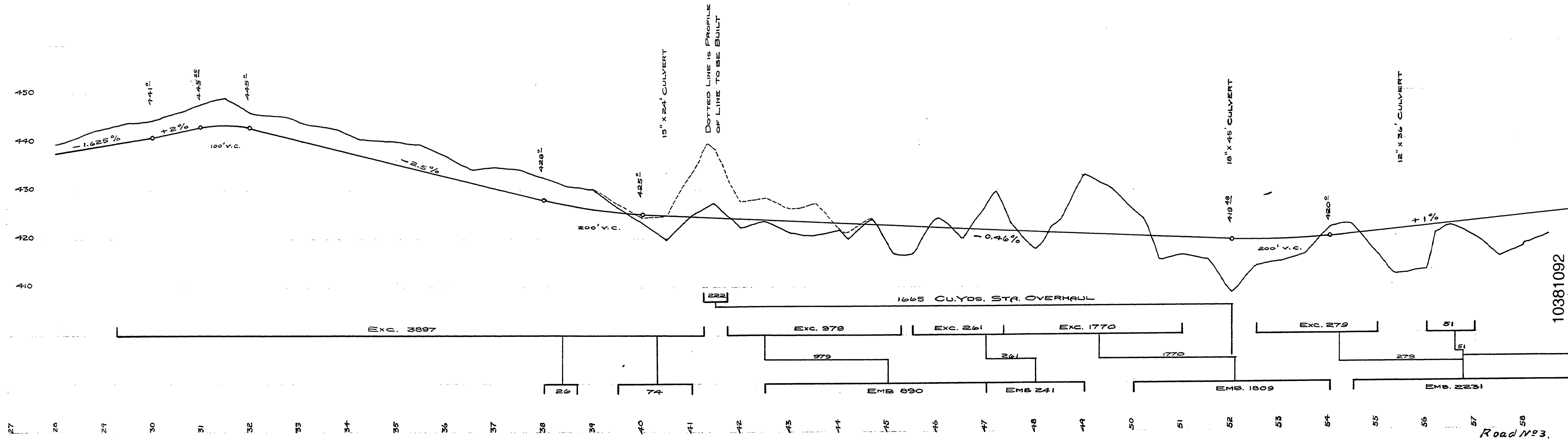

M.P. 10.38-10.92

1930
 Sht. 2 of 8

10381092

Road N° 3.