

UMPQUA RIVER

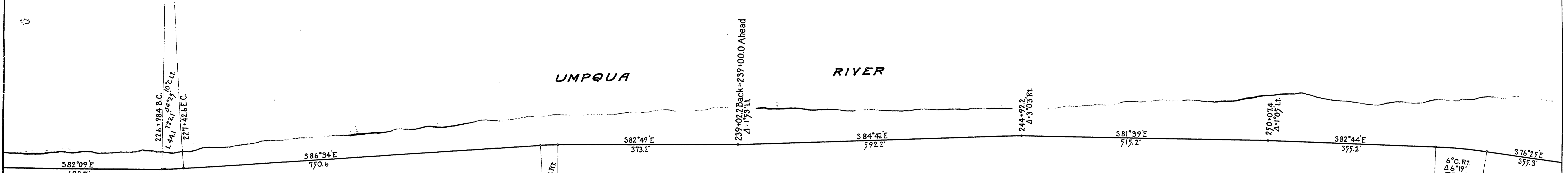

Henry Boye to Douglas County  
 60' Right of way St. 217+54 to 273+30  
 Consideration \$510<sup>00</sup>  
 Road Record 8 Page 390  
 Filed Jan. 21-1922

ELKTON-REEDSPORT ROAD  
 HINSDALE SECTION  
 SHEET N<sup>o</sup> 8

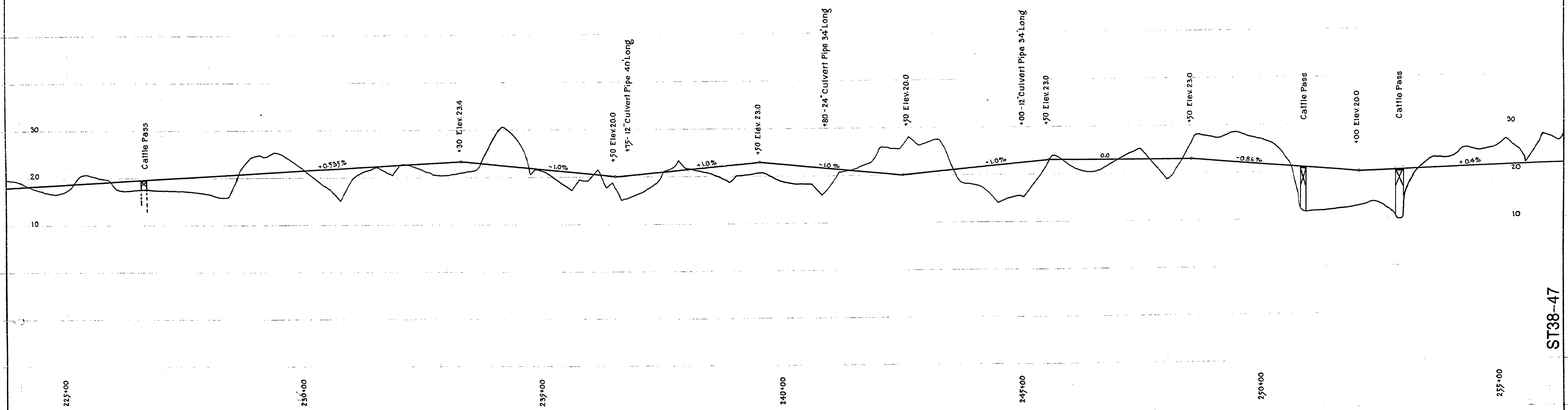

State # 38 Road N<sup>o</sup> 2  
 Aug. 1922 sht. 8 of 12 (103)

ST38-47