

UMPQUA RIVER

N88°44'E
788.8'

20° C.R.
437.32'
791.3'
L1872'

102° 8' 5" B.C.

104° 17' 8" E.C.

S73°44'E
334.7'

108° 19' 5" B.C.

10° E.L.
440.19'
7210.4'
L403.2'

112° 22' 7" E.C.

N85° 77'E
2617.8'

SECTION 32
SECTION 33

HINSDALE ESTATE

Hinsdale Estate Co. to Douglas County
60' Right of Way Sta. 11+18 to 217+54
Consideration \$1500.00 & Other Agreements
Road Record 8, Page 388
Filed Jan. 11, 1922

ELKTON-REEDSPORT ROAD
HINSDALE SECTION
SHEET No 4

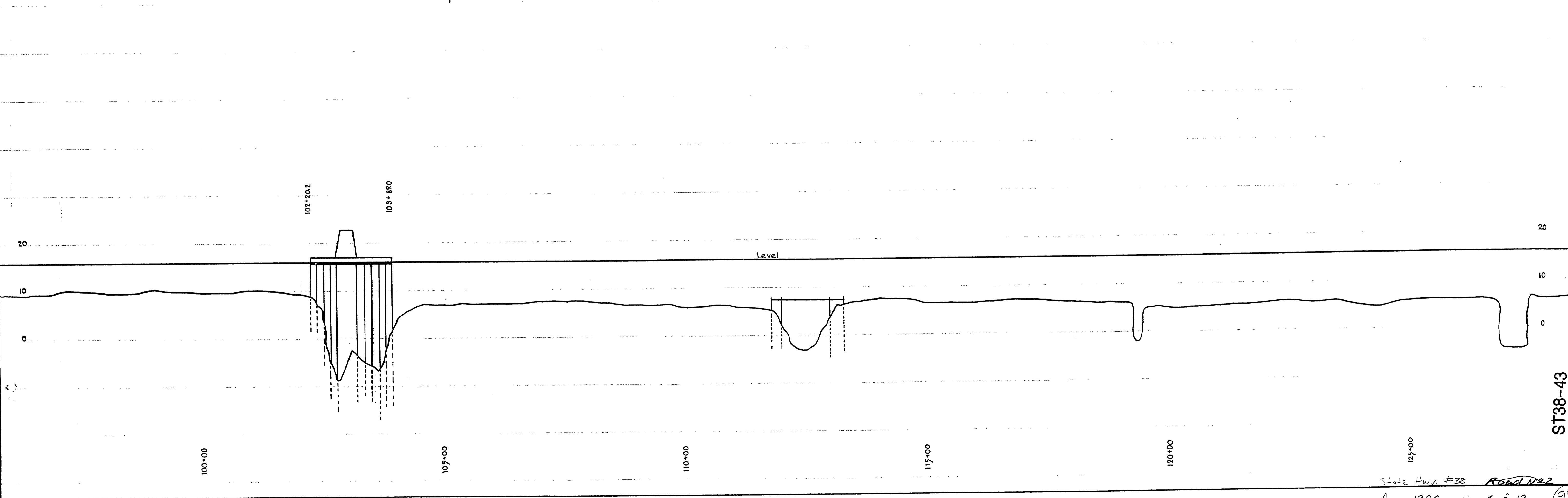

100+00

107+00

110+00

117+00

120+00

127+00

ST38-43

State Hwy. #38 Road No 2
Aug. 1922 at. 4 of 12

99