

UMPQUA RIVER

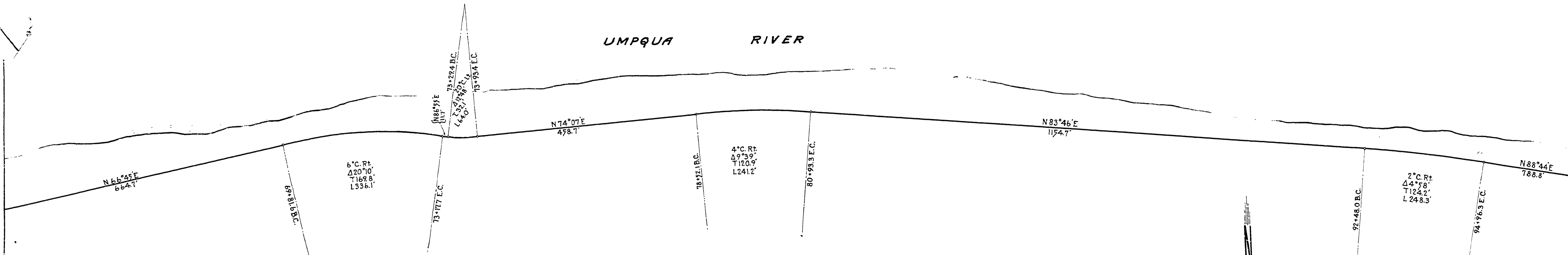

6° C. RT.
420.10'
7169.8'
1336.1'

4° C. RT.
493.35'
7120.9'
1241.2'

2° C. RT.
447.58'
7124.2'
1248.3'

Hinsdale Estate Co. to Douglas County
60' Right of way St. 11+18 to 217+54
Consideration \$1500.00 & Other Agreements
Road Record 8 Page 388
Filed Jan. 11, 1922

ELKTON-REEDSPORT ROAD
HINSDALE SECTION
SHEET N° 3

Double Pile Bulkheads
Wood Tide Box 168'x12' Long

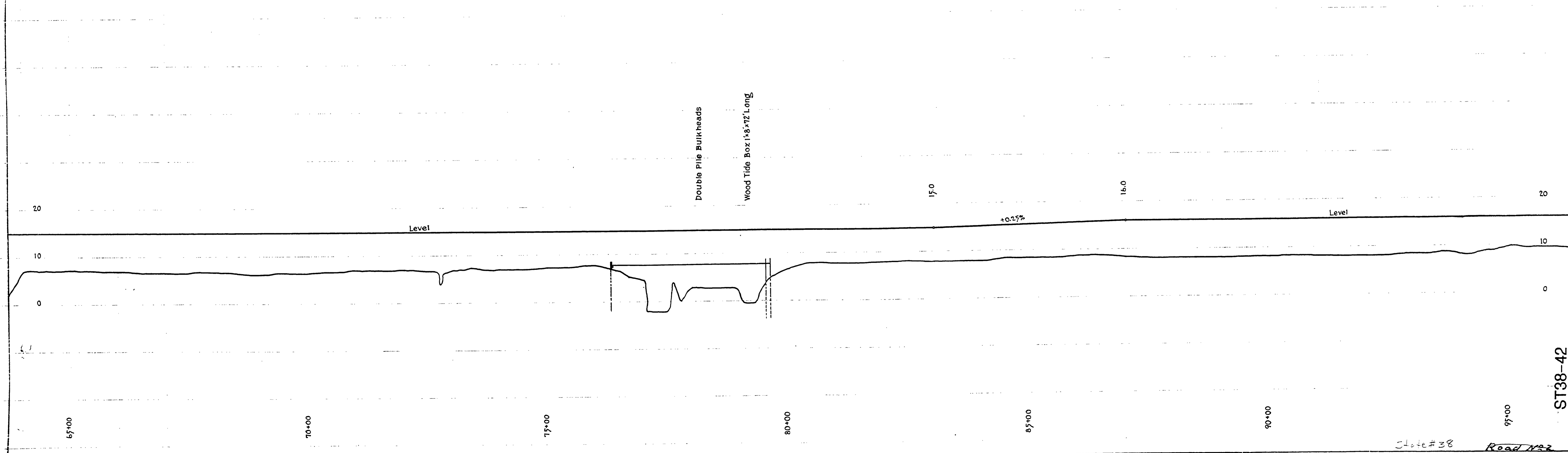

Sheet # 38 Road N° 22
Aug. 1922 sheet 3 of 12

ST38-42

