

3° C. L.
427.15
737.17
L707.3

1° 15' C. L.
422° 38'
7917.1
L1810.4

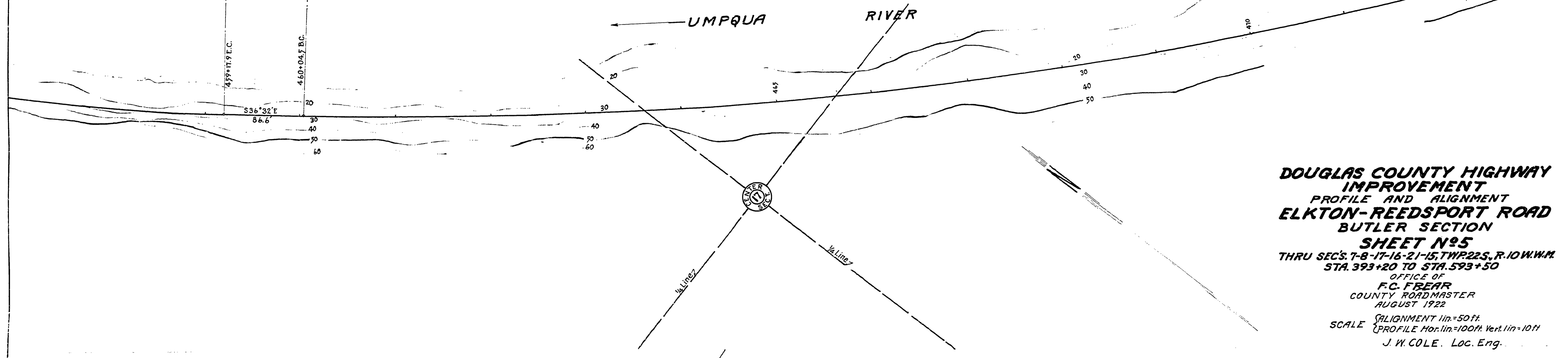

**DOUGLAS COUNTY HIGHWAY
IMPROVEMENT**
PROFILE AND ALIGNMENT
ELKTON-REEDSPORT ROAD
BUTLER SECTION
SHEET No 5
THRU SEC'S 7-8-17-16-21-15, TWP. 22 S., R. 10 W. W.M.
STA. 393+20 TO STA. 593+50
OFFICE OF
F. C. FEAR
COUNTY ROADMASTER
AUGUST 1922
SCALE: ALIGNMENT 1 in = 50 ft
PROFILE Hor. lin = 100 ft. Vert. lin = 10 ft
J. W. COLE. Loc. Eng.

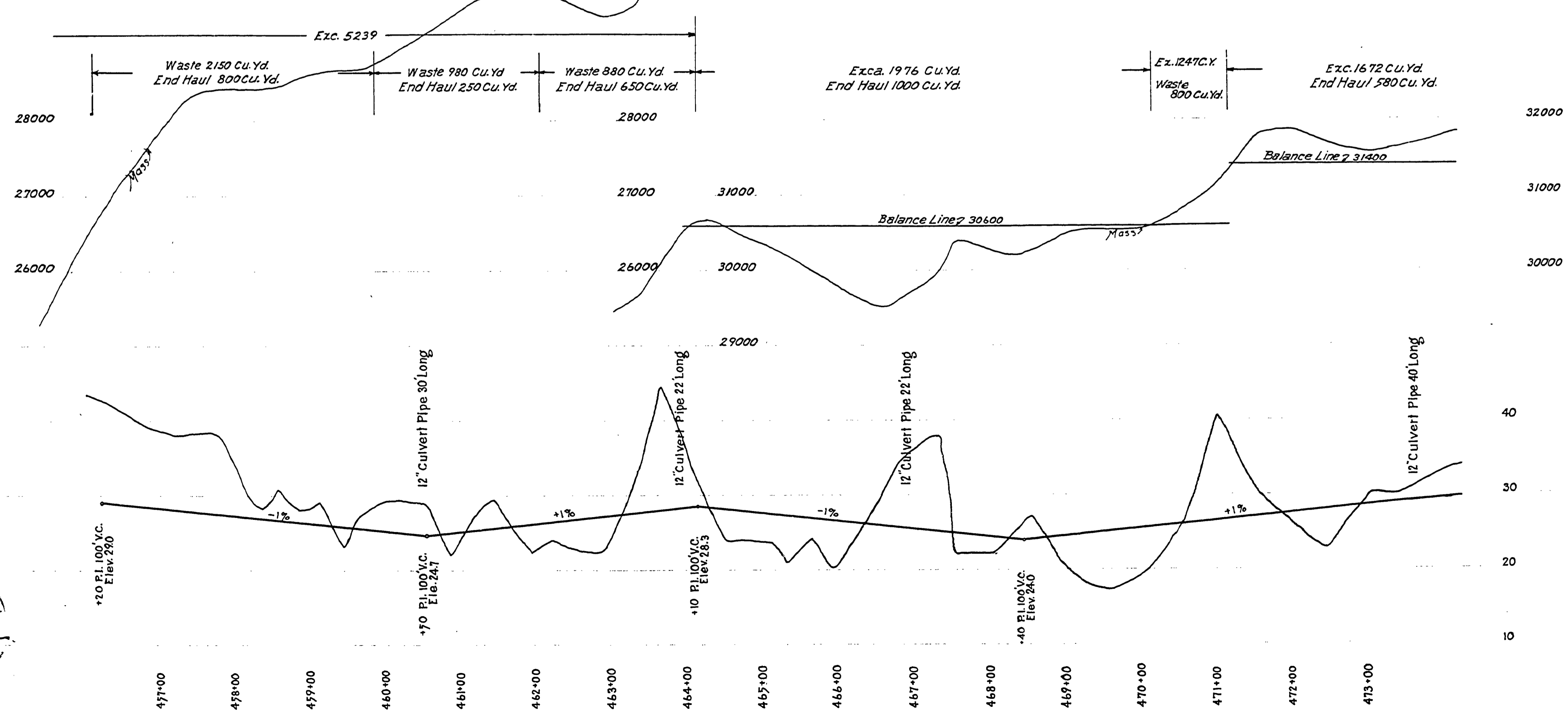

ST38-26

Umpqua State Hwy. #38 Road No. 22
Aug. 1922 SHE. 5 of 13