

3° C. L1
 Δ2° P13
 T37° L1
 L1707.3

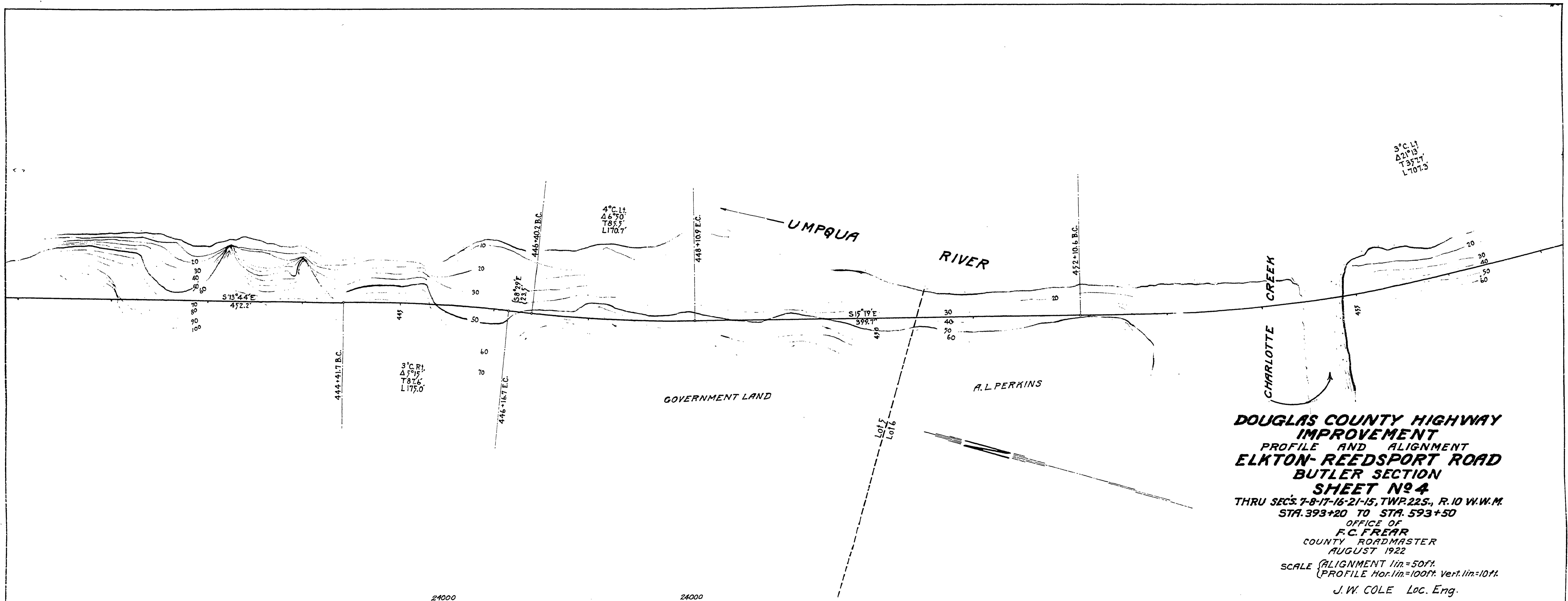

DOUGLAS COUNTY HIGHWAY IMPROVEMENT
 PROFILE AND ALIGNMENT
ELKTON-REEDSPORT ROAD BUTLER SECTION
SHEET No 4
 THRU SEC'S 7-8-17-16-21-15, TWP. 22S., R. 10 W.W.M.
 STA. 393+20 TO STA. 593+50
 OFFICE OF
F.C. FREAR
 COUNTY ROADMASTER
 AUGUST 1922
 SCALE (ALIGNMENT 1 in. = 50 ft. PROFILE Hor. 1 in. = 100 ft. Vert. 1 in. = 10 ft.)
 J.W. COLE Loc. Eng.

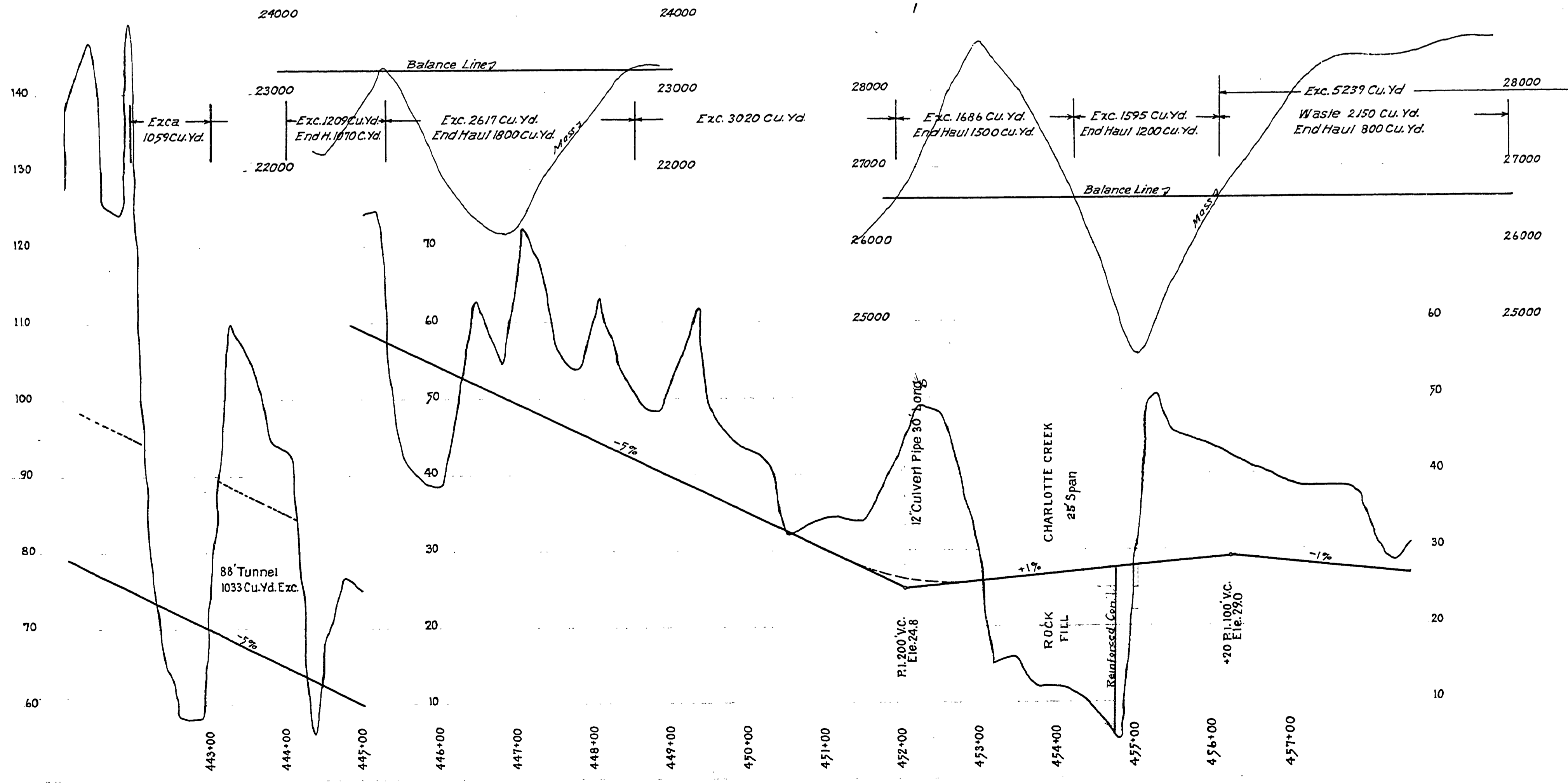

Umpqua State Hwy. #38 Road No 2
 Aug. 1922 sheet 4 of 13

ST38-25