

**DOUGLAS COUNTY HIGHWAY
IMPROVEMENT**

Profile and Alignment

TILLER-TRAIL

Section
Sec. T. S. R. W.W.M.

Platted from Gov. Field Notes
Office of F. C. Frear
County Roadmaster

HOR. SCALE 1" = 100'
VER. SCALE 1" = 10'

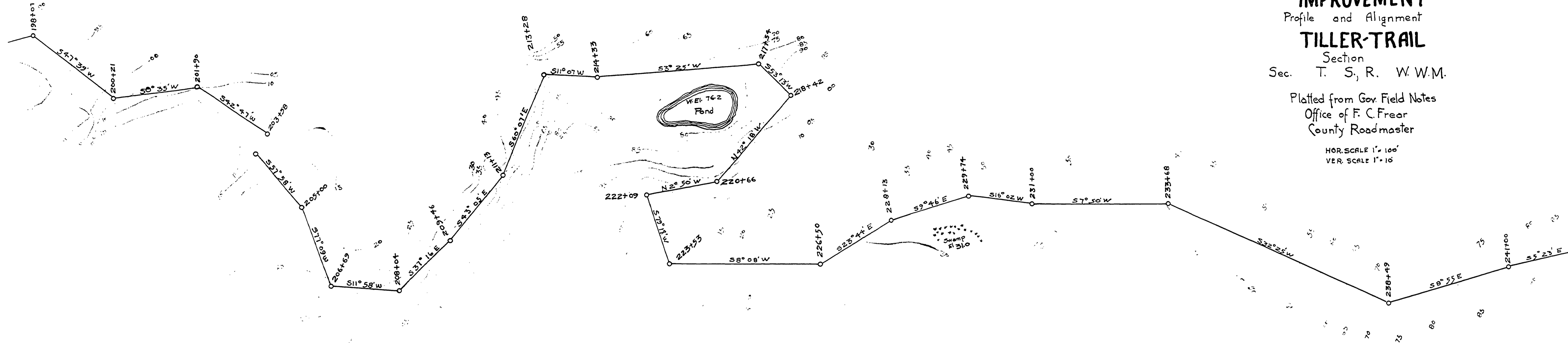

SHEET NO. 17

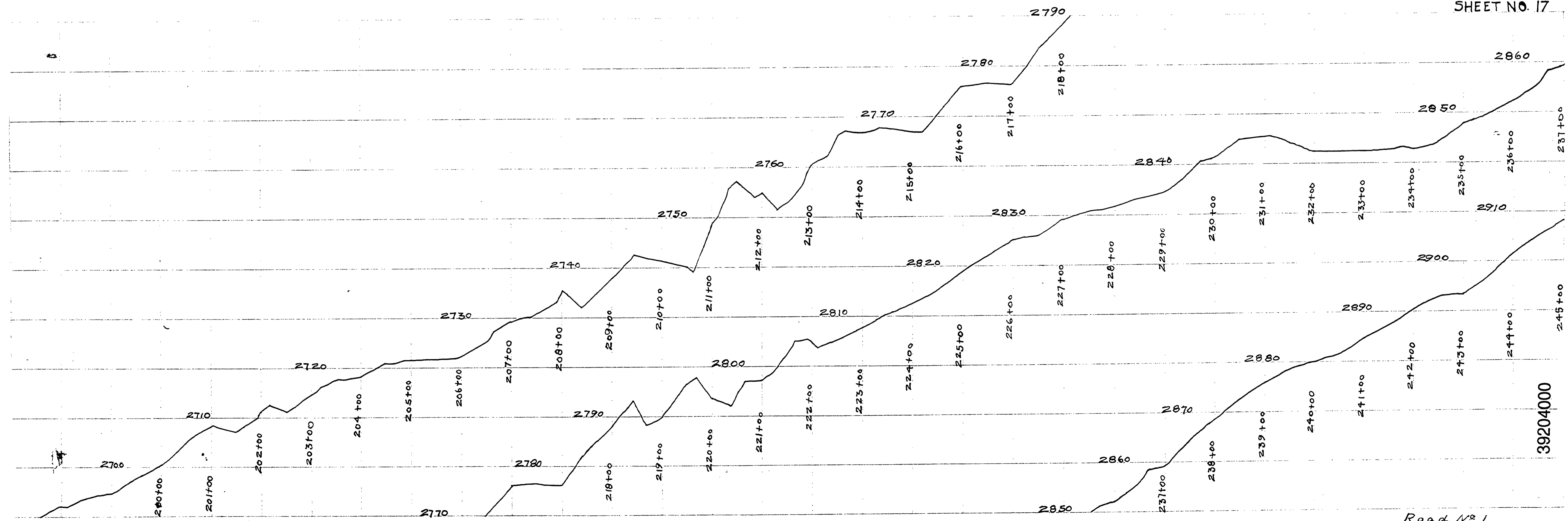

Road No. 1.

44