

DOUGLAS COUNTY HIGHWAY IMPROVEMENT

Profile and Alignment

TILLER-TRAIL

Section
Sec. T. S., R. W.W.M.

Platted from Gov. Field Notes
Office of F. C. Frear
County Roadmaster

HOR. SCALE 1" = 100'
VER. SCALE 1" = 10'

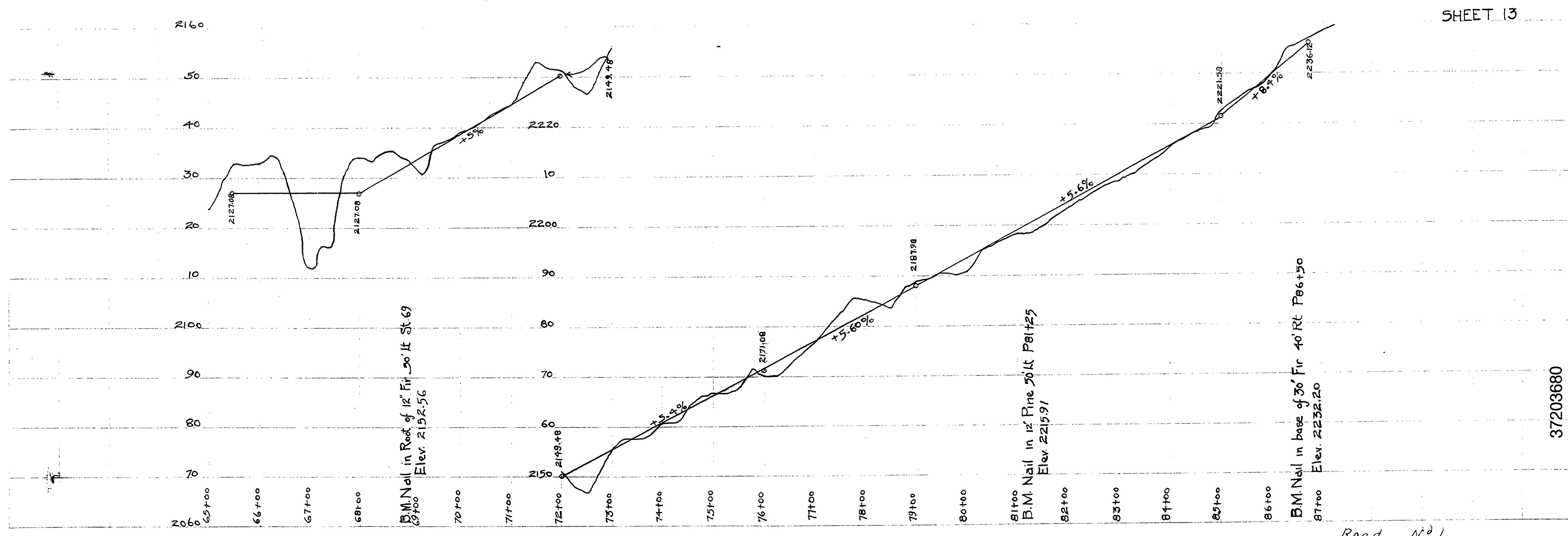
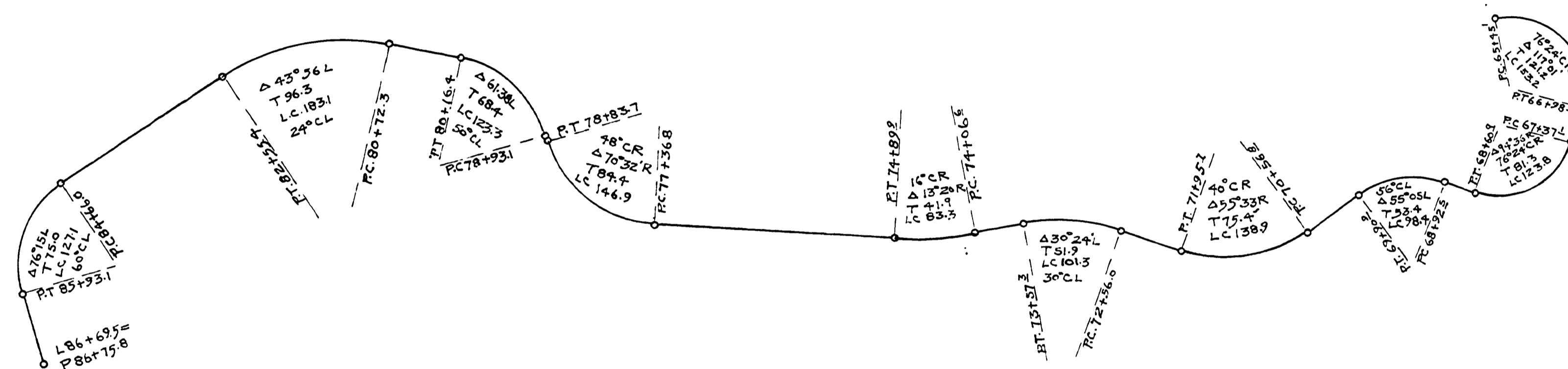

SHEET 13

Road. No 1,

37203680