

DOUGLAS COUNTY HIGHWAY IMPROVEMENT

Profile and Alignment

TILLER-TRAIL

Section

Sec. T. S., R. W.W.M.

Platted from Gov. Field Notes
Office of F. C. Frear
County Roadmaster

HOR. SCALE 1" = 100'
VER. SCALE 1" = 10'

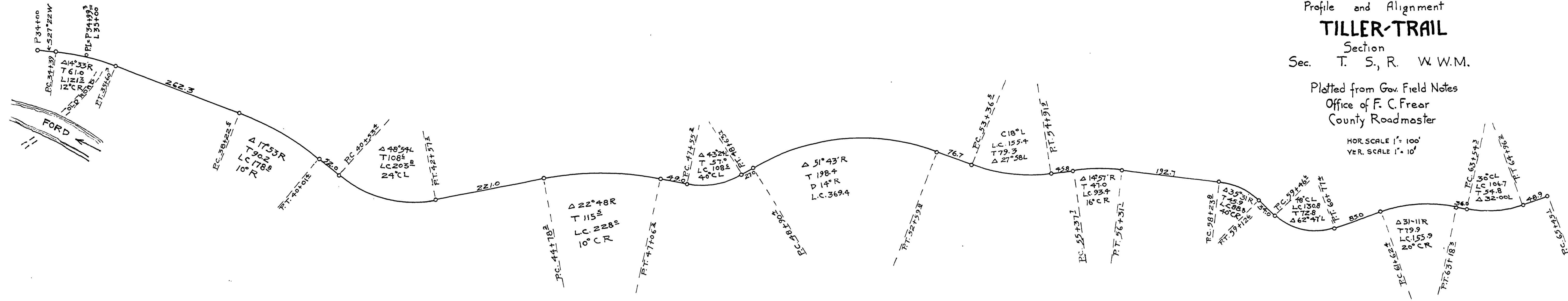

SHEET 12

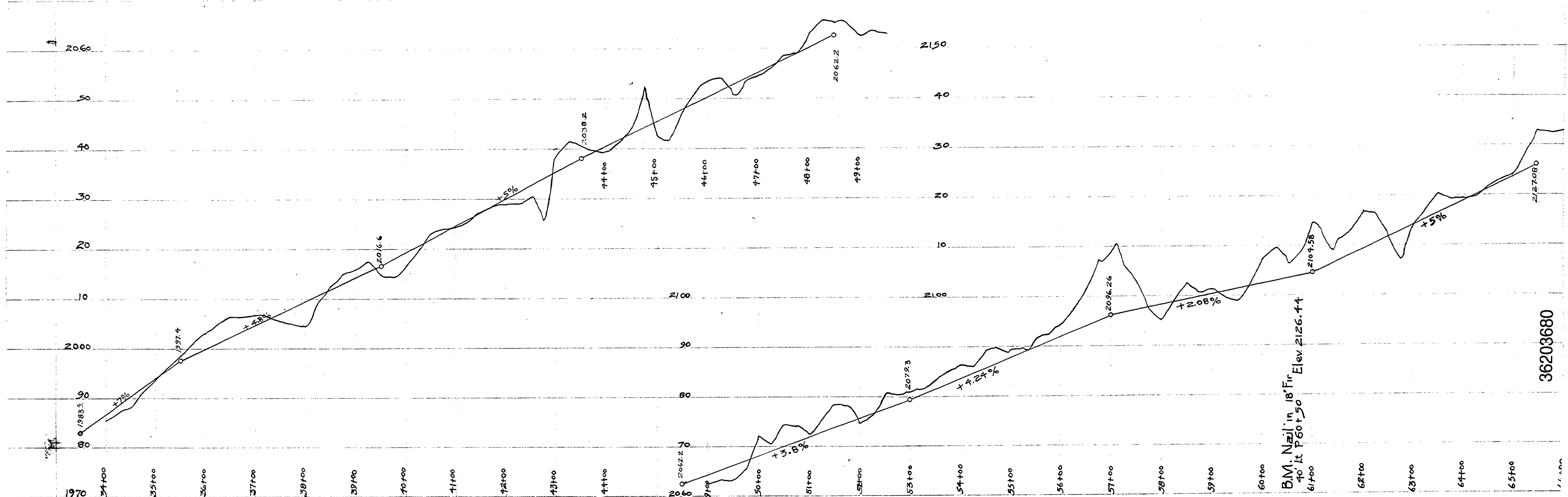

M.P. 36.2 - 36.8

NO DATE SHEET 17 of 25

39

