

DOUGLAS COUNTY OREGON
 TISON SECTION
 TILLER-TRAIL ROAD M.R. NO. 1
 SEC. 19-29-30-32, T. 31 S. R. 1 W.
 SEC. 5, T. 32 S. R. 1 W.
 F. C. FREAR, Co. Roadmaster.
 1930
 SHEET 6

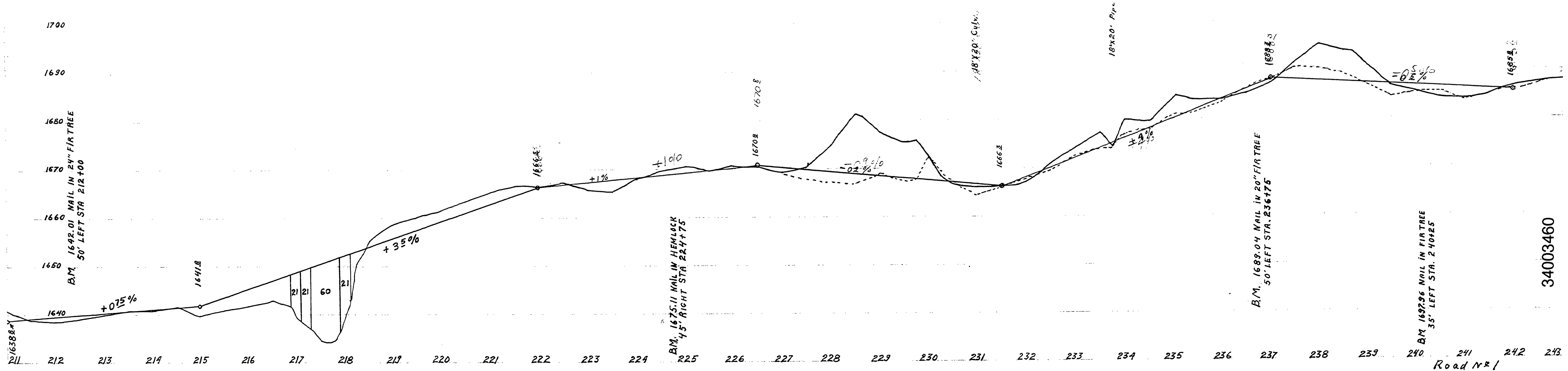

34003460

M.P. 34.0-34.6

1930 Sta. 3 of 6

