

- LEGEND:
- Found monument as noted.
  - ⊕ Found Brass Cap.
  - Set 5/8" x 30" Iron Rod with Aluminum Cap marked "DOUGLAS CO RD DPT R-W" w/ Brass Washer marked "LS 1654"
  - Calculated Point, No monumentation.

NOTE:  
 Coordinates are a local coordinate system based on Federal Highway Administration control survey. Bearings are based on this Coordinate System. Record information is available from:  
 U.S. Department of Transportation  
 Federal Highway Administration  
 Western Federal Lands Highway Division  
 610 E. Fifth Street  
 Vancouver, Wa. 98661  
 Coordinates shown are OCS 83 South Zone.

FILED  
 Date: 7-14-95 By: [Signature]  
 This survey consists of 9 PAGES  
 Map: \_\_\_\_\_  
 Narrative: \_\_\_\_\_  
 Corner Plat: \_\_\_\_\_  
 J. DOUGLAS COUNTY SURVEYOR

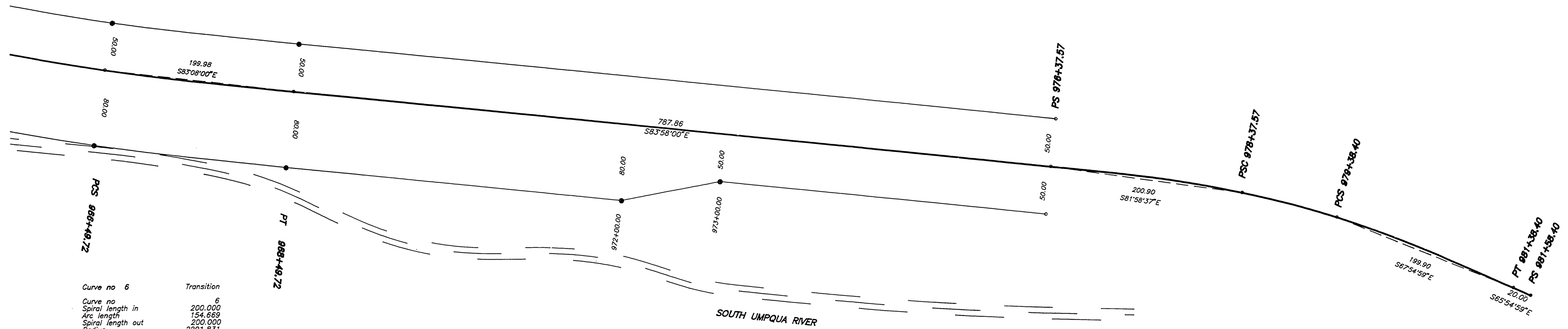

Curve no 6 Transition

Curve no	6
Spiral length in	200.000
Arc length	154.669
Spiral length out	200.000
Radius	2291.831
Delta	5°52'00"
Chord bearing	S79°32'00"E
Chord distance	154.640

Curve no 7 Transition

Curve no	7
Spiral length in	200.000
Arc length	100.838
Spiral length out	200.000
Radius	954.930
Delta	6°03'01"
Chord bearing	S74°56'30"E
Chord distance	100.791

**RIGHT-OF-WAY SURVEY OF CANYONVILLE-TRAIL HIGHWAY**

IN NE 1/4, SEC. 34, SE 1/4 SEC. 27, SW 1/4, NW 1/4  
 & NE 1/4, SEC. 26 AND NW 1/4, SEC. 25  
 T30S, R3W, W.M.

For Federal Highway Administration  
 22 MAY 1995

COUNTY SURVEYORS FILE DATA  
 DO NOT REMOVE FROM OFFICE

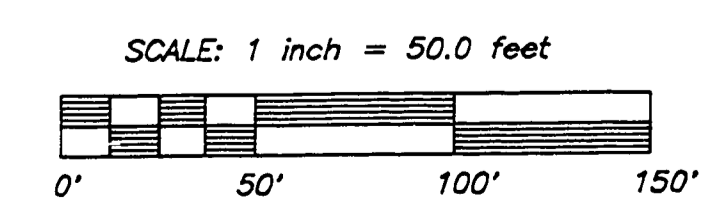

REGISTERED PROFESSIONAL LAND SURVEYOR  
 [Signature]  
 OREGON  
 JULY 14, 1978  
 RONALD A. QUIMBEY  
 1854  
 EXP. DATE: 12/31/96

**AA**  
**SURVEYING SERVICE, INC.**  
 3076 EAST DIAMOND LAKE BLVD.  
 ROSEBURG, OREGON 97470  
 TEL (503)672-2096  
 FAX (503)672-0611

SHEET 9 OF 9

M.P. 21.72 - 21.87

CO. RD. #1

21722187

45