

INSET SHOWING DETAILS OF STRUCTURES
FROM STATION 2452+35 TO 2460+00
Scale 1" = 200'

GARDINER
STATION PLANS
See R738739

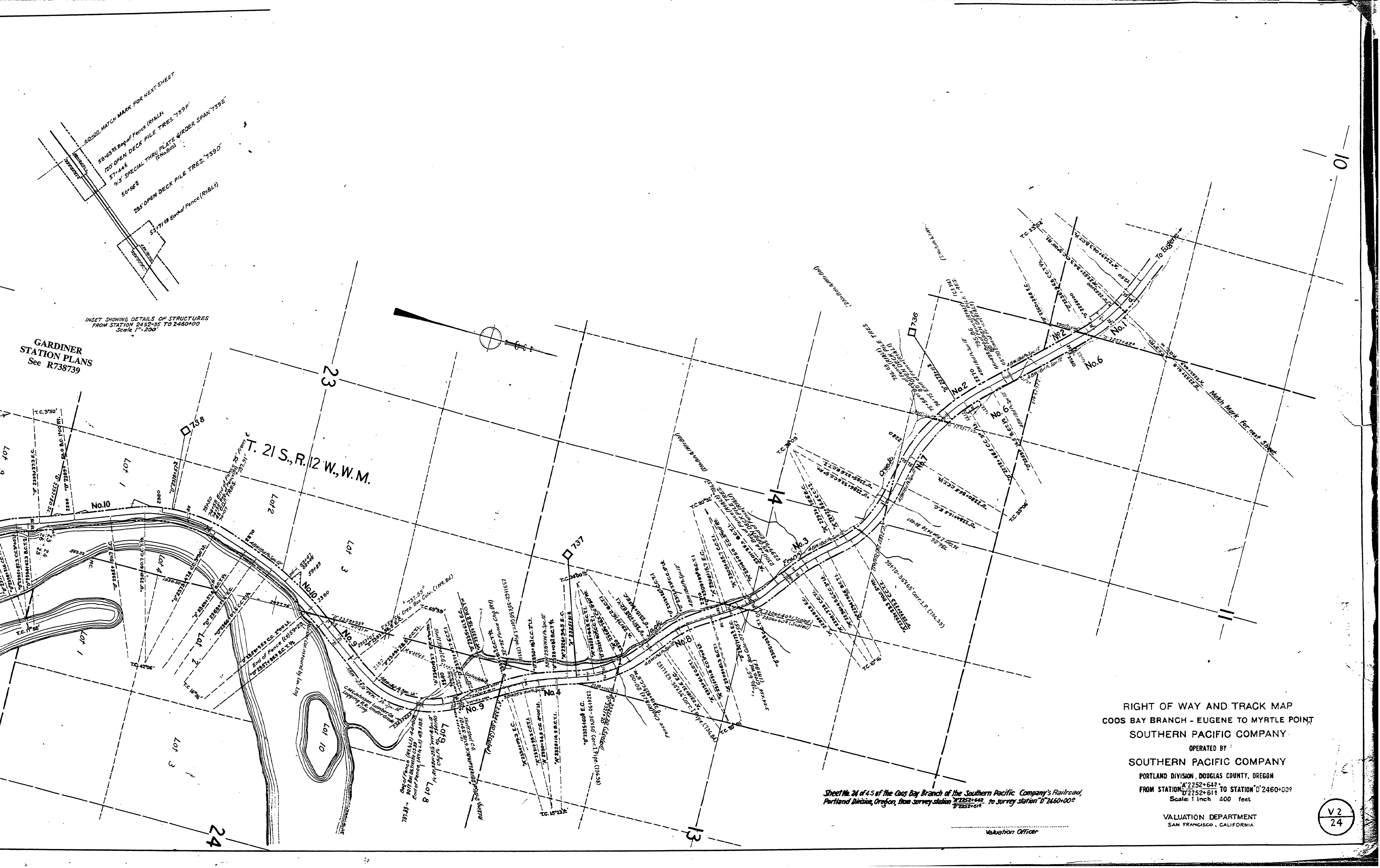

RIGHT OF WAY AND TRACK MAP
COOS BAY BRANCH - EUGENE TO MYRTLE POINT
SOUTHERN PACIFIC COMPANY
OPERATED BY
SOUTHERN PACIFIC COMPANY
PORTLAND DIVISION, DOUGLAS COUNTY, OREGON
FROM STATION 2252+64.9 TO STATION 2460+00.9
Scale: 1 inch = 400 feet
VALUATION DEPARTMENT
SAN FRANCISCO, CALIFORNIA

Sheet No. 24 of 45 of the Coos Bay Branch of the Southern Pacific Company's Railroad,
Portland Division, Oregon, from survey station 2252+64.9 to survey station 2460+00.9

Valuation Officer