

INSET SHOWING DETAILS OF STRUCTURES  
FROM STATION 2452+35 TO 2460+00  
Scale 1" = 200'

GARDINER  
STATION PLANS  
See R738739

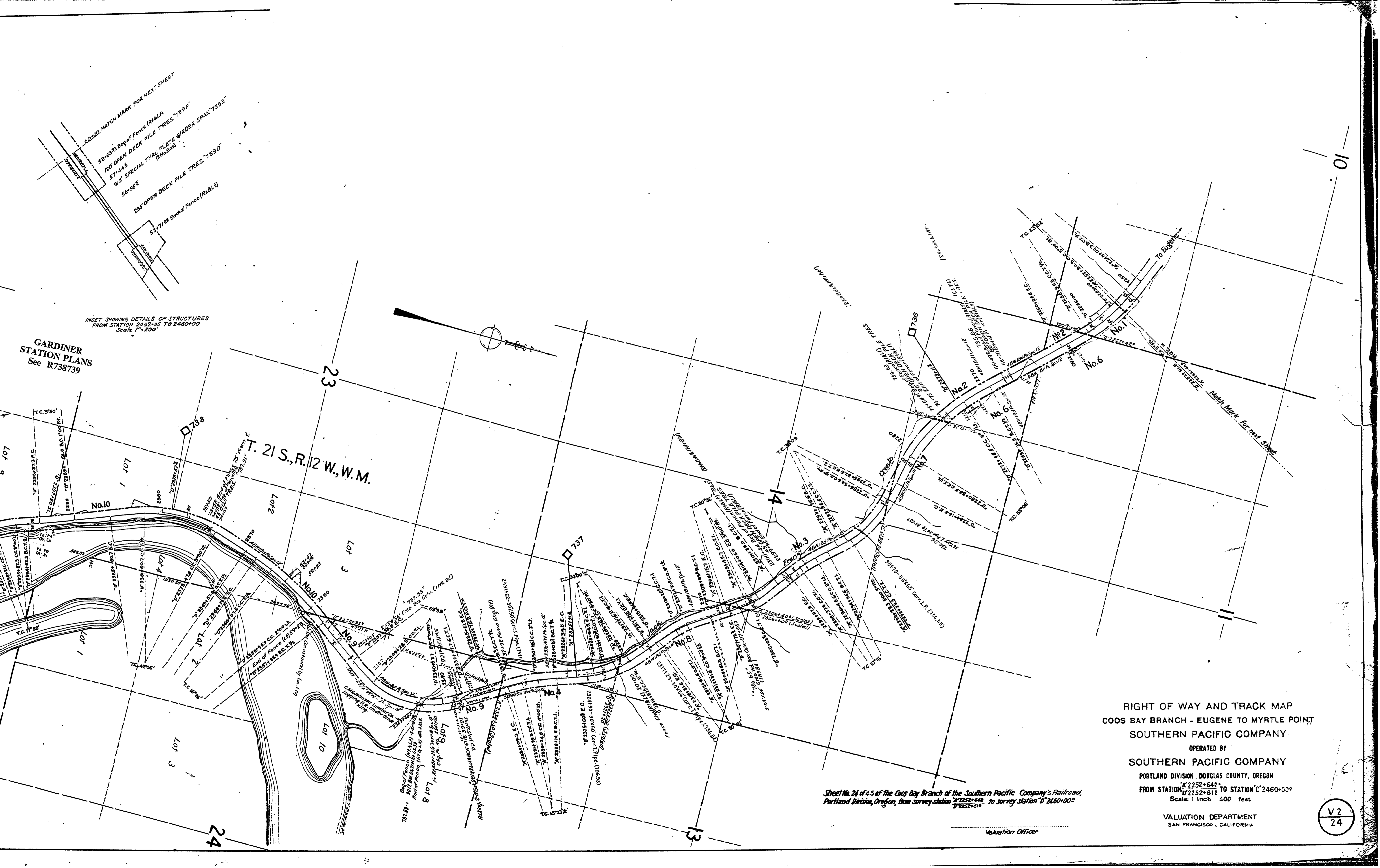

T. 21 S., R. 12 W., W.M.

RIGHT OF WAY AND TRACK MAP  
COOS BAY BRANCH - EUGENE TO MYRTLE POINT  
SOUTHERN PACIFIC COMPANY  
OPERATED BY  
SOUTHERN PACIFIC COMPANY  
PORTLAND DIVISION, DOUGLAS COUNTY, OREGON  
FROM STATION 2252+64.9 TO STATION 2460+00.9  
Scale: 1 inch = 400 feet  
VALUATION DEPARTMENT  
SAN FRANCISCO, CALIFORNIA

Sheet No. 24 of 45 of the Coos Bay Branch of the Southern Pacific Company's Railroad,  
Portland Division, Oregon, from survey station 2252+64.9 to survey station 2460+00.9

Valuation Officer