

ROUND PRAIRIE
STATION PLANS
See R556557

Sta. Pt. 783+34.5
ROUND PRAIRIE
ABANDONED SEPT 21, 1934.
Mile 557.1

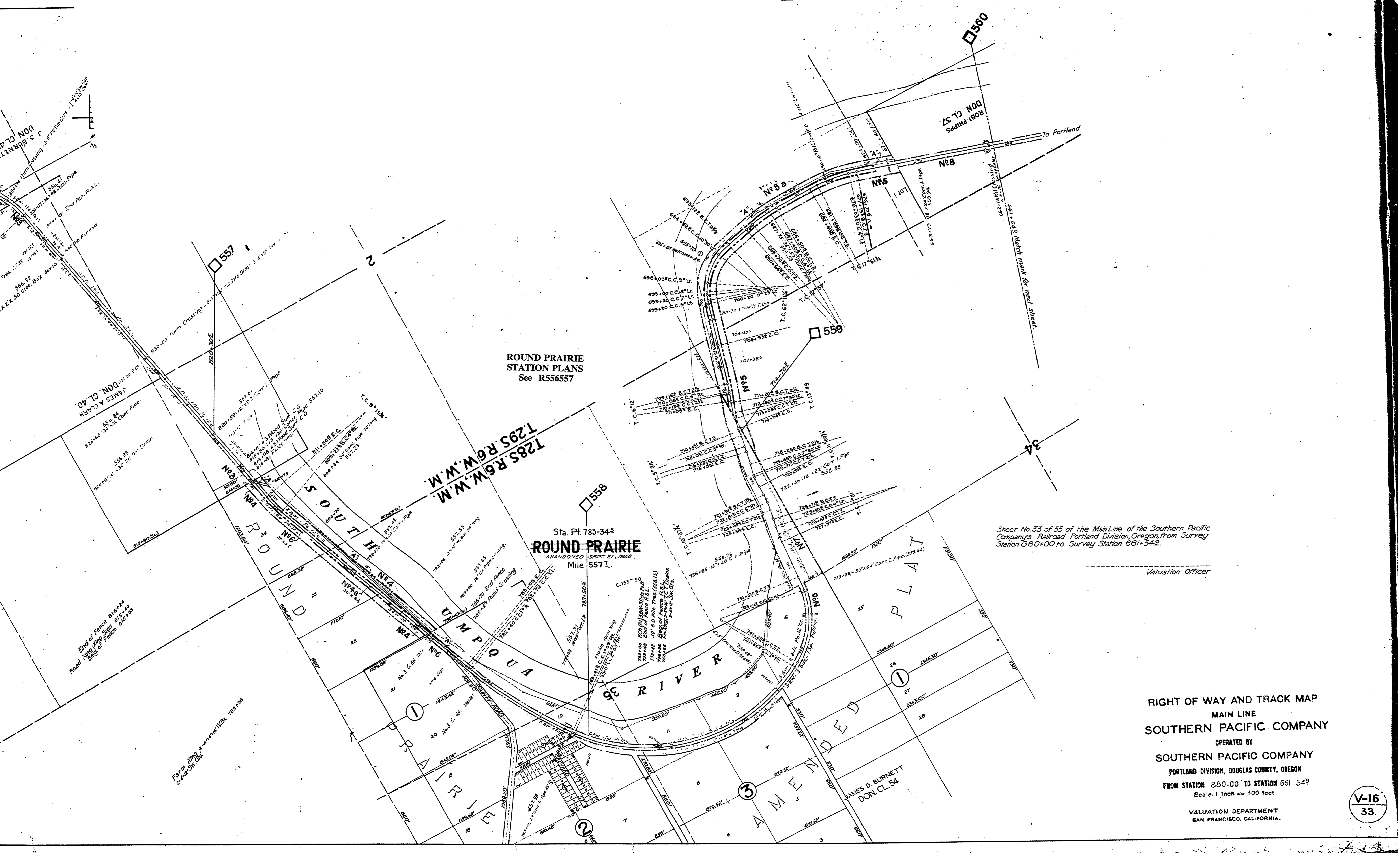

ROUND PRAIRIE
STATION PLANS
See R556557

1285 R.O.W. W.M.
1295 R.O.W. W.M.

Sta. Pt. 783+34.5
ROUND PRAIRIE
ABANDONED SEPT 21, 1932
Mile 557.1

Sheet No. 33 of 55 of the Main Line of the Southern Pacific Company's Railroad Portland Division, Oregon, from Survey Station 680+00 to Survey Station 661+54.2.

Valuation Officer

RIGHT OF WAY AND TRACK MAP
MAIN LINE
SOUTHERN PACIFIC COMPANY
OPERATED BY
SOUTHERN PACIFIC COMPANY
PORTLAND DIVISION, DOUGLAS COUNTY, OREGON
FROM STATION 880+00 TO STATION 661+54.2
Scale: 1 inch = 400 feet
VALUATION DEPARTMENT
SAN FRANCISCO, CALIFORNIA.

V-16
33