

Note: Oregon & California Railroad Company was purchased by the Southern Pacific Company January 3, 1927 by B & S Deed No. 19397 and recorded August 24, 1927 in Deed Book 89, Page 390, Records of Douglas County, Oregon.

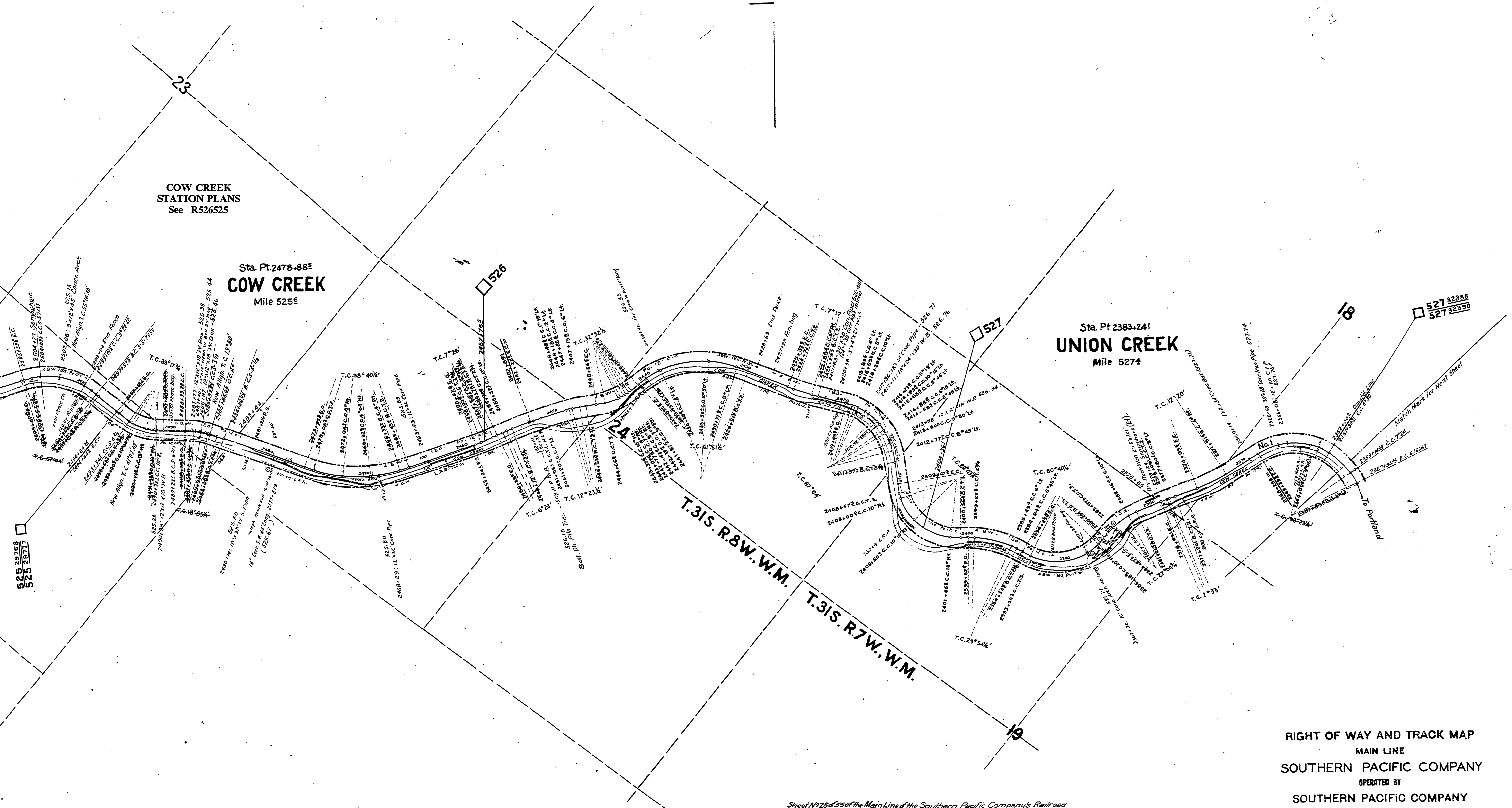

COW CREEK
STATION PLANS
See R526525

Sta. Pt. 2478+88 1/2
COW CREEK
Mile 525 1/2

Sta. Pt. 2383+24 1/2
UNION CREEK
Mile 527 1/2

T.31S. R.8W. W.M.

T.31S. R.7W. W.M.

RIGHT OF WAY AND TRACK MAP
MAIN LINE
SOUTHERN PACIFIC COMPANY
OPERATED BY
SOUTHERN PACIFIC COMPANY
PORTLAND DIVISION, DOUGLAS COUNTY, OREGON
FROM STATION 2563+36 1/2 TO STATION 2360+00 1/2
Scale: 1 Inch = 400 feet
VALUATION DEPARTMENT
SAN FRANCISCO, CALIFORNIA

Sheet No. 25 of 35 of the Main Line of the Southern Pacific Company's Railroad
Portland Division, Oregon, from Survey Station 2363+36 1/2 to Survey
Station 2360+00 1/2.

Valuation Officer

V-16
25