



# LAND PARTITION

LOCATED in the SW 1/4 of Section 19, T. 25 S., R. 5 W., W.M. in the City of Sutherlin, Douglas County, Oregon.

June, 2019

**SURVEYED FOR:** ADAM AND NANETTE HALEY  
420 MYRTLE STREET  
SUTHERLIN, OREGON 97479

**SURVEYED BY:** DAVID EDWARDS LAND SURVEYING  
P.O. BOX 361  
OAKLAND, OREGON 97462  
PHONE: (541) 459-0512

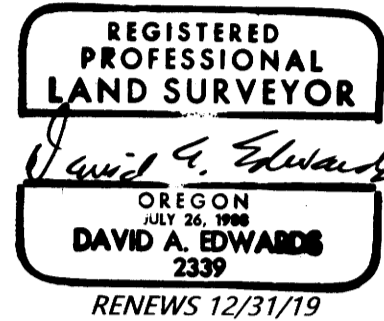

**LEGEND**

- INDICATES 5/8" DIAM. IRON ROD WITH CAP FOUND PER M 135-54 OR P.P. 2001-0098 OR P.P. 2003-0012.
  - INDICATES 5/8" DIAM. O.D.O.T. R/W MONUMENT FOUND AT STATION 1835+43.61 ( 125' RIGHT ) P.C.S.
  - INDICATES 5/8" X 30" STEEL REBAR W/RED PLASTIC CAP MKD. \*D.A. EDWARDS-L.S. 2339\* SET.
  - + INDICATES A COMPUTED POINT.
  - ( ) DENOTES RECORD DATA PER P.P. 2003-0012.
- SCALE: 1" = 60'
- BASIS OF BEARINGS: P.P. 2003-0012 AS SHOWN. P.P. = PARTITION PLAT NUMBER.

**NARRATIVE**

THE PURPOSE OF THIS SURVEY IS TO SHOW THE PARTITIONING OF PARCEL 1 OF PARTITION PLAT NUMBER 2003-0012 INTO TWO SEPARATE PARCELS. FOUND MONUMENTS PER THAT PLAT, AS WELL AS M 135-54 AND PARTITION PLAT NUMBER 2001-0098 WERE HELD FOR CONTROL AS SHOWN.

FIELD CREW: DAVID EDWARDS, BRANT MILLER AND ERIC SPRINKLE.

EQUIPMENT: NIKON TOTAL STATION.

COMPUTATIONS AND DRAFTING: DAVID EDWARDS.

LINE NO.	BEARING	DISTANCE
L1	N 69°33'00" E	32.27'
L2	S 88°36'33" E	172.97'
L3	N 5°06'41" E	109.81'
L4	N 4°30'59" W	57.75'
L5	S 88°55'29" E	55.50'
L6	S 74°32'33" E	55.91'
L7	S 69°22'48" E	63.24'
L8	S 59°45'02" E	37.00'
L9	S 48°48'15" E	33.17'

ALL RECORD DATA PER P.P. 2001-0098.

**NOTE REGARDING EASEMENTS:**

EASEMENTS WHICH MAY AFFECT THE SUBJECT PROPERTY FOUND IN AMERITITLE S.O.R.T. REPORT NUMBER 279008AM THAT GIVE NO SPECIFIC LOCATION.

EASEMENT	DIMENSION	PURPOSE
DOC. NO. 64557	10' WIDE	POWER LINES
DOC. NO. 95-18555	25' WIDE	ROADWAY EASEMENT

