

2014-0014

LAND PARTITION PLAT

IN THE S.E. 1/4, SECTION 20, S. 1/2, SECTION 21 AND N. 1/2, SECTION 28
TOWNSHIP 24 SOUTH, RANGE 6 WEST, W. M.
DOUGLAS COUNTY, OREGON
PLANNING FILE NO. M14-031 - AUGUST 2014

Douglas County Official Records
Patricia K. Hitt, County Clerk 2014-011728

NO FEE
00375431201400117280010012
09/04/2014 08:14:04 AM
PLAT-PAR Cnt=1 Stn=17 ROBIN
This is a no fee document

SURVEYORS CERTIFICATE:

I, CARL A. SWEEDEN, A REGISTERED PROFESSIONAL LAND SURVEYOR DO HEREBY CERTIFY THAT I HAVE CORRECTLY MAPPED THE LAND PARTITIONED THE LANDS SHOWN HEREON IN ACCORDANCE WITH OREGON REVISED STATUTES, CHAPTER 92 AND THAT THE LANDS HAVE NOT BEEN SURVEYED OR MARKED IN ANY WAY.

Carl A. Sweeden
CARL A. SWEEDEN



APPROVALS:

Randy Smith 9-3-14
DOUGLAS COUNTY SURVEYOR DATE

Keith L. Cubie 9/3/14
DIRECTOR, DOUGLAS COUNTY, OREGON DATE
PLANNING DEPARTMENT

I HEREBY CERTIFY THAT ALL TAXES AND SPECIAL ASSESSMENTS OR OTHER CHARGES REQUIRED BY LAW HAVE BEEN PAID.

Brook Pence 9/3/2014
DOUGLAS COUNTY TAX COLLECTOR DATE

FILED THIS 4TH DAY OF September, 2014

Patricia K. Hitt 9-4-14
COUNTY CLERK DATE

DECLARATION:

KNOW ALL PEOPLE BY THESE PRESENTS THAT RICHARD A. PETERSEN AND JESSICA M. PETERSEN DO HEREBY DECLARE THAT THEY ARE THE OWNERS OF THE LAND AND THAT THEY DO CAUSE THE PROPERTY TO BE PARTITIONED AND PLATTED IN ACCORDANCE WITH THE PROVISIONS OF CHAPTER 92, OREGON REVISED STATUTES AND IN ACCORDANCE WITH PLANNING APPROVAL FILE #M14-031, DOUGLAS COUNTY, PLANNING DEPARTMENT.

Richard A. Petersen
RICHARD A. PETERSEN

Jessica M. Petersen
JESSICA M. PETERSEN

COUNTY ROAD #23
GREEN VALLEY ROAD
VARIABLE WIDTH RW
PARCEL 1
88.92 AC ML

S 1/2, SW 1/4, SEC. 21
(PART OF PARCEL 1, INST. #92-14820)

SW 1/4, SE 1/4, SEC. 21
(PART OF PARCEL 1, INST. #92-14820)



NOT SURVEYED

PARCEL 2
160.00 AC ML

NE 1/4, NW 1/4, SEC. 28

N 1/2, NE 1/4, SEC. 28
(PARCEL 2, INST. #92-14820)

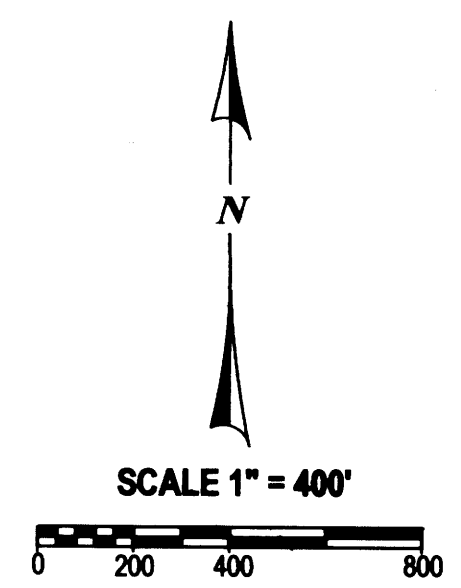

LEGAL DESCRIPTION:

THE FOLLOWING PORTIONS OF INSTRUMENT #92-14820, DOUGLAS COUNTY, OREGON DEEDS AND RECORDS ALL BEING IN TOWNSHIP 24 SOUTH, RANGE 6 WEST, WILLAMETTE MERIDIAN:

ALL OF PARCEL NO. 1 BEING THE SOUTH HALF OF THE SOUTHWEST QUARTER AND SOUTHWEST QUARTER OF THE SOUTHEAST QUARTER OF SECTION 21

ALL OF PARCEL NO. 2 BEING THE NORTH HALF OF THE NORTHEAST QUARTER AND EAST HALF OF THE NORTH HALF OF THE NORTHWEST QUARTER, SECTION 28

ALL OF PARCEL NO. 3 BEING THAT PART OF THE SOUTHEAST QUARTER OF THE SOUTHEAST QUARTER OF SECTION 20 BEING EAST OF THE PRESENT EXISTING COUNTY ROAD.

ACKNOWLEDGEMENTS:

STATE OF OREGON)
COUNTY OF DOUGLAS)

THERE PERSONALLY APPEARED BEFORE ME RICHARD A. PETERSEN AND JESSICA M. PETERSEN WHO ARE KNOWN TO ME TO BE THE IDENTICAL INDIVIDUALS WHO EXECUTED THE FORGOING INSTRUMENT AND WHO DO HEREBY ACKNOWLEDGE SAID INSTRUMENT TO BE THEIR VOLUNTARY ACT AND DEED.

THIS INSTRUMENT WAS ACKNOWLEDGED BEFORE ME ON THIS:

29TH DAY OF August, 2014.

Kimberly A. Risk *Kimberly A. Risk*
NOTARY PUBLIC - OREGON (PRINTED NAME) (SIGNATURE)

475709 February 14, 2017
COMMISSION NO. MY COMMISSION EXPIRES

EASEMENTS OF RECORD:

RIGHT OF WAY EASEMENT PER INST. #95-06674, DOUGLAS COUNTY, OREGON DEEDS AND RECORDS TO BENEFIT WEST DOUGLAS ELECTRIC COOPERATIVE, INC. EXISTING LOCATION OF ANY ELECTRIC TRANSMISSION LINES.

EASEMENT FOR INGRESS AND EGRESS RESERVED PER WARRANT DEED INST. #92-14818. FOR THE BENEFIT OF PARCEL 2 ONLY.

NARRATIVE:

THE LANDS SHOWN HEREON WERE DRAFTED TO SHOWN THE LANDS TO BE PARTITIONED AND THE PARCELS SHOWN ARE LAYED OUT AS DIRECTED BY THE OWNER SHOWN AND AS APPROVED PER THE DOUGLAS COUNTY, OREGON PLANNING DEPARTMENT. NO FIELD SURVEYING WAS COMPLETED AND NO BOUNDARY WAS MARKED.

LEGEND:

LANDS NOT SURVEYED
DESCRIPTION BY ALIQUOT PARTS

WATER: SPRINGS
SEWER: SEPTIC SYSTEM
ZONING: EXCLUSIVE FARM USE
COMP. PLAN: AGG, FFT

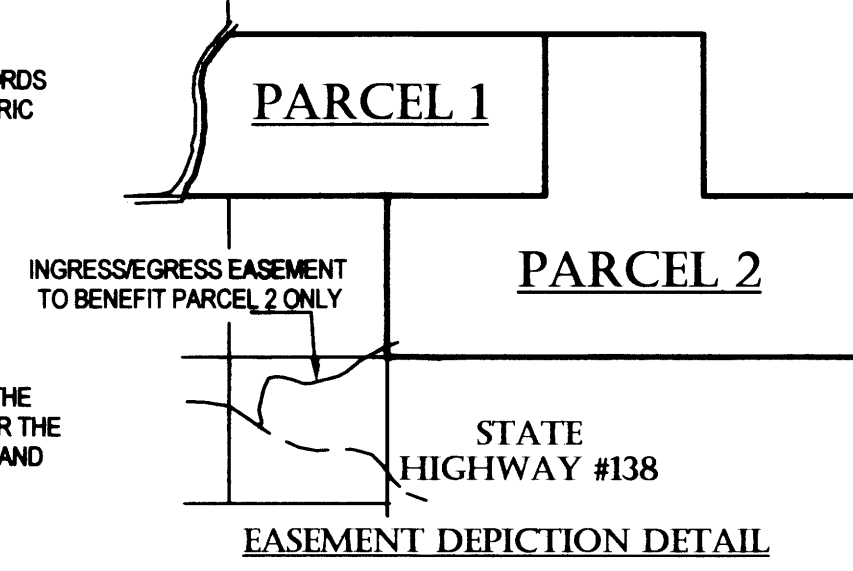

SURVEY FOR:
RICHARD A. PETERSEN
9666 GREEN VALLEY ROAD
OAKLAND, OREGON 97462

Sweeden Land Surveying
Carl A. Sweeden
P.L.S.
Conventional & Global Positioning
Surveying Systems
558 S. E. Jackson St., Roseburg, OR. 97470
Tel. 541-672-8344, Fax 541-672-1787

2014-0014