

2009-0003 B

PARTITION PLAT
LOCATED IN
SOUTHWEST QUARTER OF SECTION 35, TOWNSHIP 32 SOUTH
RANGE 6 WEST, WILLAMETTE MERIDIAN
DOUGLAS COUNTY, OREGON
NOVEMBER 5, 2007

SURVEYOR'S CERTIFICATE:

I RAYMOND W. WYTCHERLEY, OREGON PROFESSIONAL LAND SURVEYOR NO. 2724
HEREBY CERTIFY THAT I HAVE CORRECTLY SURVEYED AND MARKED WITH PROPER
MONUMENTS THE PARCELS OF LAND DESIGNATED AND REPRESENTED ON THIS
PARTITION PLAT. SAID PARCELS BEING DESCRIBED AS FOLLOWS:
BEGINNING AT THE INITIAL POINT SAID POINT BEARS N 89°40'35" W, 546.88 FEET FROM
THE SOUTH 1/4 CORNER OF SECTION 35 ONLY, TOWNSHIP 32 SOUTH, RANGE 6 WEST,
WILLAMETTE MERIDIAN, DOUGLAS COUNTY, OREGON; THENCE N 89°40'35" W, 608.11
FEET ALONG THE SOUTH LINE OF SAID SECTION 35; THENCE N 03°36'19" W, 386.70
FEET TO THE SOUTH RIGHT OF WAY OF TWIN PINES DRIVE; THENCE AROUND A
179.37 FT. RADIUS CURVE TO THE LEFT AN ARC DISTANCE OF 312.42 FEET THE CHORD
WHICH BEARS S 77°52'14" E, 274.40 FEET; THENCE S 37°46'04" E, 10.00 FEET; THENCE
AROUND A 189.37 FT. RADIUS CURVE TO THE LEFT AN ARC DISTANCE OF 160.97 FEET
THE CHORD WHICH BEARS N 27°52'55" E, 156.16 FEET; THENCE N 04°19'44" E, 92.78
FEET; THENCE N 86°08'14" W, 10.00 FEET; THENCE AROUND A 219.88 FT. RADIUS
CURVE TO THE RIGHT AN ARC DISTANCE OF 180.40 FEET THE CHORD WHICH BEARS N
27°22'02" E, 175.38 FEET; THENCE LEAVING SAID RIGHT OF WAY S 16°15'43" E, 740.41
FEET TO THE POINT OF BEGINNING.

Raymond W. Wytcherley
RAYMOND W. WYTCHERLEY R.L.S. 2724

DECLARATION:

KNOW ALL PERSONS BY THESE PRESENTS THAT CELESTE M. ALBEE IS
TRUSTEE OF THE CELESTE M. ALBEE TRUST FOR THE THE PROPERTY
DESCRIBED IN THE SURVEYORS CERTIFICATE. SHE HAS CAUSED THE SAME
TO BE PARTITIONED INTO PARCELS AS SHOWN ON THIS PARTITION PLAT
AND CREATES HEREON THE NEW SHARED WELL AND WATERLINE
EASEMENT AS SHOWN HEREIN.

Celeste M. Albee
CELESTE M. ALBEE

STATE OF OREGON, COUNTY OF DOUGLAS) S.S.

THIS IS TO CERTIFY THAT ON THIS 8 DAY OF January, 2009
BEFORE ME PERSONALLY APPEARED CELESTE M. ALBEE KNOWN TO ME TO BE THE
IDENTICAL PERSON DESCRIBED IN AND WHO EXECUTED THE ABOVE DECLARATION.
SHE ACKNOWLEDGES THE FOREGOING INSTRUMENT TO BE HER VOLUNTARY ACT
AND DEED.

Carmen Miles
NOTARY PUBLIC FOR OREGON (PRINTED NAME)
Carmen Miles
NOTARY PUBLIC FOR OREGON (SIGNATURE)
419789
COMMISSION NUMBER

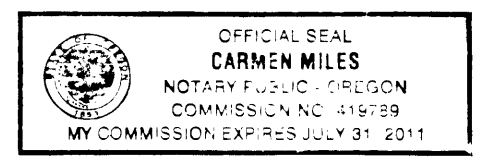

MY COMMISSION EXPIRES ON THE 31 DAY OF July, 2011

APPROVALS:

APPROVED BY THE UNDERSIGNED:

Romy W. THIS 16 DAY OF JANUARY, 2009
DOUGLAS COUNTY SURVEYOR OR DEPUTY

Cheryl A. Goodhue for THIS 15th DAY OF January, 2009
DOUGLAS COUNTY PLANNING DEPARTMENT, R.L.C.

ALL TAXES, FEES, ASSESSMENTS OR OTHER CHARGES AS PROVIDED BY O.R.S. 92.095
HAVE BEEN PAID THIS _____ DAY OF _____, 2009

Sandra K. Cornew 1/16/09
DOUGLAS COUNTY TAX COLLECTOR OR DEPUTY

STATE OF OREGON, } S.S.
COUNTY OF DOUGLAS

I HEREBY CERTIFY THAT THIS PARTITION PLAT WAS RECIEVED FOR RECORDING
ON THIS 16th DAY OF January, 2009 AT 9:54 O'CLOCK A M
AND RECORDED AS PARTITION PLAT NO. 2009-00739, OF THE OFFICIAL DOUGLAS
COUNTY RECORDS.

BARBARA E. NIELSEN
DOUGLAS COUNTY CLERK OR DEPUTY By Heidi Johnston
Deputy

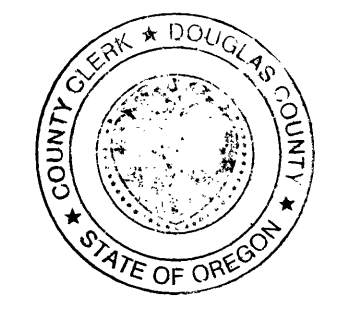

PLOTTED BY A HP DESIGNJET 500 ON
MILANO IMAGING # JPC4M2 POLYESTER
FILM WITH HP CARTRIDGE # 4844A.

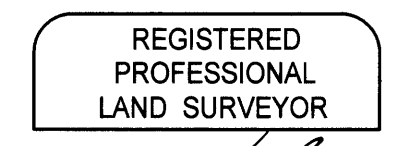

Raymond W. Wytcherley
OREGON
JULY 25, 1995
RAYMOND W. WYTCHERLEY
2724
EXPIRES JUNE 30, 2010

SURVEYED FOR:
CELESTE M. ALBEE
343 TWIN PINES DRIVE
GLENDALE, OR 97442

SURVEYED BY:
RAYMOND WYTCHERLEY
WYTCHERLEY SURVEYING
P.O. BOX 888
GLENDALE, OR 97442
541-832-3286
541-660-2648

2009-0003 B