

DOUGLAS COUNTY OFFICIAL RECORDS
 BARBARA E. NIELSEN, COUNTY CLERK 2007-020560
 NO FEE
 0019744720070020560020024
 09/20/2007 10:31:02 AM
 PLAT-PAR Cnt=1 Stn=1 RECEIPTCOUNTER
 This is a no fee document

LAND PARTITION

AS A RESULT OF A MEASURE 37 WAIVER
 For Douglas L & Nora M Croy
 in the SE 1/4 of SECTION 36., T28S., R08W., W.M.
 DOUGLAS COUNTY, OREGON
 AUGUST 2007

- LEGEND:**
- SET 5/8" x 30" IRON ROD WITH YELLOW PLASTIC CAP MARKED "AA SURVEYING INC."
 - FOUND 5/8" IRON ROD, UNLESS OTHERWISE NOTED
 - △ CALCULATED POINT

RECORD INFORMATION:
 () LAND PARTITION 2007-0012
 (()) MAP M83-20

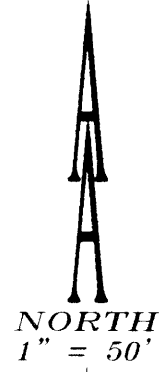

PARCEL 1
 LAND PARTITION
 2007-0012
 TAX LOT 2600
 DOUGLAS & NORA CROY

PARCEL 2
 LAND PARTITION
 2007-0012
 TAX LOT 2601
 DOUGLAS & NORA CROY

TAX LOT 2500
 DOUGLAS & NORA CROY

BASIS OF BEARINGS PER LAND PARTITION 2007-0012

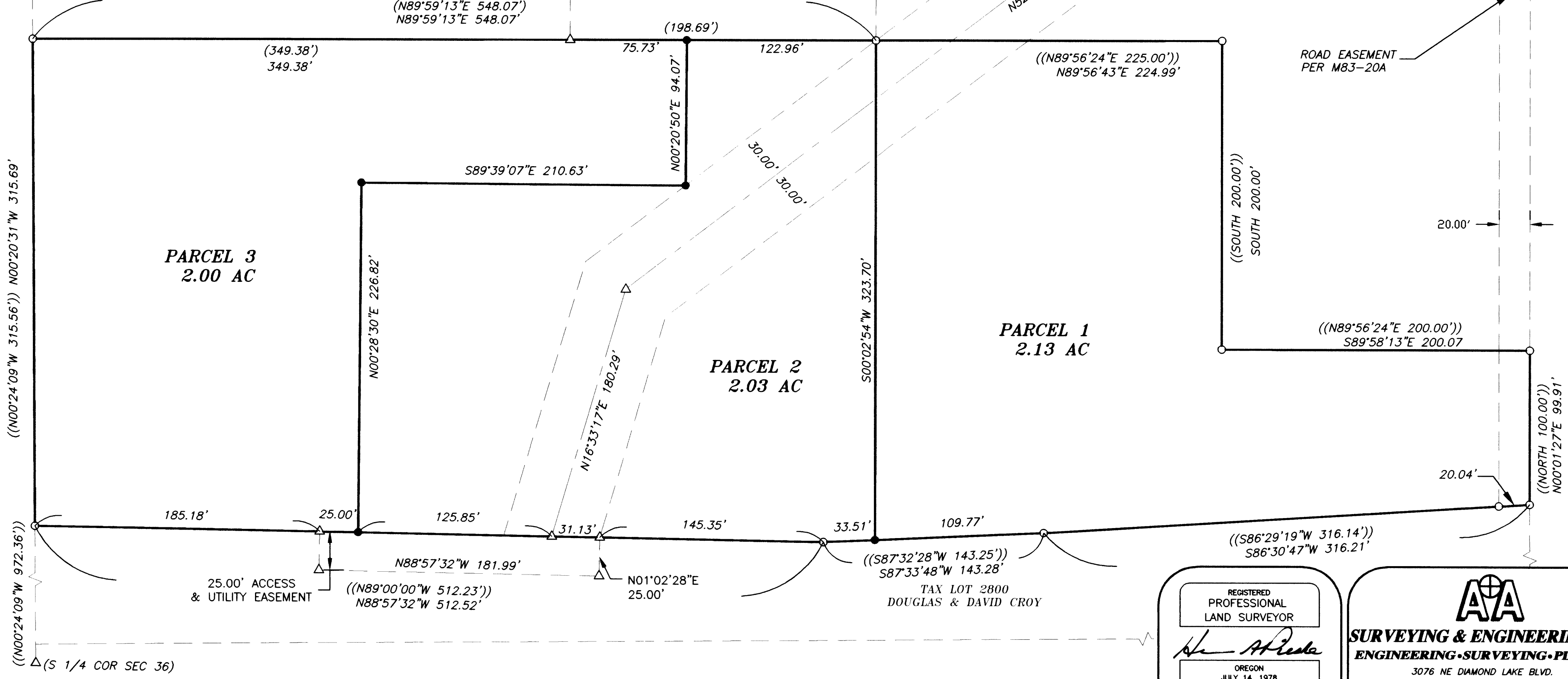

2007-0123 A

2007-0123 A

REGISTERED
 PROFESSIONAL
 LAND SURVEYOR

Herman A. Pieske

OREGON
 JULY 14, 1978
 HERMAN A. PIESKE
 1651
 EXP. DATE: 12-31-08

AA

SURVEYING & ENGINEERING, INC.
 ENGINEERING • SURVEYING • PLANNING

3076 NE DIAMOND LAKE BLVD.
 ROSEBURG, OREGON 97470
 TEL (541)672-2096
 FAX (541)672-0611

LAND PARTITION AS A RESULT OF A MEASURE 37 WAIVER
 For Douglas L & Nora M Croy
 in the SE 1/4 of SECTION 36., T28S., R08W., W.M.
 DOUGLAS COUNTY, OREGON
 AUGUST 2007

LEGAL OWNERS: DOUGLAS L. & NORA M. CROY
 PARTITIONER: 1197 LOCKWOOD RD
 ROSEBURG, OR 97470

WATER: WELL
 SEWER: SEPTIC
 ZONING: 5R
 NUMBER OF PARCELS: 3
 COMP. PLAN: COMMITTED RESIDENTIAL-5 ACRE
 PLANNING DEPT (MEASURE 37 RULING ALLOWS SMALLER PARCELS)
 FILE NO.: 05-280

SURVEYOR'S CERTIFICATE:
 I, HERMAN A. PIESKE, BEING DULY SWORN,
 DEPOSE AND SAY THAT THE BOUNDARIES OF
 THE PROPERTY ON THE ANNEXED PLAT ARE
 PROPERLY DESCRIBED AS:

PARCEL 3 OF LAND PARTITION M83-20,
 RECORDS OF DOUGLAS COUNTY, OREGON.

 HERMAN A. PIESKE

APPROVALS:
 9/17/07
 DOUGLAS COUNTY PLANNING DIRECTOR DATE

 9-17-07
 DOUGLAS COUNTY SURVEYOR DEPUTY DATE

I HEREBY CERTIFY THAT ALL TAXES AND SPECIAL ASSESSMENTS,
 OR OTHER CHARGES REQUIRED BY LAW, HAVE BEEN PAID.

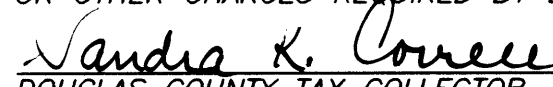
 9/19/07
 DOUGLAS COUNTY TAX COLLECTOR DATE

FILED THIS 20th DAY OF SEPTEMBER, 2007.

BARBARA E. NIE SS
 DOUGLAS COUNTY CLERK by  DEPUTY



VICINITY MAP

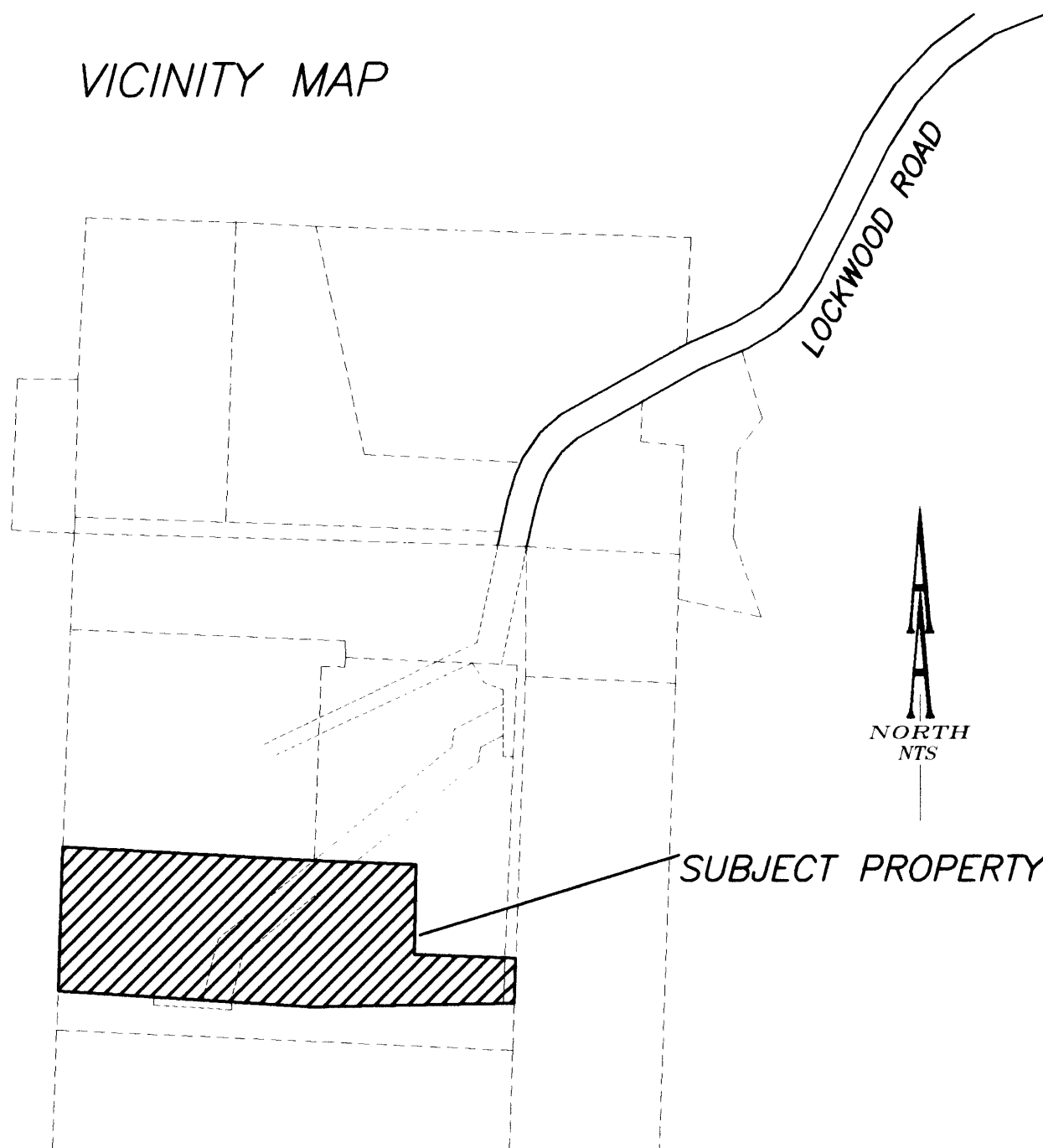

DECLARATION:

KNOW ALL PEOPLE BY THESE PRESENTS: THAT DOUGLAS L &
 NORA M. CROY, OWNERS OF THE LAND REPRESENTED ON THE
 ANNEXED MAP, AND MORE PARTICULARLY DESCRIBED IN THE
 ACCOMPANYING SURVEYOR'S CERTIFICATE, DO HEREBY DECLARE THE
 ANNEXED MAP TO BE A CORRECT MAP OF THE PARTITION PLAT OF
 SAID PROPERTY AND THAT THEY HAVE CAUSED THIS PARTITION
 PLAT TO BE PREPARED AND THE PROPERTY TO BE PARTITIONED
 INTO PARCELS AS SHOWN HEREON.

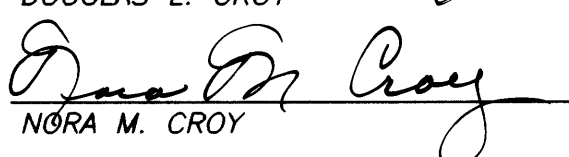
 DOUGLAS L. CROY

 NORA M. CROY

NARRATIVE:

THE PURPOSE OF THIS SURVEY IS TO
 PARTITION THE SUBJECT PROPERTY SHOWN
 HEREON. THE EXISTING CORNERS
 ESTABLISHING THE EXTERIOR BOUNDARY
 WERE FOUND AND HELD. THE PARCEL WAS
 THEN PARTITIONED AS SHOWN.

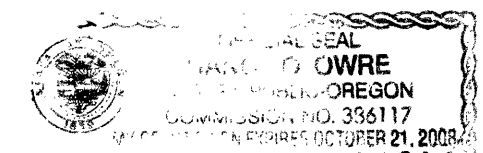
ACKNOWLEDGMENT:
 STATE OF OREGON)
) SS
 COUNTY OF DOUGLAS)



KNOW ALL PEOPLE BY THESE PRESENTS: THAT ON THIS
 17th DAY OF SEPTEMBER, 2007, BEFORE ME, A
 NOTARY PUBLIC IN AND FOR SAID STATE AND COUNTY, DID PERSONALLY
 APPEAR DOUGLAS L. & NORA M. CROY, WHO BEING DULY SWORN, DID
 SAY THAT THEY ARE THE IDENTICAL PERSONS NAMED IN THE FOREGOING
 INSTRUMENT AND THAT THEY EXECUTED SAID INSTRUMENT FREELY AND
 VOLUNTARILY.

 NOTARY PUBLIC, STATE OF OREGON

COMMISSION NUMBER: 306117

MY COMMISSION EXPIRES ON: OCTOBER 21, 2008

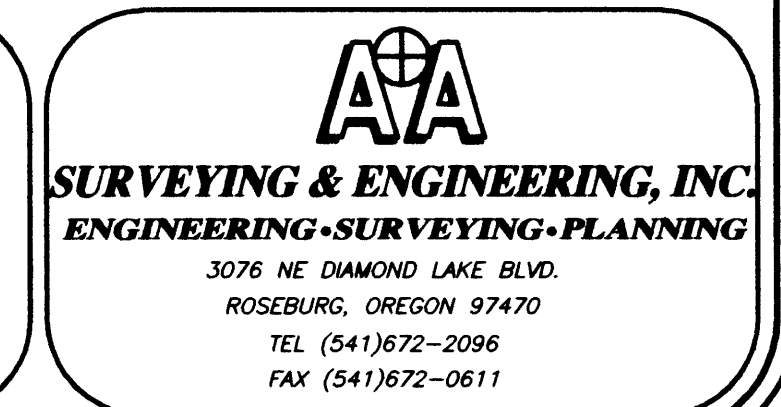
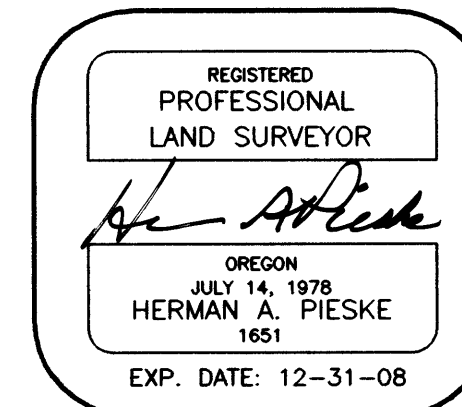

2007-0123 B

2007-0123 B