



FINAL PARTITION

LOCATED IN PORTIONS OF LOTS 4 & 9, SECTION 19, T.21S., R.IIW., WM.
& PORTIONS OF LOTS 3.4.5. & N1/2 SE1/4, SECTION 24, T.21S., R.12W., W.M.,
DOUGLAS COUNTY, OREGON

SURVEYORS CERTIFICATE:

I, TROY J. RAMBO, PROFESSIONAL LAND SURVEYOR OF OREGON #2865,
STATE THAT I HAVE CORRECTLY PREPARED THIS MAP AND MAKE NO
REPRESENTATION OF THE ACCURACY OF THE BOUNDARIES OF PARCELS
1 AND 2 OF THAT LAND SHOWN ON THE ANNEXED PLAT OF WHICH THE
FOLLOWING IS A TRUE AND CORRECT DESCRIPTION:

PARCEL II OF M99 - 78B

OWNER'S DECLARATION:

KNOW ALL MEN BY THESE PRESENT MIKE AND RACHEL A. MAST, ARE THE OWNER'S
OF THE LAND HEREON SHOWN AND REPRESENTED ON THE ATTACHED PAGE OF
THIS PLAT AND HAVE CAUSED THE SAME TO BE AND DIVIDED INTO
PARCELS AS HEREON SHOWN IN ACCORDANCE WITH O.R.S. CHAPTER 92.

MIKE MAST

Mike Mast 7-18-03
DATE

RACHEL A. MAST

Rachel A. Mast 7-18-03
DATE

STATE OF OREGON
COUNTY OF DOUGLAS SS

THIS IS TO CERTIFY THAT MIKE AND RACHEL A. MAST PERSONALLY
APPEARED BEFORE ME ON THIS 18th DAY OF JULY, 2003, WHO,
HAVE ACKNOWLEDGED THAT THEY HAVE SIGNED THE ABOVE OWNER'S
DECLARATION AS THEIR VOLUNTARY ACT AND DEED, IN TESTIMONY
WHEREOF I HAVE HEREUNTO SET MY SEAL THIS 18th DAY OF July 2003
2003. MY COMMISSION EXPIRES ON: January 10, 2005

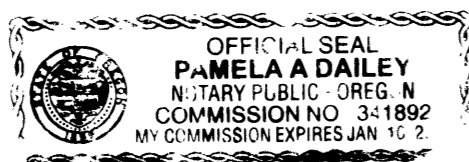

Pamela A. Dailey
NOTARY PUBLIC OF OREGON



PREPARED FOR:
MIKE AND RACHEL A. MAST
401 SUNNY RIDGE LANE
REEDSPORT, OR 97467

PREPARED BY:
MULKINS & RAMBO, LLC
P.O. BOX 809
NORTH BEND, OR 97459

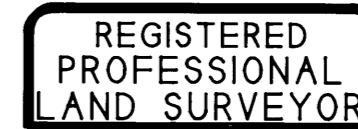

Troy Rambo
OREGON
JULY 14, 1998
TROY J. RAMBO
2865
RENEWAL 12-31-04

NARRATIVE

THE PURPOSE OF THIS SURVEY WAS TO PARTITION THE PARCEL OF LAND
DESCRIBED AS PARCEL 1 OF PER M99 - 78B.
THE DIMENSIONS SHOWN ARE BASED ON M99 - 78B AND ROAD CENTERLINE DATA
PROVIDED BY THE PUBLIC WORKS ENGINEERING & CONSTRUCTION DIVISION.
THE REMAINING EXTERIOR BOUNDARIES OF PARCEL 1 WERE NOT SURVEYED
BECAUSE IT EXCEEDS THE 10 ACRE MINIMUM. THE EAST BOUNDARY OF PARCEL 2
WAS NOT SURVEYED BECAUSE THIS LINE FALLS IN THE FLOOD PLAIN (PRESENTLY
A SWAMP) AND WITH THE COUNTY SURVEYOR'S APPROVAL. THE WEST BOUNDARY
OF PARCEL 2 WAS SURVEYED IN M99 - 78B.

ZONE: FF (FARM FOREST), FG (EXCLUSIVE FARM USE - GRAZING), EC (ESTURINE CONSERVATION)
COMP PLAN: FARM FOREST TRANSITIONAL, AGRICULTURE, AND ESTUARINE CONSERVATION
WATER: ON-SITE WELL
SEPTIC: ON-SITE SEPTIC

PLANNING DEPT. FILE NO. 02 - 168

APPROVALS:

Barndell W Smith 12-23-03
DOUGLAS COUNTY SURVEYOR DEPUTY DATE

I HEREBY CERTIFY THAT ALL TAXES AND SPECIAL ASSESSMENTS OR OTHER
CHARGES REQUIRED BY LAW HAVE BEEN PAID.

Sandra K. Conner 12/24/03
DOUGLAS COUNTY TAX COLLECTOR DATE

FILED THIS 24th DAY OF December, 2003, 11:28 O'CLOCK AM
2003-034347

Barbara E. Nielsen 12-24-03
DOUGLAS COUNTY CLERK By: Gloria A. Barnett DEPUTY DATE

Keith L. Cubie 12/23/03
DOUGLAS COUNTY PLANNING DEPARTMENT
PLANNING DIRECTOR DATE

2003-0089 B

2003-0089 B