

NARRATIVE

The survey was done for the purpose of partitioning the property as shown hereon. Several surveys of record at the Douglas County Surveyor's Office were relied upon as follows:

Ref. No. (R)	Map File No.	Surveyor	Date
1	M 128-3	Rogers	1997
2	Valley View Mobile Home Estates, Vol. 14, page 12	Martin	1971

The survey was done in July, 1999, using a Jena 0°00'01" theodolite and a Mac II electronic distance meter.

PROPERTY DESCRIPTION:

The southerly one hundred feet of both Lots 4 & 5 of Valley View Mobile Home Estates, a subdivision in the SW 1/4 of Section 8, T30S, R5W, W.M., Douglas County, Oregon and further described by Instrument No. 98-06142, Deed Records of Douglas County, Oregon. The above has been partitioned into Parcels 1 & 2, as shown on page 1 of this partition.

SURVEYOR'S CERTIFICATE:

I, Bruce A. Shaner, being duly sworn, here depose and say that I have correctly surveyed and marked with proper monuments the land shown hereon, the boundaries of which are described hereon.

Bruce A Shaner
Bruce A. Shaner, RLS 430

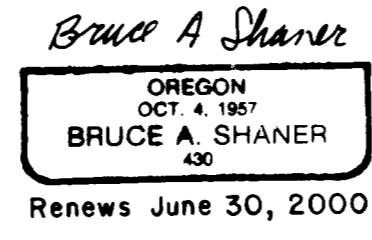
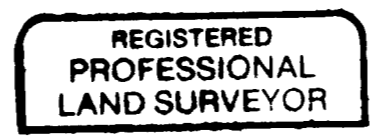

DECLARATION:

Know all people by these presents that Edward C. Heze & Judith A. Heze are the owners of the land represented hereon and more particularly described herein and have caused the same to be surveyed and platted into parcels together with easements as shown hereon.

Edward C. Heze
Edward C. Heze
Judith A. Heze
Judith A. Heze

COMP. PLAN: Medium density residential (RMD)
ZONE: Single family residential (R-1)
WATER & SEWER: Tri-City Water & Sanitary District
PLANNING DEPT. FILE NO: 99-111

State of Oregon) SS
County of Douglas) ACKNOWLEDGEMENT
Know all people by these presents that on this 2nd day of AUGUST, 1999, before me, a Notary Public in and for said State and County, personally appeared Edward C. & Judith A. Heze, who being duly sworn, did say that they are the owners and that they executed the land partition freely and voluntarily.

Clement W. Berlier

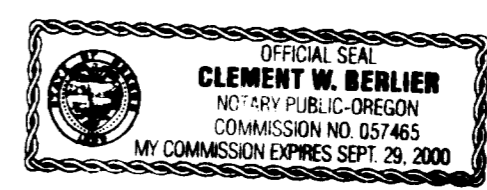

APPROVALS:

Keith L. Cubic 8/23/99
Douglas County Planning Director Date

Ed Monahan 8-23-99
Douglas County Surveyor DEPUTY Date

I hereby certify that all taxes and special assessments or other charges required by law have been paid.

Paul Nuzumbar 8/23/99
Douglas County Tax Collector Date

Filed this 24th day of August, 1999, 8:24 o'clock am pm

DOYLE SHAVER JR. 8-24-99
Douglas County Clerk Date
by Carol Engel, Deputy

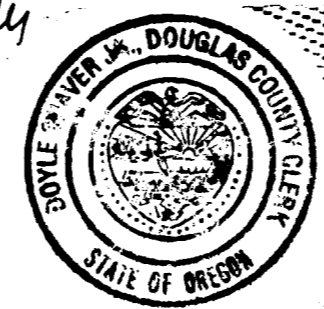

STATE OF OREGON) 98
COUNTY OF DOUGLAS)
I, DOYLE SHAVER JR., COUNTY CLERK AND
RECORDER OF CONVEYANCES, DO HEREBY CERTIFY
THAT THIS INSTRUMENT WAS RECORDED
99 AUG 24 AM 8:24
DOYLE SHAVER JR.
DOUGLAS COUNTY CLERK
IN THE OFFICIAL RECORDS OF DOUGLAS COUNTY
BY Carol Engel
REC pp

PARTITION OF A PORTION OF LOTS 4 & 5, VALLEY VIEW MOBILE HOME ESTATES IN THE SW 1/4 OF SECTION 8, T30S, R5W, W.M., DOUGLAS COUNTY, OREGON

For: Edward C. & Judith A. Heze
525 Gael Lane
Myrtle Creek, Oregon 97457

By: Shaner Engineering, Inc.
P.O. Box 1430
Roseburg, Oregon 97470

99-21558