

Comp. Plan (FFT) Farm Forest Transitional
& Public/Semi Public
Zone: (FG) Exclusive Farm Use - Grazing
(FF) Farm Forest
(WI) Water Impoundment
Water: Well on Parcel No. 2, with easement to
Parcel No. 1.
Sewer: On site drainfields
Planning Dept.
File No. 98-120

DECLARATION:

Know all people by these presents that Ken Sorenson Logging, Inc. is the owner of the land represented hereon and more particularly described herein and has caused the same to be surveyed and platted into parcels together with easements as shown hereon.

Keneth M. Sorenson
Ken Sorenson, President

ACKNOWLEDGEMENT:

State of Oregon) SS
County of Douglas)

Know all people by these presents, that on this 29 day of July, 1998, before me, a Notary Public in and for said State and County, personally appeared Ken Sorenson, who being duly sworn, did say that he is the President of Ken Sorenson Logging, Inc. and that he executed the Land Partition on behalf of said Corporation freely and voluntarily.

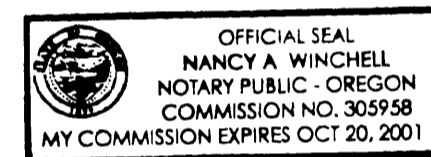

Nancy A. Winchell

NARRATIVE:

The purpose of this plat is to partition the property represented by Instrument Number 90-05417 into two parcels as shown hereon. The parcels were not physically surveyed since they exceed the 10 acre minimum required for same.

SURVEYOR'S CERTIFICATE:

I, Bruce A. Shaner, being duly sworn, depose and say that I have not surveyed, but have correctly prepared the land partition shown on this Plat. I make no representation as to the accuracy of the boundaries of said partition, however the following is a true and correct description:

That property described by Instrument Number 90-05417 as recorded in the Deed Records of Douglas County, Oregon, lying in Sections 33 & 34, Township 23 South, Range 4 West, W.M., Douglas County, Oregon.

Bruce A. Shaner
Bruce-A. Shaner, PLS 430

APPROVALS:

Keith L. Cubic 8/12/98
Douglas County Planning Director Date

Ed Monson 8-14-98
Douglas County Surveyor DEPUTY Date

I hereby certify that all taxes and special assessments or other charges required by law have been paid.

Anne E. Schroeder, Deputy 9-30-98
Douglas County Tax Collector Date

98-22758

Filed this 1st day of OCTOBER, 1998, 8:15 o'clock am pm

Doyle Shaver Jr., County Clerk
Douglas County Clerk BY: DEPUTY

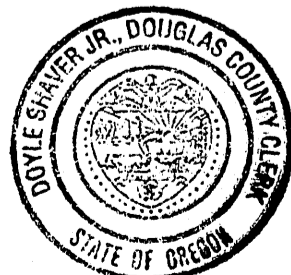

98-22758

LAND PARTITION
in the E 1/2 of Section 33 and the NW 1/4 of Section 34,
T23S, R4W, W.M., Douglas County, Oregon

For: Ken Sorenson Logging, Inc.
201 Bamboo Lane
Roseburg, Oregon 97470

By: Shaner Engineering, Inc.
P.O. Box 1430
Roseburg, Oregon 97470

July 27, 1998

98-22758

Page 2 of 2

98-22758

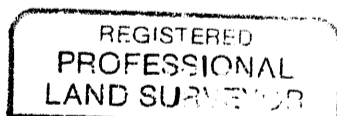

Bruce A. Shaner
OREGON
OCT. 4, 1957
BRUCE A. SHANER
430
Renews June 30, 2000

STATE OF OREGON 1 SS
COUNTY OF DOUGLAS 1
I, DOYLE SHAVER JR., COUNTY CLERK AND
RECORDER OF CONVEYANCES, DO HEREBY CERTIFY
THAT THIS INSTRUMENT WAS RECORDED

98 OCT -1 AM 8:15

DOYLE SHAVER JR.
DOUGLAS COUNTY CLERK

IN THE OFFICIAL RECORDS OF DOUGLAS COUNTY

BY: Doyle Shaver Jr.
DEPUTY

FEE PP