

1997 - 0106 B

# LAND PARTITION

DOUGLAS COUNTY PLANNING  
DEPARTMENT FILE NUMBER 96-130.

Located in the:  
WEST 1/2, SECTION 20,  
TOWNSHIP 32 SOUTH, RANGE 5 WEST  
WILLAMETTE MERIDIAN, DOUGLAS COUNTY, OREGON

LEGAL OWNER OF RECORD AND PARTITIONER:  
STEVEN L. BROWN  
P. O. BOX 364  
CANYONVILLE, OR. 97417  
Phone: (541) 839 - 6167

TOTAL NUMBER OF PARCELS: THREE (3)  
WATER SUPPLY: WELLS & EASEMENTS  
SEWAGE DISPOSAL: SEPTIC  
ZONING: RR - 2 ACRE  
COMPREHENSIVE PLAN DESIGNATION: RC2

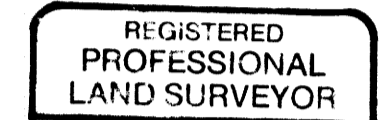

MAP PREPARED BY:  
RAYMOND F. BROWN - P.L.S. # 2391  
P. O. BOX 539  
CANYONVILLE, OREGON 97417  
PHONE: (541) 839 - 6185

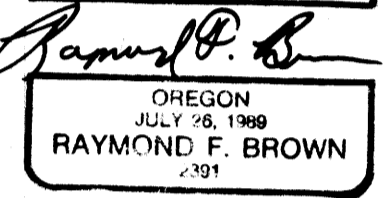

EXP. 12/31/97

### DECLARATION:

I, STEVEN L. BROWN, BEING FIRST DULY SWORN, DEPOSE AND SAY THAT I HAVE CAUSED THE LANDS DEPICTED HEREON TO BE SURVEYED AND THE EASEMENTS SHOWN HEREON TO BE CREATED AS SET FORTH, OF MY OWN FREE WILL.

Steven L. Brown      9-26-97  
STEVEN L. BROWN      DATE

### ACKNOWLEDGEMENT:

PERSONALLY APPEARED THE ABOVE NAMED STEVEN L. BROWN, AND ACKNOWLEDGED THE FOREGOING DECLARATION TO BE A VOLUNTARY AND FREE ACT.

Jean H Crawford  
NOTARY PUBLIC  
MY COMMISSION EXPIRES 4-17-98

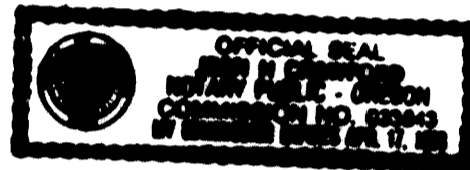

### APPROVALS:

Keith L. Cubie      October 9, 1997  
DOUGLAS COUNTY PLANNING DEPARTMENT      DATE  
DIRECTOR

Ed Mann      OCTOBER 9, 1997  
DOUGLAS COUNTY SURVEYOR'S OFFICE      DATE  
DEPUTY

### CERTIFICATION OF TAX PREPAYMENT:

I, HEREBY CERTIFY THAT ALL TAXES AND SPECIAL ASSESSMENTS OR OTHER CHARGES REQUIRED BY LAW HAVE BEEN PAID.

Vickey Tanferan, deputy      10-9-97  
DOUGLAS COUNTY TAX COLLECTOR      DATE

### NARRATIVE:

PURPOSE OF THE SURVEY WAS TO CREATE THE PARCELS AS SHOWN. FIELD INVESTIGATION LOCATED THE SAID FOUND MONUMENTS AND CONDITIONS. EXISTING MONUMENTS ON THE EXTERIOR BOUNDARY OF THE PARTITIONED LAND AS RECORDED BY A 1994 LAND PARTITION, DOUGLAS COUNTY SURVEYOR'S OFFICE FILE NUMBER 1994-0046, CONTROLLED THE SAID EXTERIOR BOUNDARIES.

1997 - 0106 B