

# LAND PARTITION

IN THE SW 1/4 OF SEC. 15, THE SE 1/4 OF SEC. 16, THE EAST  
1/2 OF SEC. 21, THE SOUTH 1/2 OF SEC. 23, AND SEC. 22  
TOWNSHIP 24 SOUTH, RANGE 6 WEST, WM  
DOUGLAS COUNTY, OREGON  
JANUARY, 1997  
SHEET 1 OF 2

PLANNING DEPARTMENT FILE NO. 96-278.

### NARRATIVE

THE PURPOSE OF THIS PLAT IS TO PARTITION THE LANDS OF LEININGER AS SHOWN. THE PARTITION LINES FOLLOW EXISTING RIGHT-OF-WAY LINES. RIGHT-OF-WAY LINES WERE SCALED FROM ASSESSOR MAPS. THIS PROPERTY WAS NOT SURVEYED FOR THIS PARTITION.

### OWNER AND PARTITIONER

KATHRYN L. LEININGER  
1 PENROSE BLVD.  
COLORADO SPRINGS, COLORADO 80906

### DECLARATION

KNOW ALL PEOPLE BY THESE PRESENTS THAT KATHRYN L. LEININGER IS THE OWNER OF THE LAND REPRESENTED ON THE PARTITION PLAT, AND MORE PARTICULARLY DESCRIBED HEREIN HAS CAUSED THE SAME TO BE PARTITIONED AND NOT SURVEYED INTO PARCELS IN ACCORDANCE WITH ORS 92, AND ALL PRIVATE EASEMENTS CREATED AS SHOWN HEREON.

*Kathryn L. Leininger* 2/19/97  
KATHRYN L. LEININGER DATE

### ACKNOWLEDGEMENT

STATE OF COLORADO }  
COUNTY OF EL PASO } ss

KNOW ALL PEOPLE BY THESE PRESENTS, ON THIS 19<sup>th</sup> DAY OF Feb., 1997 BEFORE ME A NOTARY PUBLIC IN AND FOR SAID STATE AND COUNTY, PERSONALLY APPEARED KATHRYN L. LEININGER, WHOM BEING DULY SWORN DID SAY THAT SHE IS THE IDENTICAL PERSON NAMED IN THE FOREGOING INSTRUMENT AND THAT SHE EXECUTED SAID INSTRUMENT FREELY AND VOLUNTARILY.

*Nancy C. Morgan* my commission expires Jan. 31, 1998

### DESCRIPTION

THAT PROPERTY DESCRIBED IN INSTRUMENT NUMBER 94-25584 AS RECORDED IN DOUGLAS COUNTY OREGON DEED RECORDS.

### ALL PARCELS

WATER: WELL  
SEWER: SEPTIC  
ZONING: FG  
COMP. PLAN: AGG, FFT

### APPROVALS

*Keith L. Cubic* 3/14/97  
DOUGLAS COUNTY PLANNING DIRECTOR DATE

*Ed Morrison* 3-14-97  
DOUGLAS COUNTY SURVEYOR DEPUTY DATE

I HEREBY CERTIFY THAT ALL TAXES AND SPECIAL ASSESSMENTS OR OTHER CHARGES REQUIRED BY LAW HAVE BEEN PAID.

*Anne E. Schroeder* 3/14/97  
DOUGLAS COUNTY TAX COLLECTOR DATE

FILED THIS 17 DAY OF March 19 97 at 8:35 AM  
DOUGLAS COUNTY CLERK by *Carol Cray*, Deputy

97-05607

### SURVEYOR'S CERTIFICATE

I, DAVID J. COLLIER, BEING DULY SWORN DEPOSE AND SAY THAT I HAVE NOT SURVEYED OR MARKED WITH MONUMENTS THE LANDS SHOWN HEREON.

*David J. Collier*  
DAVID J. COLLIER

STATE OF OREGON }  
COUNTY OF DOUGLAS } ss.  
I, \_\_\_\_\_, COUNTY CLERK AND RECORDER OF CONVEYANCES, DO HEREBY CERTIFY THAT THIS INSTRUMENT WAS RECORDED

97 MAR 17 AM 8:35

*Carol Cray* JR.  
DOUGLAS COUNTY CLERK

IN THE OFFICIAL RECORDS OF DOUGLAS COUNTY

BY *Carol Cray* DEPUTY  
FEE PP

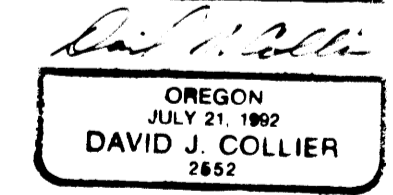
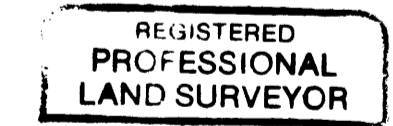
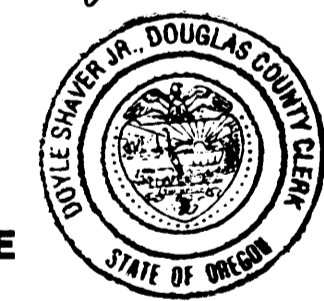

RENEWAL: 12-31-97

**EGR & Associates, Inc.**  
ENGINEERS, GEOLOGISTS AND SURVEYORS  
2545K PRAIRIE ROAD (541) 688-8322  
EUGENE, OREGON 97402 FAX (541) 688-8087