

LAND PARTITION  
LOT 5, BLOCK 2, THREE PINES  
SW 1/4 OF SECTION 17  
TOWNSHIP 27 SOUTH, RANGE 5 WEST OF THE WILLAMETTE MERIDIAN  
DOUGLAS COUNTY, OREGON  
NOVEMBER 11, 1996

NARRATIVE

The purpose of this survey was to monument the boundary of the property described as Lot 5.

The monuments shown were used to control the boundary and the subject property was partitioned per Preliminary Partition Plan as recorded in Douglas County Planning Department File Number 96-10.

SURVEYOR'S CERTIFICATE

I, Ronald A. Quimby, being duly sworn, depose and say that I have surveyed and monumented with proper monuments the corners so indicated on the annexed plat and that the boundaries are properly described as follows:

A portion of Lot 5, Block 2, Three Pines, more particularly described as follows:

Beginning at a 5/8 inch iron rod on the South line of Lot 6, Block 2, Three Pines, being South 88°45'57" West 10.00 feet from the Southeast corner of said Lot 6;

Thence South 01°34'56" East 130.03 feet to a 5/8" iron rod on the North line of Lot 4, Block 2, Three Pines;

Thence South 88°26'14" West 282.15 feet, along said North line to the center of an unnamed creek, being also the Northwest corner of Lot 4, Block 2, Three Pines;

Thence North 15°17'13" East 91.24 feet, along the centerline of said unnamed creek to a point;

Thence North 42°46'52" East 61.43 feet, along the centerline of said unnamed creek to the Southwest corner of Lot 6, Block 2, Three Pines;

Thence North 88°45'57" East 212.71 feet, along the South line of said Lot 6, to the Point of Beginning.

All situate in Section 17, Township 27 South, Range 5 West of the Willamette Meridian, Douglas County, Oregon.

DECLARATION

KNOW ALL PEOPLE BY THESE PRESENTS: that Jeff and Patricia Lewis, husband and wife,

owners of the land represented on the annexed map, and more particularly described in the accompanying Surveyor's Certificate, do hereby declare the annexed map to be a correct map of the partition plat of said property and that they have caused this partition plat to be prepared and the property to be partitioned into three parcels as shown hereon, in accordance with the provisions of chapter 92 of Oregon Revised Statutes. Said owners do hereby dedicate a 25 foot access and utility easement, as shown hereon, for the benefit of Parcel 3.

*Jeff Lewis*  
Jeff Lewis  
*Patricia Lewis*  
Patricia Lewis

ACKNOWLEDGEMENT:

State of Oregon )  
County of Douglas ) SS

KNOW ALL PEOPLE BY THESE PRESENTS: that on this 11th day of January 1997, before me a Notary Public in and for said State and County, did personally appear Jeff and Patricia Lewis, husband and wife, who being duly sworn, did say that they are the identical persons named in the foregoing instrument and they executed said instrument freely and voluntarily.

*Carole M. Cody*  
Notary Public, State of Oregon  
My commission expires on July 19, 1999

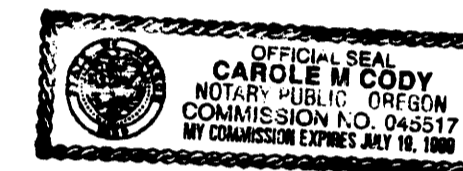

APPROVALS:  
*Ronald A. Quimby* 12-31-96  
Community Development Director Date  
City of Roseburg, Oregon  
*Chris Berg* 12/30/96  
Public Works Director, City of Roseburg Date

*Larry E. Morrison*  
Douglas County Surveyor Date JAN. 15, 1997 DEPUTY

I hereby certify that all taxes and special assessments or other charges required by law, have been paid.

Approved: 1-16, 1997  
By *Vickie Inaferran* deputy  
Douglas County Tax Collector

Filed this 16th day of January, 1997 at 2:51 PM  
DOYLE SHAVER JR., County Clerk  
Douglas County Clerk by *Carol Kneel* Deputy



STATE OF OREGON )  
COUNTY OF DOUGLAS ) SS.  
I, *Carol Kneel*, COUNTY CLERK AND RECORDER OF CONVEYANCES, DO HEREBY CERTIFY THAT THIS INSTRUMENT WAS RECORDED  
97 JAN 16 PM 2:51  
DOYLE SHAVER JR.  
DOUGLAS COUNTY CLERK

IN THE OFFICIAL RECORDS OF DOUGLAS COUNTY  
BY *Carol Kneel*  
97-00937 DEPUTY REC. PP

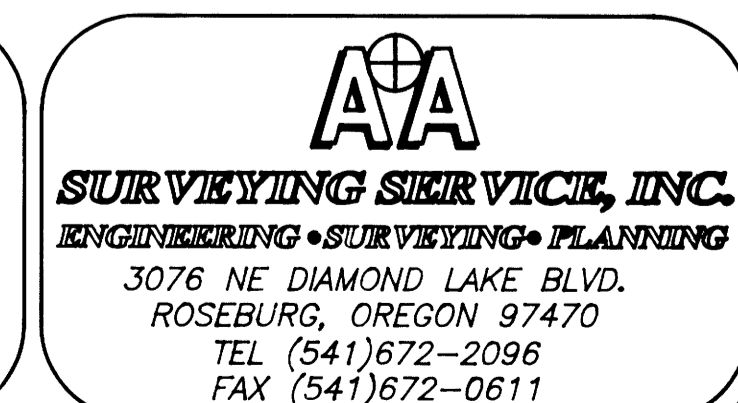
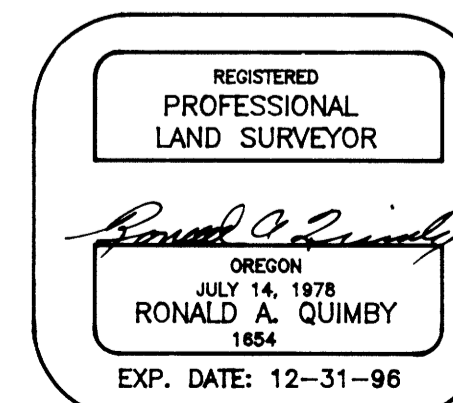

1997-0011B

1997 - 0011B