

**PARTITION PLAT FOR
TRANSITION INCORPORATED AND
ROSEBURG FOREST PRODUCTS, INCORPORATED.
LOCATED IN THE FOLLOWING SECTIONS:
W 1/2 5, 6, 8, 17, E 1/2 19, AND W 1/2 20
TOWNSHIP 24 SOUTH, RANGE 4 WEST, W.M.
DOUGLAS COUNTY, OREGON
DECEMBER 16, 1996**

SURVEYOR'S CERTIFICATE

I, HARVEY M. CHRISTENSEN, CERTIFY THAT:

- (1) I HAVE NOT SURVEYED THE LAND PARTITION SHOWN ON THIS PLAT, AND
- (2) I HAVE CORRECTLY PREPARED THE LAND PARTITION SHOWN ON THIS PLAT OF WHICH THE FOLLOWING IS A TRUE AND CORRECT DESCRIPTION:

BEGINNING AT THE NORTHWEST SECTION CORNER OF SECTION 5, T24S, R4W, W.M. COUNTY OF DOUGLAS, STATE OF OREGON, SAID POINT BEING THE 'INITIAL POINT' FOR THIS PLAT AND THE TRUE POINT OF BEGINNING OF THIS DESCRIPTION:

THENCE EASTERLY ALONG THE NORTH SECTION LINE OF SAID SECTION 5 TO THE NORTH 1/4 CORNER OF SAID SECTION 5;
 THENCE SOUTHERLY ALONG THE NORTH-SOUTH CENTERLINE TO THE QUARTER CORNER COMMON TO SECTION 5 AND 8;
 THENCE EASTERLY ALONG THE SECTION LINE COMMON TO SECTION 5 AND 8 TO THE SECTION CORNER COMMON TO SECTIONS 5-4/8-9;
 THENCE SOUTHERLY ALONG THE SECTION LINE COMMON TO SAID SECTION 8 AND 9 TO THE SECTION CORNER COMMON TO SECTIONS 8-9/17-16;
 THENCE CONTINUING SOUTHERLY ALONG THE SECTION LINE TO THE QUARTER CORNER COMMON TO SECTIONS 17 AND 16;
 THENCE WESTERLY ALONG THE EAST-WEST CENTERLINE OF SECTION 17 TO THE NORTH-NORTHEAST CORNER OF DONATION LAND CLAIM NO. 40;
 THENCE CONTINUING WESTERLY ALONG THE EAST-WEST CENTERLINE OF SECTION 17 TO A POINT DUE NORTH OF THE NORTHWEST CORNER OF DONATION LAND CLAIM NO. 47;
 THENCE SOUTHERLY TO THE NORTHWEST CORNER OF DONATION LAND CLAIM NO. 47;
 THENCE SOUTH 0°01'36" WEST, 291.45 FEET TO A 1 1/8 INCH IRON ROD ON THE WESTERLY LINE OF SAID DONATION LAND CLAIM NO. 47;
 THENCE WEST, 2050.00 FEET TO AN 5/8 INCH IRON PIPE;
 THENCE SOUTH 0°01'36" WEST, 1461.88 FEET TO A 1 1/8 INCH IRON ROD;
 THENCE EAST 690.08 +/- FEET TO A POINT ON THE SOUTH LINE OF THAT PROPERTY DEEDED TO LEON C. YOUNG ET UX
 IN BOOK 790, PAGE 181 DOUGLAS COUNTY DEEDS AND RECORDS NO. 81-06742, SAID POINT BEING WEST 1359.92 FEET FROM WEST LINE OF SAID DONATION LAND NO. 47);
 THENCE SOUTH 07°26'20" EAST 118.95 FEET TO A POINT; THENCE SOUTH 11°11'22" WEST 407.83 FEET TO A POINT;
 THENCE SOUTH 02°45'42" EAST 668.89 FEET TO A POINT; THENCE SOUTH 21°55'16" WEST 1726.21 FEET TO A POINT;
 THENCE SOUTH 08°29'16" WEST 923.65 FEET TO A POINT; THENCE SOUTH 16°53'58" EAST 891.26 +/- FEET TO A POINT ON THE NORTHERLY RIGHT-OF-WAY LINE OF COUNTY ROAD NO. 22 (DRIVER VALLEY ROAD);
 THENCE SOUTHWESTERLY ALONG SAID NORTHERLY RIGHT-OF-WAY LINE OF SAID COUNTY ROAD #22 IN SECTION 20 TO THE SOUTHWEST CORNER OF SAID SECTION 20;
 THENCE WESTERLY ALONG THE SECTION LINE COMMON TO SECTIONS 19 AND 30 TO THE EAST-EAST ONE SIXTY-FOURTH CORNER OF SAID SECTIONS 19 AND 30;
 THENCE NORTHERLY TO THE SOUTHEAST-SOUTHEAST ONE SIXTY-FOURTH CORNER OF SECTION 19;
 THENCE WESTERLY TO THE CENTER-SOUTH-SOUTHEAST ONE SIXTY-FOURTH CORNER OF SAID SECTION 19;
 THENCE CONTINUING WESTERLY TO THE SOUTHWEST-SOUTHEAST ONE SIXTY-FOURTH CORNER OF SAID SECTION 19;
 THENCE SOUTHERLY TO THE WEST-EAST ONE SIXTY-FOURTH CORNER OF SECTIONS 19 AND 30;
 THENCE WESTERLY ALONG THE SECTION LINE COMMON TO SECTIONS 19 AND 30 TO THE QUARTER CORNER COMMON TO SAID SECTIONS 19 AND 30;
 THENCE NORTHERLY ALONG THE NORTH-SOUTH CENTERLINE OF SECTION 19 TO THE CENTER-NORTH SIXTEENTH CORNER OF SAID SECTION 19;
 THENCE EASTERLY TO THE NORTH SIXTEENTH CORNER COMMON TO SECTIONS 19 AND 20;
 THENCE NORTHERLY ALONG THE SECTION LINE COMMON TO SECTIONS 19 AND 20 TO THE SECTION CORNER OF SECTIONS 18-17/19-20;
 THENCE CONTINUING NORTHERLY ALONG THE SECTION LINE COMMON TO SECTIONS 18 AND 17 TO THE SECTION CORNER COMMON TO SECTIONS 7-8/18-17);
 THENCE NORTHERLY ALONG THE SECTION LINE COMMON TO SECTIONS 7 AND 8 TO THE SOUTH-SOUTH ONE SIXTY-FOURTH CORNER COMMON TO SAID SECTIONS 7-8);
 THENCE CONTINUING NORTHERLY ALONG THE SECTION LINE COMMON TO SECTIONS 7 AND 8 TO A POINT THAT INTERSECTS AN EXISTING FENCE LINE; THENCE IN A CARDINAL DIRECTION TO A POINT AT AN EXISTING FENCE CORNER, SAID POINT LAYS SOUTH 89°16'47" EAST, 2273.33 FEET MORE OR LESS FROM A POINT ON THE EASTERLY RIGHT-OF-WAY OF THE MEDLEY ELKHEAD ROAD (COUNTY ROAD #50);
 THENCE NORTH 6°27'47" EAST, 634.24 FEET TO AN EXISTING FENCE CORNER;
 THENCE NORTH 88°59'18" EAST, 652.59 FEET ALONG AN EXISTING FENCE TO AN EXISTING FENCE CORNER;
 THENCE NORTH 0°32'57" EAST, 1307.36 FEET ALONG AN EXISTING FENCE TO AN EXISTING FENCE CORNER;
 THENCE SOUTH 89°19'06" EAST, 646.62 FEET ALONG AN EXISTING FENCE TO AN EXISTING FENCE CORNER;
 THENCE NORTH 0°23'29" EAST, 2059.13 FEET ALONG AN EXISTING FENCE TO A 5/8" IRON PIN, SAID PIN BEARS EAST 2490.68 FEET FROM A 5/8" IRON PIN SET 20.0 +/- FEET FROM THE EASTERLY RIGHT-OF-WAY LINE OF SAID COUNTY ROAD # 50;
 THENCE CONTINUING NORTH 0°23'29" EAST, 598.71 FEET ALONG AN EXISTING FENCE TO AN EXISTING FENCE CORNER;
 THENCE WEST 480.00 FEET TO A 5/8" IRON PIN;
 THENCE NORTH 771.24 FEET TO A 5/8" IRON PIN;
 THENCE WEST 851.86 FEET TO A POINT THAT BEARS NORTH 0°43'00" EAST 789.11 FEET FROM THE SECTION CORNER COMMON TO SECTIONS 6-5/7-8;
 THENCE CONTINUING WEST 2134.92 FEET TO A 5/8" IRON PIN;
 THENCE CONTINUING WEST 20.00 FEET MORE OR LESS TO THE EASTERLY RIGHT-OF-WAY LINE OF SAID COUNTY ROAD #50;
 THENCE NORTHERLY ALONG SAID EASTERLY RIGHT-OF-WAY LINE OF SAID COUNTY ROAD # 50 IN SECTION 6 TO THE EASTWEST CENTERLINE OF SAID SECTION 6);
 THENCE EASTERLY ALONG THE EASTWEST CENTERLINE OF SAID SECTION 6 TO THE CENTER QUARTER CORNER OF SAID SECTION 6);
 THENCE EASTERLY ALONG THE EASTWEST CENTERLINE OF SAID SECTION 6 TO THE CENTER-EAST SIXTEENTH CORNER OF SAID SECTION 6);
 THENCE NORTHERLY TO THE EAST 1/16 CORNER OF SAID SECTION 6);
 THENCE EASTERLY ALONG THE NORTH SECTION LINE OF SECTION 6 TO THE TRUE POINT OF BEGINNING.

NARRATIVE

THE PURPOSE OF THIS SURVEY WAS TO PARTITION THE SUBJECT PROPERTY AS DESCRIBED IN BOOK 1298, PAGES 870 & 871 (EXCLUDING PARCEL #3 OF PARCEL "B") AND EXCEPTING THOSE PROPERTIES AS DESCRIBED IN BOOK 1413, PAGES 982 & 985, AND BOOK 1423, PAGE 939 OF DOUGLAS COUNTY DEEDS AND RECORDS, INTO THREE PARCELS.
 NO FIELD SURVEY WAS MADE FOR THE PREPARATION OF THIS MAP.

DECLARATION

KNOW ALL PEOPLE BY THESE PRESENTS THAT TRANSITION INCORPORATED AND ROSEBURG FOREST PRODUCTS ARE THE OWNERS OF THE LAND REPRESENTED ON THE ANNEXED MAP AND MORE PARTICULARLY DESCRIBED IN THE ACCOMPANYING SURVEYORS CERTIFICATE, AND HAVE CAUSED THE SAME TO BE PARTITIONED AND PLATTED INTO PARCELS TOGETHER WITH EASEMENTS AS SHOWN ON THE ANNEXED MAP

Janet K. Swanson
 JANET K. SWANSON/ TRANSITION INC.

Allyn C. Ford
 ALLYN C. FORD/ ROSEBURG FOREST PRODUCTS, INC.

ACKNOWLEDGEMENT

STATE OF OREGON >
 COUNTY OF DOUGLAS > S.S.

THIS INSTRUMENT WAS ACKNOWLEDGED BEFORE ME ON January 13, 1997, BY JANET K. SWANSON/TRANSITION, INC.

Sylvia Schoonover
 NOTARY PUBLIC
 MY COMMISSION EXPIRES 4-6-2000
Sylvia Schoonover of Lane County, Or. 1/10/97
 MY COMMISSION EXPIRES 8-25-2000



STATE OF OREGON >
 COUNTY OF DOUGLAS > S.S.

THIS INSTRUMENT WAS ACKNOWLEDGED BEFORE ME ON January 8, 1997, BY ALLYN C. FORD/ROSEBURG FOREST PRODUCTS, INC.

B. Carol McLaughlin
 NOTARY PUBLIC
 MY COMMISSION EXPIRES 2/05/97



I HEREBY CERTIFY THAT THIS PARTITION PLAT WAS RECEIVED FOR RECORD ON THE 16th DAY OF January, 1997 AT 11:35 O'CLOCK AND RECORDED AS PARTITION PLAT NO. 1997-10 A B DOUGLAS COUNTY RECORDS, AS INSTRUMENT # 97-00914
Doyle Shaver Jr., County Clerk by Carol Lynch, Deputy
 DOUGLAS COUNTY CLERK.

STATE OF OREGON)
 COUNTY OF DOUGLAS)
 I, COUNTY CLERK AND RECORDS)
 CLERK, DO HEREBY CERTIFY THAT)
 INSTRUMENT WAS RECEIVED)
 97 JAN 16 AM 11:35)
 DOUGLAS COUNTY CLERK)
 IN THE OFFICE OF DOUGLAS COUNTY)
 CLERK)
Carol Lynch
 97-00914 PP

NOTE: ANY NEW STRUCTURAL DEVELOPMENT ON PARCELS #1, #2, OR #3 SHALL COMPLY WITH THE SETBACK REQUIRED BY THE RIPARIAN VEGETATION CORRIDOR OVERLAY, UNLESS A VARIANCE IS GRANTED BY THE OREGON DEPARTMENT OF FISH AND WILDLIFE.

APPROVALS

Ronan E. Wain 1/16/97
 DOUGLAS COUNTY SURVEYOR DATE
Bob Williamson 1/15/97
 DOUGLAS COUNTY PLANNING DIRECTOR DATE

TAX STATEMENT

I HEREBY CERTIFY THAT ALL TAXES AND SPECIAL ASSESSMENTS OR OTHER CHARGES REQUIRED BY LAW HAVE BEEN PAID IN FULL.
Vickey Sanferane 1-16-97
 DOUGLAS COUNTY TAX COLLECTOR DATE

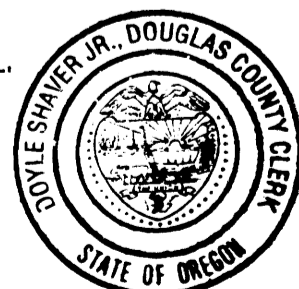

COMP PLAN: **TIMBERLANDS**
 FARM FOREST TRANSITIONAL
 AGRICULTURE
 ZONE: **TIMBERLAND RESOURCE**
 FARM FOREST
 FARM GRAZING
 WATER: **RESOURCE PARCELS**
 SEWER: **RESOURCE PARCELS**
 PLANNING DEPARTMENT FILE NO. 96-256

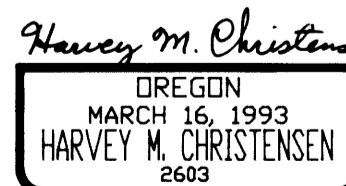
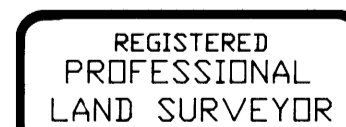

NORTHWEST TIMBERLAND CONSULTING, INC.
 4680 BRIARS ST. - EUGENE, OR 97404-1113
 PHONE OR FAX (541) 461-4076

1997 - 0010B

1997 - 0010B