

COUNTY SURVEYORS FILE DATA
DO NOT REMOVE FROM OFFICE

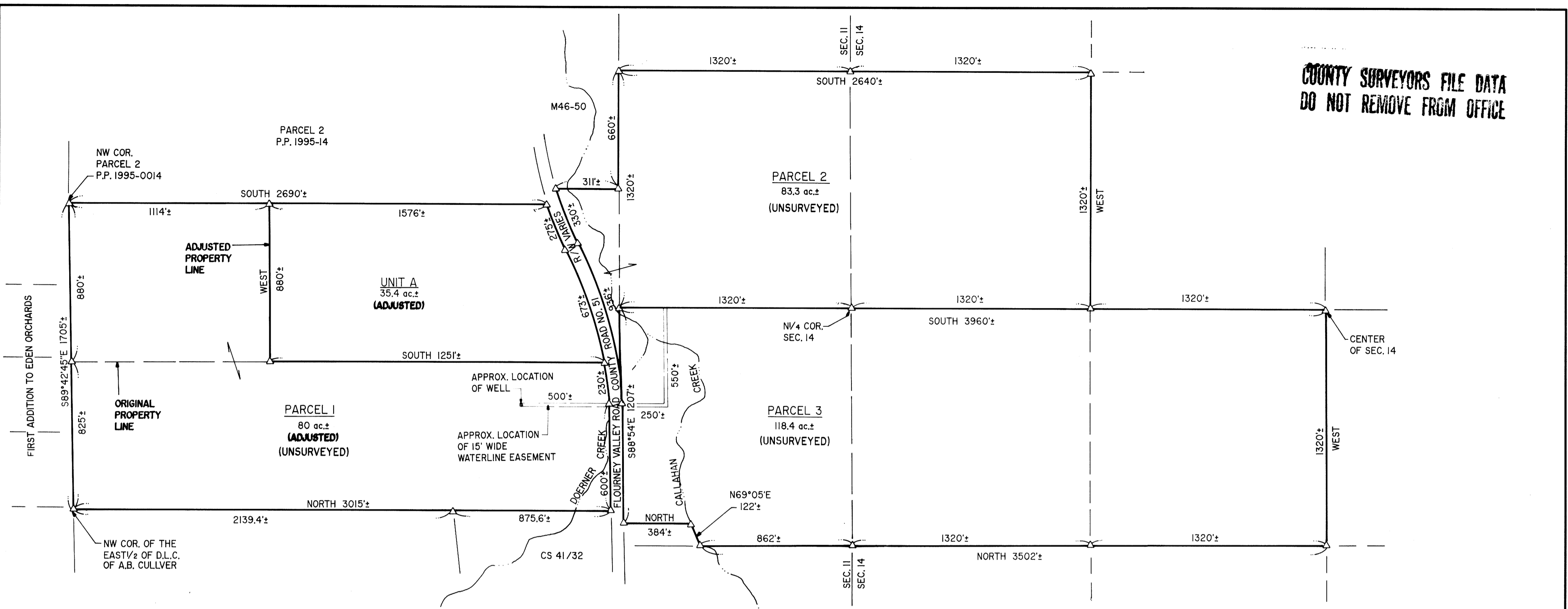

SURVEYOR'S CERTIFICATE:

I, DONALD A. BENTZ, BEING DULY SWORN, DEPOSE AND SAY THAT I HAVE NOT SURVEYED AND HAVE CORRECTLY PREPARED THE LAND PARTITION SHOWN ON THIS PLAT AND MAKE NO REPRESENTATION AS TO THE ACCURACY OF THE BOUNDARIES OF SAID PARTITION, OF WHICH THE FOLLOWING IS A TRUE AND CORRECT DESCRIPTION:

THOSE PROPERTIES DESCRIBED IN INSTRUMENT NO.'S 95-4125, 89-13738, 88-6008, AND 88-6026 AS RECORDED IN THE DEED RECORDS OF DOUGLAS COUNTY, OREGON.

[Signature]
DONALD A. BENTZ P.L.S. #835

NARRATIVE:

THE PURPOSE OF THIS PLAT IS TO ADJUST A PORTION OF THE EAST LINE OF INSTRUMENT NO. 95-4125 AND PARTITION THOSE PROPERTIES DESCRIBED IN INSTRUMENT NO.'S 95-4125, 89-13738, 88-6008, AND 88-6026 INTO THREE PARCELS AS SHOWN HEREON. CARDINAL BEARINGS WERE USED AS BASIS. A PHYSICAL SURVEY WAS NOT PERFORMED BECAUSE ALL PARCELS EXCEED THE 10 ACRE MINIMUM.

OFFICE: WENDELL T. HARNESS
DRAFTING: TIM ADAMS

APPROVALS:

Keith L. Cubic 12/23/96
DOUGLAS COUNTY PLANNING DIRECTOR DATE

Amy E. Monson 12-23-96
DOUGLAS COUNTY SURVEYOR DEPUTY DATE

I HEREBY CERTIFY THAT ALL TAXES AND SPECIAL ASSESSMENTS OR OTHER CHARGES REQUIRED BY LAW HAVE BEEN PAID.

Anne E. Schroeder 12-23-96
DOUGLAS COUNTY TAX COLLECTOR DATE

FILED THIS 26th DAY OF DECEMBER, 1996, 11:41 O'CLOCK AM

Donna L. Bennett 96-25964
DOUGLAS COUNTY CLERK BY: DEPUTY

STATE OF OREGON)
COUNTY OF DOUGLAS) SS.
I, _____, COUNTY CLERK AND RECORDER OF CONVEYANCES, DO HEREBY CERTIFY THAT THIS INSTRUMENT WAS RECORDED

96 DEC 26 AM 11:41

Donna L. Bennett JR.
DOUGLAS COUNTY CLERK

IN THE OFFICIAL RECORDS OF DOUGLAS COUNTY

BY *Donna L. Bennett*
DEPUTY

FEE PP

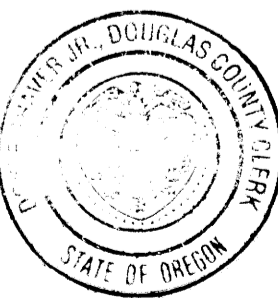

DECLARATION:

KNOW ALL PEOPLE BY THESE PRESENTS THAT RICHARD I. & BOBBYE CONN AND GREGORY SEHL CONN AND MICHAEL EDWARD CONN, ARE THE OWNERS OF THE LAND REPRESENTED HEREON AND MORE PARTICULARLY DESCRIBED HEREIN AND HAVE CAUSED THE SAME TO BE SURVEYED AND PLATTED INTO PARCELS TOGETHER WITH EASEMENTS AS SHOWN HEREON.

Richard I. Conn RICHARD I. CONN
Bobbye Conn BOBBYE CONN

GREGORY SEHL CONN
SEE PARTITION PLAT CONSENT AFFIDAVIT AS RECORDED IN VOL. 1447, PAGE 891 (INSTRUMENT NO. 96-25962)

MICHAEL EDWARD CONN
SEE PARTITION PLAT CONSENT AFFIDAVIT AS RECORDED IN VOL. 1447, PAGE 892 (INSTRUMENT NO. 96-25963)

ACKNOWLEDGEMENT:
STATE OF OREGON
COUNTY OF DOUGLAS

KNOW ALL PEOPLE BY THESE PRESENTS, ON THIS 12th DAY OF DECEMBER, 1996, BEFORE ME, A NOTARY PUBLIC IN AND FOR SAID STATE AND COUNTY, PERSONALLY APPEARED RICHARD I. & BOBBYE CONN, WHO DID SAY THAT THEY ARE THE IDENTICAL PEOPLE NAMED IN THE FOREGOING INSTRUMENT AND THAT THEY EXECUTED SAID INSTRUMENT FREELY AND VOLUNTARILY.

Wendell T. Harness
MY COMMISSION EXPIRES: 1-16-99

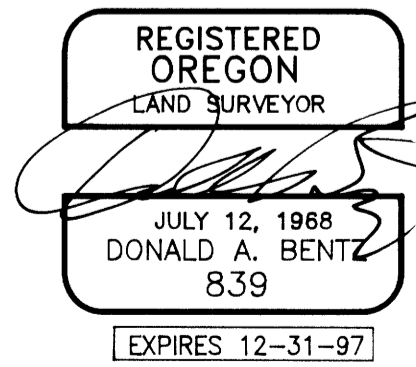

LAND PARTITION & BOUNDARY LINE ADJUSTMENT

IN THE NW1/4, NE1/4, SE1/4, & SW1/4 OF SEC. II AND THE NW1/4 & NE1/4 OF SEC. 14, T27S, R7W, W.M., DOUGLAS COUNTY, OREGON

SURVEYED FOR:
RICHARD CONN
885 FLOURNEY VALLEY ROAD
ROSEBURG, OREGON 97470

SURVEYED BY:
548 S.E. Jackson Suite 3
Roseburg, Oregon 97470
PHONE (541) 873-0166
FAX (541) 440-9392

