

FINAL PARTITION PLAT
 IN NE 1/4 AND NW 1/4 OF SECTION 29, T24S, R3W, W.M.
 DOUGLAS COUNTY, OREGON
 NOVEMBER 21, 1994

COUNTY SURVEYORS FILE DATA
 DO NOT REMOVE FROM OFFICE

① SECTION CORNER 19, 20, 29, 30

FOUND: GLO BRASS CAP DATED 1950
 44" CEDAR, N 80 W, 118.1 FT.
 RECORD: N 80 W, 179 LKS. - 1928 DOUGLAS CO.
 ROTTEN STUMP, S 15 E, 106.3 FT., VISIBLE SCRIBING
 RECORD: S 15 E, 161 LKS. - 1928 DOUGLAS CO.
 ROTTEN STUMP, S 37 W, 108.2 FT., VISIBLE SCRIBING
 RECORD: S 37 W, 164 LKS. - 1928 DOUGLAS CO.
 16" FIR, N 48 E, 8.8 FT., CLOSED FACE
 RECORD: N 45-1/2 E, 13 LKS, 1950 GLO
 15" FIR, S 47 E, 28.9 FT., CLOSED FACE
 RECORD: S 52 E, 44 LKS, 1950 GLO
 SET: 11" FIR, S 18 W, 13.4 FT. TO "W" NAIL
 SCRIBED " T 24 S R 3 W S 30 BT "
 23" FIR, N 62 W, 10.1 FT. TO "W" NAIL
 SCRIBED " T 24 S R 3 W S 19 BT "

② WEST 1/16 CORNER 20, 29

FOUND - 1-1/4" X 36" IRON PIPE WITH BRASS CAP DATED 1994
 17" FIR, N 29 E, 27.0 FT., SCRIBED " W1/16 S20 BT "
 11" FIR, S 44 E, 31.5 FT., SCRIBED " W1/16 S29 BT "
 6' FENCEPOST 1' SOUTH

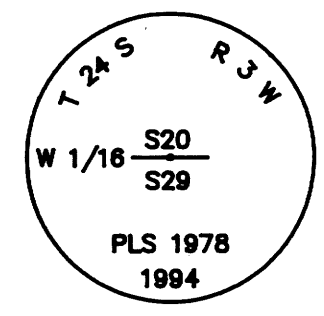

③ 1/4 CORNER 20, 29

FOUND: G.L.O. BRASS CAP DATED 1950
 24" FIR, N 49 E, 92.4 FT., VISIBLE SCRIBING
 RECORD: N 49 E, 92.4 FT. - 1991 DOUGLAS CO.
 5" ASH, S 63 E, 7.8 FT., VISIBLE SCRIBING
 RECORD: S 63-1/2 E, 7.8 FT. - 1991 DOUGLAS CO.
 13" FIR, N 80 W, 55.9 FT., VISIBLE SCRIBING
 RECORD: N 80-1/2 W, 55.8 FT. - 1991 DOUGLAS CO.

④ SECTION CORNER 20, 21, 28, 29

FOUND: 5" YEW POST
 G.L.O. BRASS CAP DATED 1950
 32" CEDAR STUMP, S 55 E, 28.4 FT. TO "W" NAIL
 RECORD: S 54 E, 46 LKS - 1928 DOUGLAS CO.
 27" FIR STUMP, S 15 W, 36.3 FT. TO "W" NAIL
 RECORD: S 13'45" W, 36.3 FT. - 1950 GLO
 50" FIR STUMP, N 82-1/2 W, 46.4 FT.
 RECORD: N 81'45" W, 44.2 FT. - 1950 GLO
 11" DEAD YEW, N 42 W 16.9 FT. TO "W" NAIL
 RECORD: N 44 W, 26 LKS - 1928 DOUGLAS CO.
 SET: 6" FIR, S 62 E, 11.9 FT. TO "W" NAIL
 SCRIBED " T 24 S R 3 W S 28 BT "
 12" FIR, N 56 E, 15.6 FT. TO "W" NAIL
 SCRIBED " T 24 S R 3 W S 21 BT "
 10" FIR, S 35 W, 26.0 FT. TO "W" NAIL
 SCRIBED " T 24 S R 3 W S 29 BT "
 7" FIR, N 60 W, 5.9 FT. TO "W" NAIL
 SCRIBED " T 24 S R 3 W S 20 BT "

REGISTERED
 PROFESSIONAL
 LAND SURVEYOR

 OREGON
 JULY 16, 1982
 DANIEL W. BAKER
 1978
 EXPIRES 12/31/95

⑤ 1/4 CORNER 28, 29

FOUND - 1-1/4" X 36" IRON PIPE WITH 2-1/2" BRASS CAP
 DATED 1994.
 12" FIR, N 80 W, 11.3 FT., SCRIBED " 1/4 S29 BT "
 15" FIR, N 30 E, 18.7 FT., SCRIBED " 1/4 S29 BT "
 14" FIR, S 82 E, 11.0 FT., SCRIBED " 1/4 S28 BT "
 10" FIR, S 32 W, 13.5 FT., SCRIBED " 1/4 S29 BT "
 6' CARSONITE POST 1' NORTH

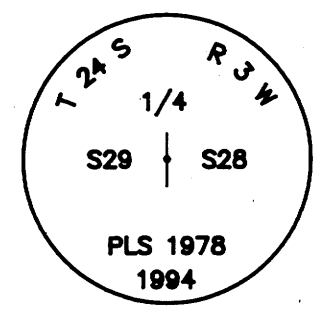

⑥ SECTION CORNER 28, 29, 32, 33

FOUND: DOUGLAS COUNTY BRASS CAP DATED 1956

⑦ 1/4 CORNER 29, 32

FOUND: DOUGLAS COUNTY BRASS CAP DATED 1956
 39" ROTTEN STUMP, S 16 W, 47.0 FT., VISIBLE SCRIBING
 RECORD: S 16 W, 47.0 FT., 1956 DOUG. CO.
 SET: 14" FIR, N 53 E, 23.1 FT. - SCRIBED " 1/4 S 29 BT "
 7" FIR, S 63 E, 4.4 FT. - SCRIBED " 1/4 S 32 BT "
 12" FIR, S 31 W, 8.0 FT. - SCRIBED " 1/4 S 32 BT "
 9" FIR, N 13 W, 27.1 FT. - SCRIBED " 1/4 S 29 BT "

⑧ SECTION CORNER 29, 30, 31, 32

FOUND: DOUGLAS COUNTY BRASS CAP DATED 1956

⑨ 1/4 CORNER 29, 30

FOUND - 1-1/4" X 36" IRON PIPE WITH BRASS CAP DATED 1994
 13" FIR, S 4 E, 28.9 FT., SCRIBED " 1/4 S29 BT "
 12" FIR, S 76 W, 14.6 FT., SCRIBED " 1/4 S30 BT "
 9" FIR, N 78 E, 2.8 FT., SCRIBED " 1/4 S29 BT "
 16" FIR, N 26 W, 8.0 FT., SCRIBED " 1/4 S30 BT "
 6' CARSONITE POST 1' NORTH

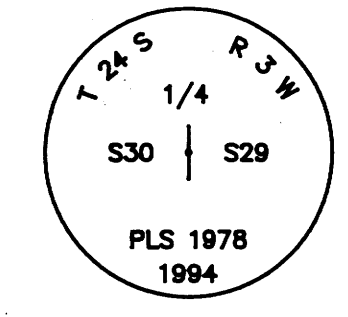

⑩ CW 1/16 CORNER

FOUND - 1-1/4" X 36" IRON PIPE WITH BRASS CAP DATED 1994
 10" FIR, S 17 E, 17.4 FT., SCRIBED " CW1/16 S29 BT "
 12" FIR, N 87 W, 22.5 FT., SCRIBED " CW1/16 S29 BT "

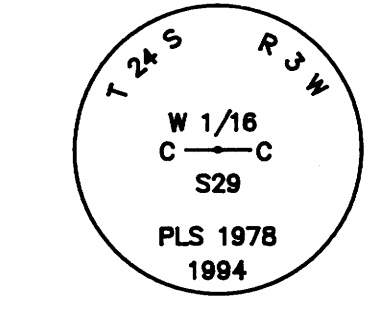

⑪ CENTER 1/4 CORNER 29

FOUND - 1-1/4" X 36" IRON PIPE WITH BRASS CAP DATED 1994
 28" CEDAR, N 42 E, 25.0 FT., SCRIBED " C1/4 S29 BT "
 11" MAPLE, S 30 E, 14.4 FT., SCRIBED " C1/4 S29 BT "
 20" CEDAR, S 8 W, 24.0 FT., SCRIBED " C1/4 S29 BT "
 8" MAPLE, N 50 W, 5.8 FT., SCRIBED " C1/4 S29 BT "
 6' FENCEPOST 1' NORTH
 NOTE: 1-1/2" IRON PIPE SET BY A.R. EVANS IN CSF# 41/100
 AS PER C.E. ROBERTS SURVEY F.B.# 7, PAGE 7
 NOTED IN CSF# 41/293 AND CSF# M1-18 AS MIDPOINT OF
 NORTH - SOUTH CENTERLINE BEARS S 17'50'43" W, 146.23 FT.
 27" CEDAR, S 62 E, 32.3 FT.
 RECORD: S 65 E, 33.5 FT. - EVANS 1952
 31" CEDAR, N 52 E, 28.0 FT.
 RECORD: N 53 E, 28.6 FT. - EVANS 1952

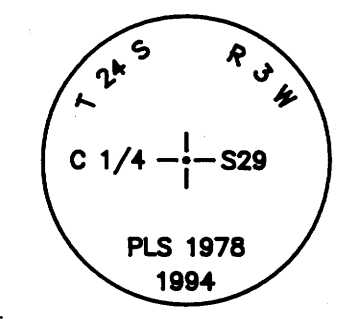

⑫ NW 1/16 CORNER

FOUND - 1-1/4" X 36" IRON PIPE WITH BRASS CAP DATED 1994
 10" FIR, S 86 E, 6.6 FT., SCRIBED " NW1/16 S29 BT "
 11" FIR, N 46 W, 3.6 FT., SCRIBED " NW1/16 S29 BT "
 6' FENCEPOST 1' SOUTH

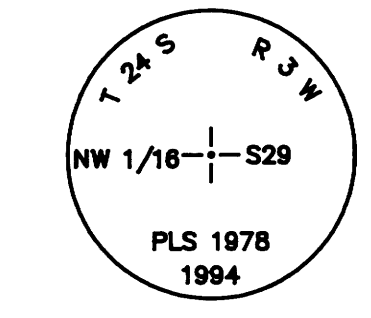

FINAL PARTITION SURVEY IN NW 1/4 AND NE 1/4 OF SECTION 29, T24S, R3W, W.M. DOUGLAS COUNTY, OREGON	
CLIENT:	E. LYLE AND DON BLOOM
DRAWN BY: KRC	BAKER AND ASSOCIATES, SURVEYORS
DATE: 11/21/94	1385 OAK STREET-SUITE 3 EUGENE, OREGON
FILE: \BA\BLOOM	(503) 343-7243

95-07970

1995 - 0036 B

1995 - 0036 B