

COUNTY SURVEYOR'S RECORD, DOUGLAS COUNTY, OREGON

REYNOLDS & CO. PORTLAND, ORE. 87545

Survey No.	Made on August, 1934	Survey No.	Made on
In Town. 279	Range 5 & 6 W Sec. 6 Miles	In Town.	Range Sec.
Made for County		Made for	
Purpose of to establish corners on Range line		Purpose of ^{1/25/61} - Use DATA FROM THIS SURVEY ONLY	
5 & 6 and donation claim corners along this line.		AFTER CAREFUL CONSIDERATION	
		CAUTION	L.L.

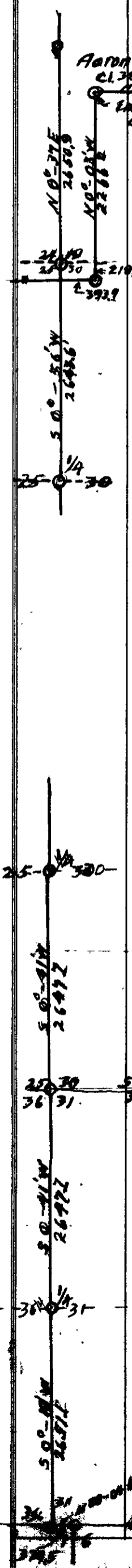

The purpose of survey was to re-establish the corners in T 27 S - R 5 & 6 W WM. by setting up a S.E.R.A Project.

The persons on survey were, transit, Ben B. Irvine; James H. Wolford; Claude W. Crocker, Chairman; Bert A. Lane, P. D. Wolford N.E. Richardson & Robert Irving, Blazmen & Axmen; W. B. Nixon H. M. Hogan, A. Bowden & Earnest Brown, with H. L. Apostein in charge of Project.

The project was carried on for a short time then the S. E. M. A. office cut it out, not allowing any more funds.

The survey was all made with transit, with all angles doubled, 300' sh., slope measurement. Bearings all true, taken from sun observations & the meridian at Douglas county court House tied in along with the latitude station on Mt. Nebo & the triangulation station Rose (North of Roseburg) to Park (South of Roseburg.)

The survey was started at a known corner of Sec. 19 & 30 T. 27 S. - R. 5 W. & Section 24 & 25 T 27 S P R 6 W. with one crew running North and the other crew running south.

In writing up survey I will take the crew running north under B. B. Irvine. This crew started running north and only found the meander Cor. witness trees on the right bank of the south Umpqua river on range line of section 19 T 27 S - R 5 W, which trees were not cut out as they were in the yard of an owner's place & did not show enough evidence of being the trees but were found to check when the line was finally located and the Twp. cor. common to Sec. 31-6-1 & 36 T 26 S - R 5 W & T 27 S - R 6 W, which was definitely located from old S.E.

Thence beginning at the corner common to section 19, 30 24 & 25 on the range line between range line between Range 5 & 6 this Cor. set from old bearing tree in Section 30 T. 27 S R. 5 W and at from which street monument at intersection of Main & Roberts streets bears N 5 - 25 230.7 feet then line runs N 8 - 37 E 2650.9 ft. to the cor. between Sections 19 & 24.

